

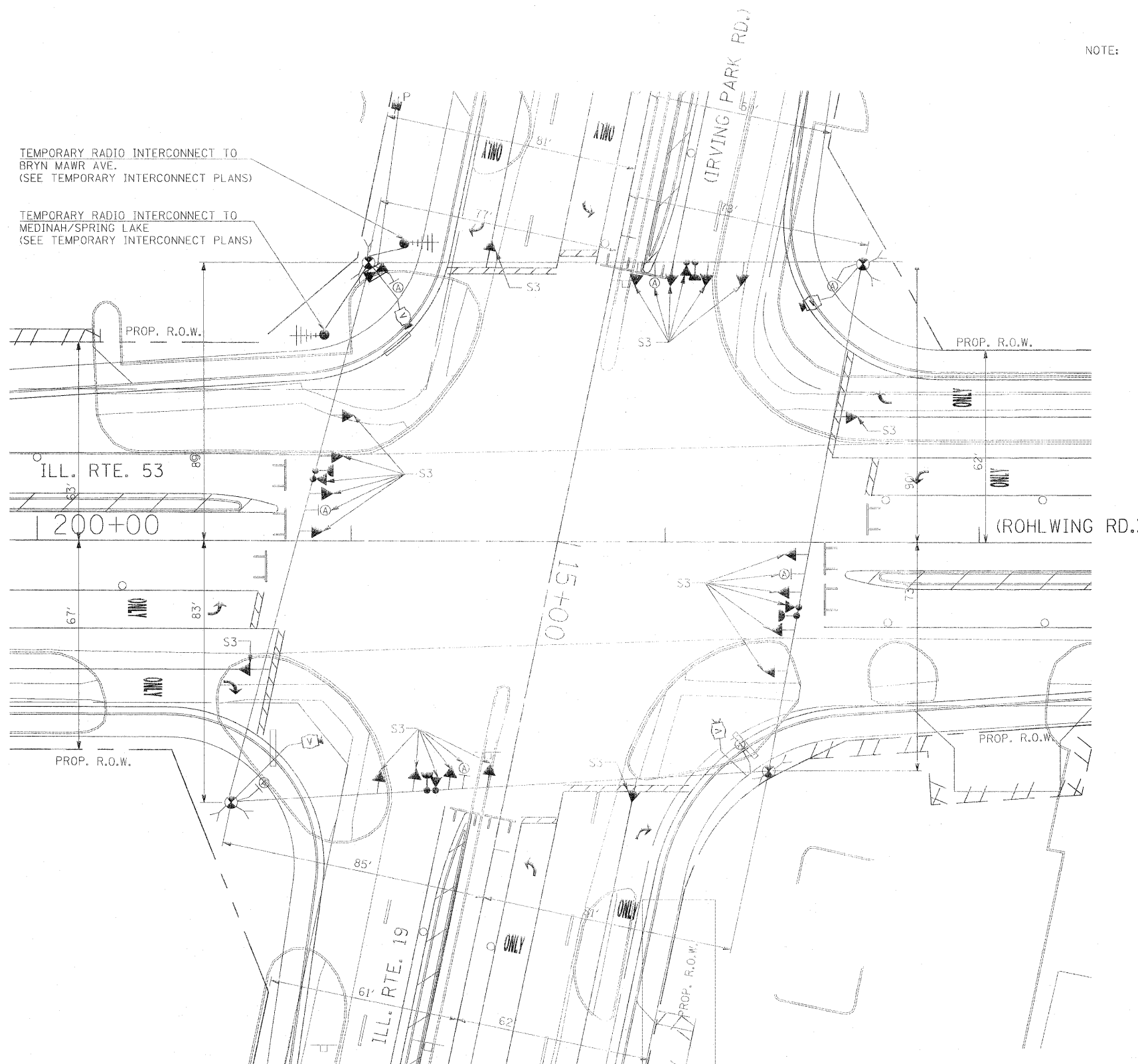

NOTE: THE VIDEO DETECTION ZONES SHOWN ON THE PLANS ARE FOR CONSTRUCTION STAGE 1 - SUBSTAGE 1 AND SHALL BE REDEFINED FOR EACH CONSTRUCTION STAGE AS A PART OF "TEMPORARY TRAFFIC SIGNAL INSTALLATION" WORK.



SIGNAL HEAD PLACEMENTS FOR STAGE 3

Ⓐ  
 LEFT ON  
 GREEN  
 ARROW  
 ONLY  
 R10-5, 24" X 30" (8 REQUIRED)  
 R10-5 SIGNS SHALL BE MOUNTED, ONE EACH ON SPAN WIRE AND FAR LEFT POLE FOR ALL APPROACHES OF THE INTERSECTION

THE TRAFFIC SIGNAL CONTROL EQUIPMENT FOR THIS PROJECT SHALL BE "ECONOLITE" TO MATCH THE EXISTING ADJACENT SYSTEM.

Rev. 6-8-11

FILE NAME = *FILEL*	USER NAME = *USER*	DESIGNED - PKG	REVISED -	<b>STATE OF ILLINOIS DEPARTMENT OF TRANSPORTATION</b>	<b>TEMPORARY TRAFFIC SIGNAL INSTALLATION AND REMOVAL PLAN ILLINOIS ROUTE 53 (ROHLWING RD.) AT ILL. RTE. 19 (IRVING PARK RD.) STAGE 3 (SHEET 4 OF 5)</b>			F.A.P. RTE. 2578	SECTION 532B	COUNTY DuPage	TOTAL SHEETS 781	SHEET NO. 480
	PLOT SCALE = *SCALE*	DRAWN - MAA, EA	REVISED -		SCALE:	SHEET NO.	OF	SHEETS	STA.	TO STA.	CONTRACT NO. 60477	
	PLOT DATE = *DATE*	CHECKED - PKG, EA	REVISED -								ILLINOIS FED. AID PROJECT	
		DATE - 5/18/2011	REVISED -									