

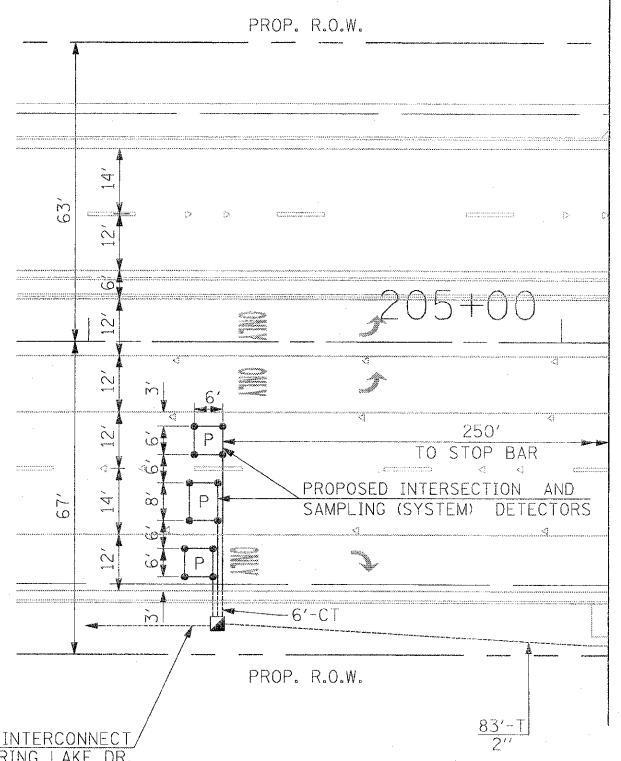

ILL. RTE. 53 (ROHLWING RD.)



MATCH LINE 199+10

PROPOSED INTERCONNECT TO MEDINAH DR./SPRING LAKE DR. 83'-T 2"

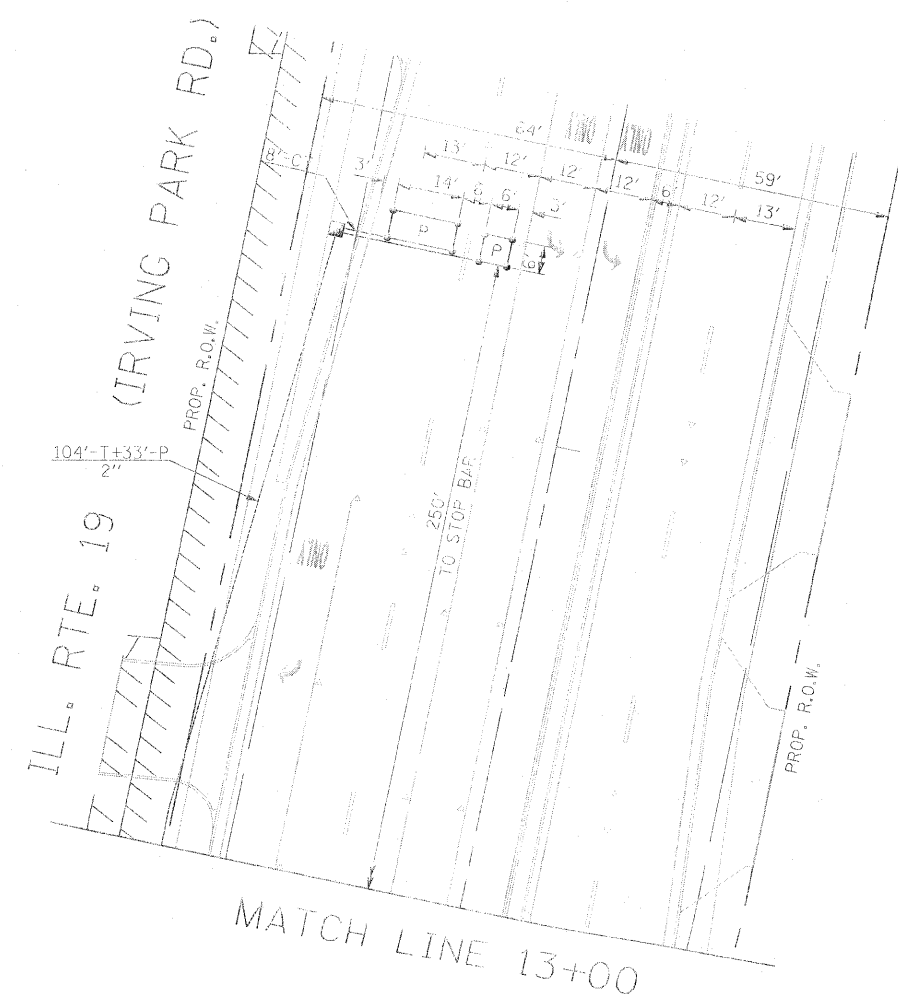

MATCH LINE 13+00

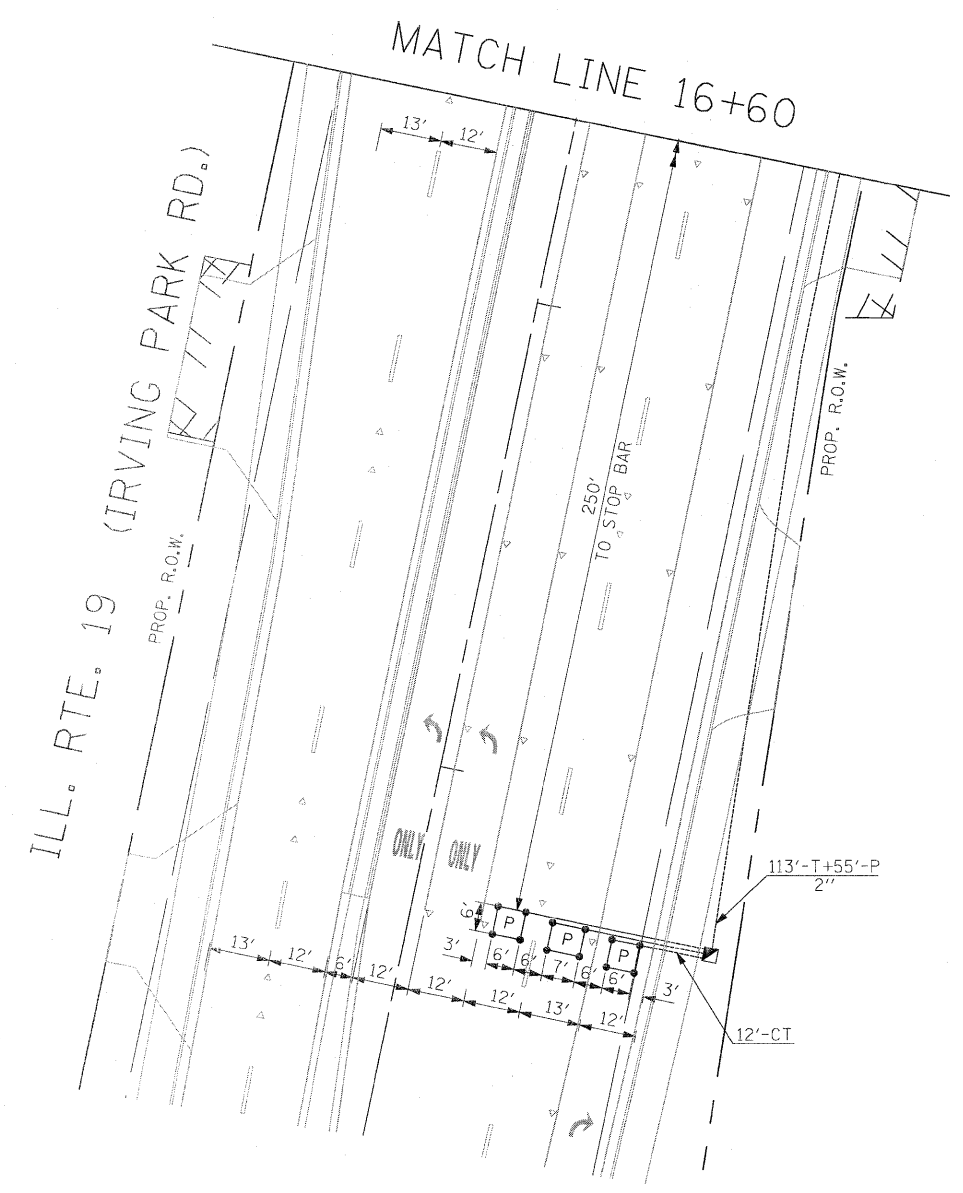

MATCH LINE 16+60

THE TRAFFIC SIGNAL CONTROL EQUIPMENT FOR THIS PROJECT SHALL BE "ECONOLITE" TO MATCH THE EXISTING ADJACENT SYSTEM.

Rev. 6-8-11

FILE NAME = #FILE#	USER NAME = #USER#	DESIGNED - PKG	REVISED -	STATE OF ILLINOIS DEPARTMENT OF TRANSPORTATION	TRAFFIC SIGNAL INSTALLATION PLAN ILLINOIS ROUTE 53 (ROHLWING RD.) AT ILL. RTE. 19 (IRVING PARK RD.) (SHEET 2 OF 2)			F.A.P. RTE. 2578	SECTION 532B	COUNTY DuPage	TOTAL SHEETS 781	SHEET NO. 485
	PLOT SCALE = #SCALE#	DRAWN - MAA, EA	REVISED -		SCALE: 1"=20'	SHEET NO. OF SHEETS	STA. TO STA.	FED. ROAD DIST. NO. ILLINOIS FED. AID PROJECT		CONTRACT NO. 60477		
PLOT DATE = #DATE#	DATE - 5/18/2011	CHECKED - PKG, EA	REVISED -									