

SIGNAL HEAD PLACEMENTS FOR STAGES: S2-1, S2-2, AND S2-3.

TEMPORARY RADIO INTERCONNECT TO IRVING PARK RD. (SEE TEMPORARY INTERCONNECT PLANS)

TEMPORARY RADIO INTERCONNECT TO ARDMORE AVE. (SEE TEMPORARY INTERCONNECT PLANS)

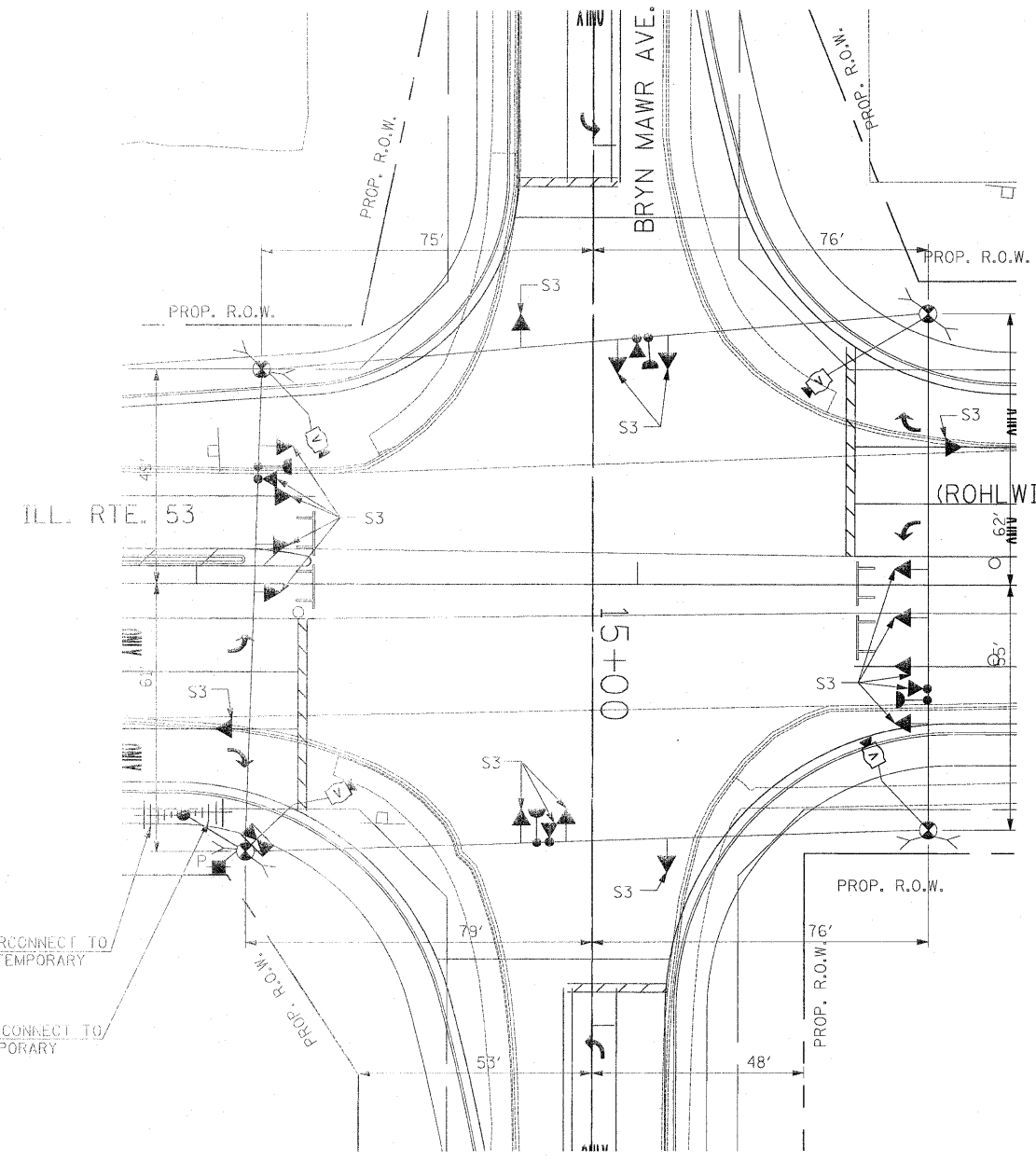

SIGNAL HEAD PLACEMENTS FOR STAGE S3

TEMPORARY RADIO INTERCONNECT TO IRVING PARK RD. (SEE TEMPORARY INTERCONNECT PLANS)

TEMPORARY RADIO INTERCONNECT TO ARDMORE AVE. (SEE TEMPORARY INTERCONNECT PLANS)

NOTE: THE VIDEO DETECTION ZONES SHOWN ON THE PLANS ARE FOR CONSTRUCTION STAGE 1 - SUBSTAGE 1 AND SHALL BE REDEFINED FOR EACH CONSTRUCTION STAGE AS A PART OF "TEMPORARY TRAFFIC SIGNAL INSTALLATION" WORK.

THE TRAFFIC SIGNAL CONTROL EQUIPMENT FOR THIS PROJECT SHALL BE "ECONOLITE" TO MATCH THE EXISTING ADJACENT SYSTEM.

FILE NAME = #FILEL#	USER NAME = #USER#	DESIGNED - PKG	REVISED -	STATE OF ILLINOIS DEPARTMENT OF TRANSPORTATION	TEMPORARY TRAFFIC SIGNAL INSTALLATION AND REMOVAL PLAN ILLINOIS ROUTE 53 (ROHLWING RD.) AT BRYN MAWR AVE. STAGE 2 AND STAGE 3 (SHEET 3 OF 4).	F.A.P. RTE. 2578	SECTION 532B	COUNTY DuPage	TOTAL SHEETS 781	SHEET NO. 490	
PLOT SCALE = #SCALE#	CHECKED - PKG, EA	REVISID -	SCALE: 1"=20'			SHEET NO. OF SHEETS	STA. TO STA.	FED. ROAD DIST. NO. - ILLINOIS FED. AID PROJECT	CONTRACT NO. 60477		
PLOT DATE = #DATE#	DATE - 5/18/2011	REVISID -	Rev 6-8-11								