

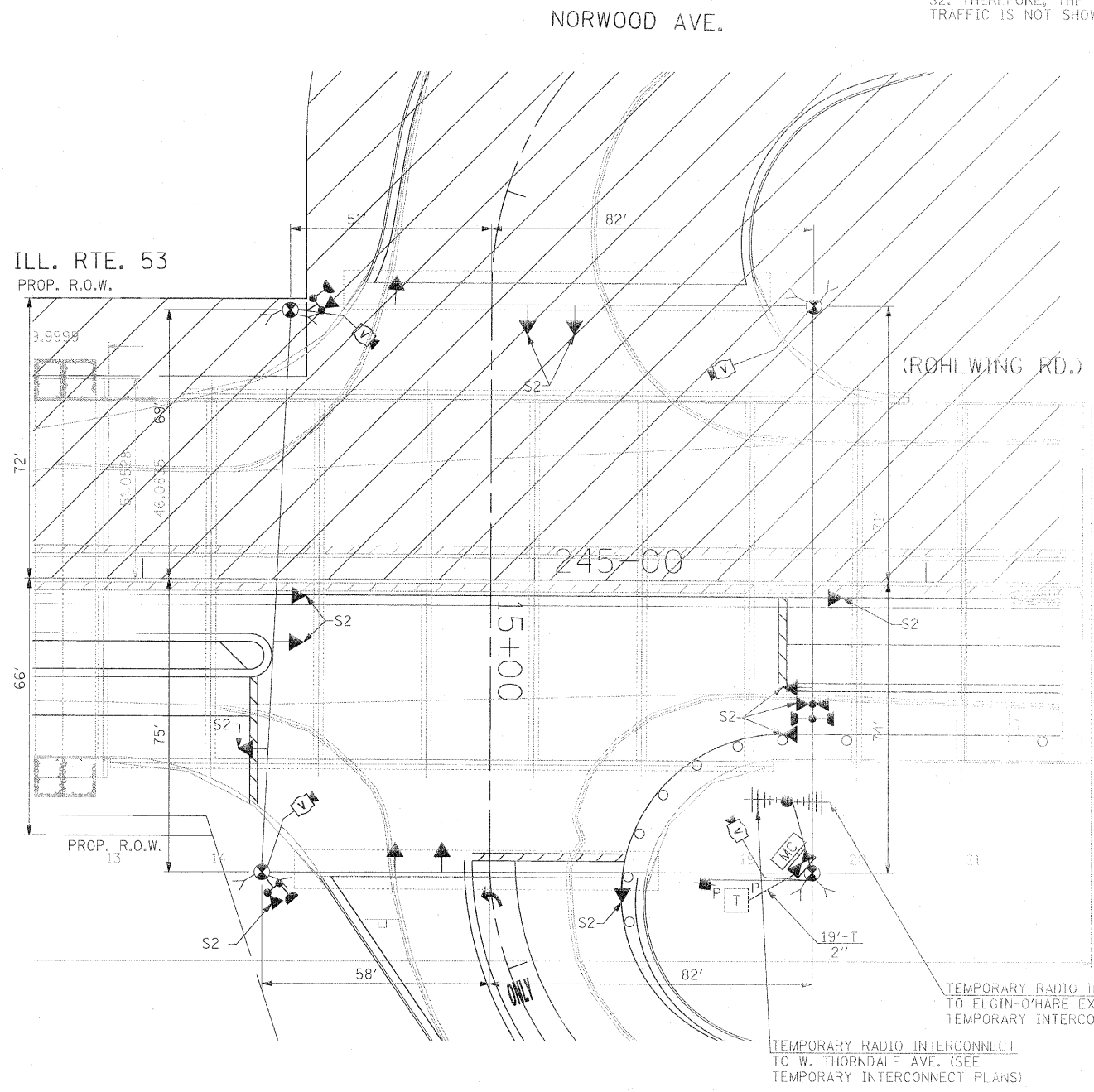

- NOTE 1: THE VIDEO DETECTION ZONES SHOWN ON THE PLANS ARE FOR CONSTRUCTION PRESTAGE - SUBSTAGE 1 AND SHALL BE REDEFINED FOR EACH CONSTRUCTION STAGE AS A PART OF "TEMPORARY TRAFFIC SIGNAL INSTALLATION" WORK.
- NOTE 2: THE SIGNAL HEAD PLACEMENT FOR NORWOOD AVENUE FOR CONSTRUCTION STAGES S2 AND S3 SHALL BE DETERMINED IN FIELD BY THE CONTRACTOR DEPENDING ON THE CONSTRUCTION STAGING USED BY THE CONTRACTOR FOR NORWOOD AVENUE.
- NOTE 3: THE WEST LEG IS CLOSED TO TRAFFIC DURING CONSTRUCTION STAGE S2. THEREFORE, THE SIGNAL HEADS PLACEMENT FOR EASTBOUND TRAFFIC IS NOT SHOWN FOR STAGE 2.

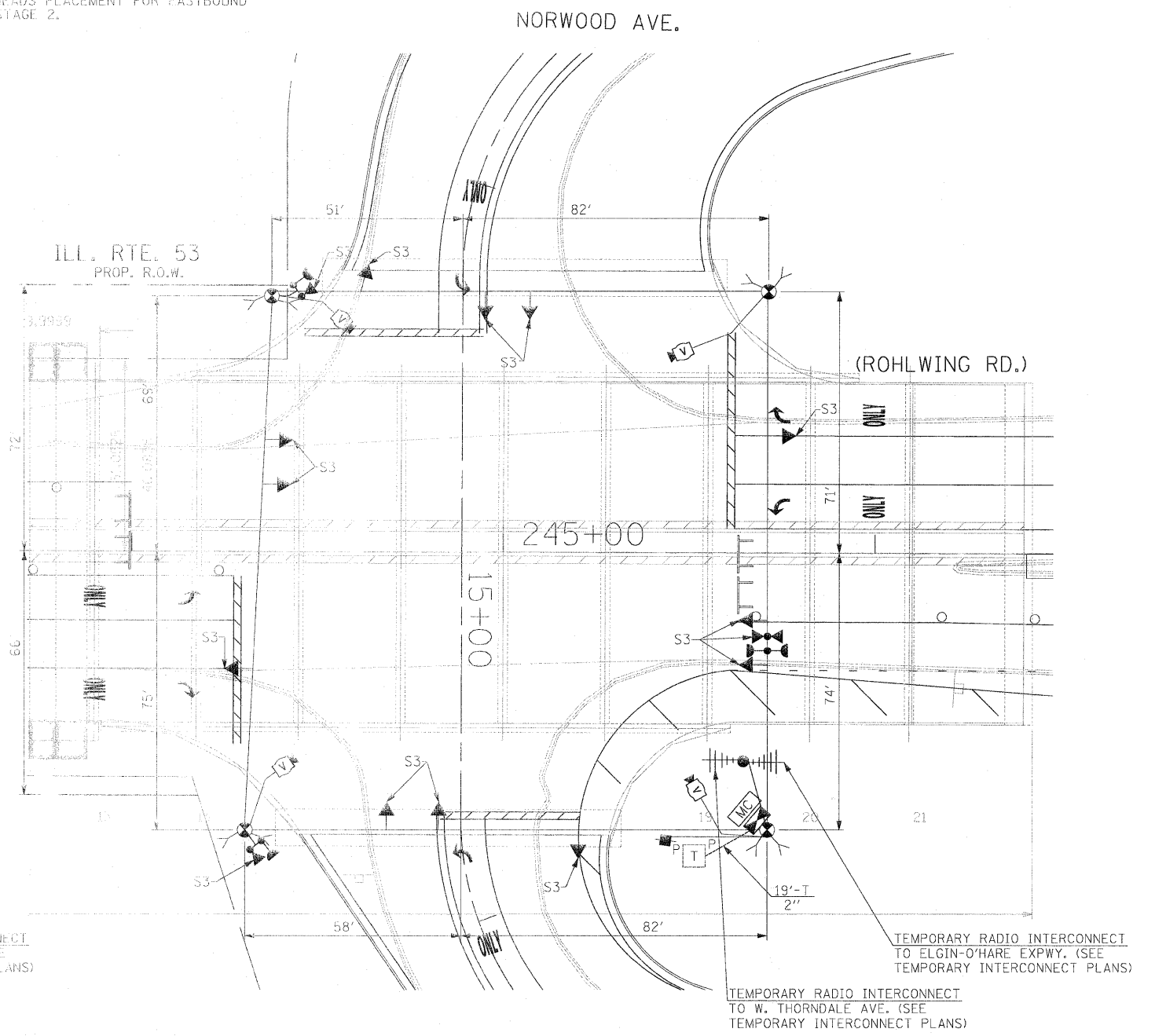

SIGNAL HEAD PLACEMENTS FOR STAGE S2



SIGNAL HEAD PLACEMENTS FOR STAGE S3

THE TRAFFIC SIGNAL CONTROL EQUIPMENT FOR THIS PROJECT SHALL BE "ECONOLITE" TO MATCH THE EXISTING ADJACENT SYSTEM.

FILE NAME = #FILEL#	USER NAME = #USER#	DESIGNED - PKG	REVISED -	<b>STATE OF ILLINOIS DEPARTMENT OF TRANSPORTATION</b>	<b>TEMPORARY TRAFFIC SIGNAL INSTALLATION AND REMOVAL PLAN ILLINOIS ROUTE 53 (ROHLWING RD.) AT NORWOOD AVE. STAGE 2 AND STAGE 3 (SHEET 3 OF 4).</b>		F.A.P. RTE. 2578	SECTION 532B	COUNTY DuPage	TOTAL SHEETS 781	SHEET NO. 508	
	PLOT SCALE = #SCALE#	DRAWN - MAA, EA	REVISED -		SCALE: 1"=20'	SHEET NO. OF SHEETS	STA. TO STA.	CONTRACT NO. 60477				
	PLOT DATE = #DATE#	CHECKED - PKG, EA	REVISED -					FED. ROAD DIST. NO. - [ILLINOIS] FED. AID PROJECT				
		DATE - 5/18/2011	REVISED -					Rev. 6-8-11				