

MATCH LINE STA. 162+00

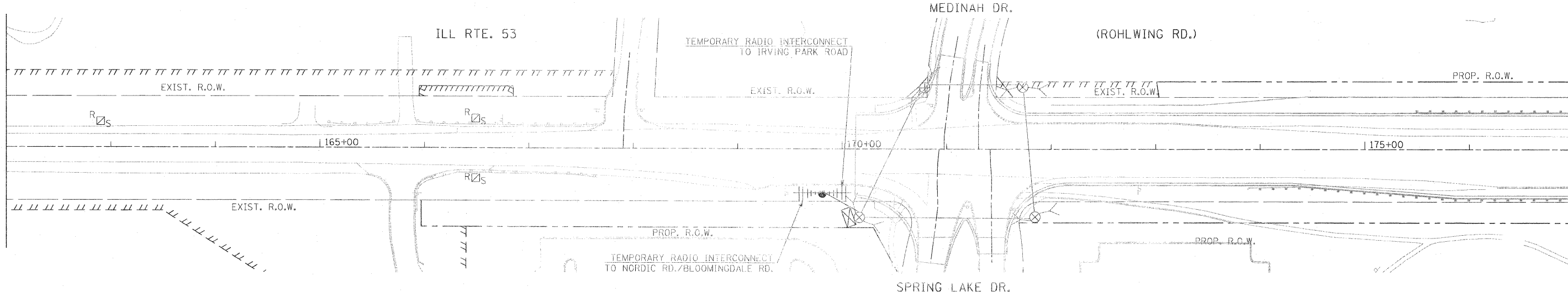

MATCH LINE STA. 162+00

MATCH LINE STA. 177+00

THE TRAFFIC SIGNAL CONTROL EQUIPMENT FOR THIS PROJECT SHALL BE "ECONOLITE" TO MATCH THE EXISTING ADJACENT SYSTEM.

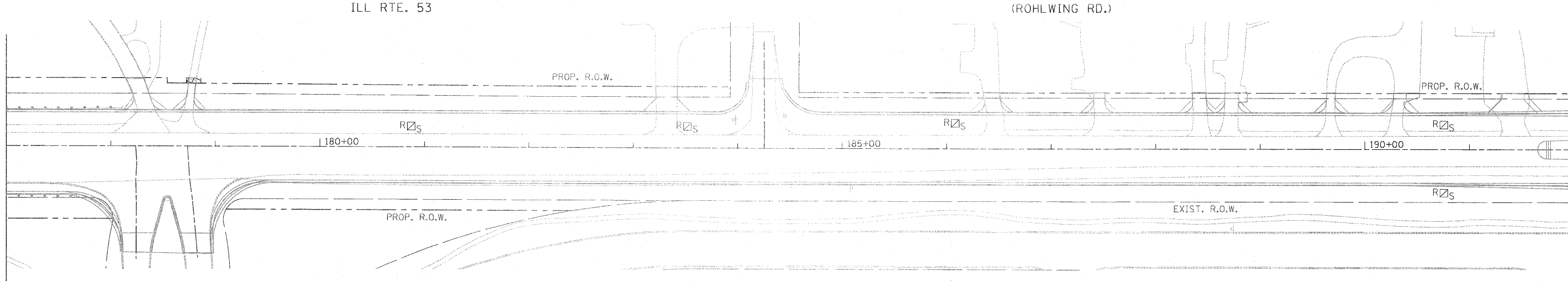

MATCH LINE STA. 177+00

MATCH LINE STA. 192+00

FILE NAME = #FILE#	USER NAME = #USER#	DESIGNED - PKG	REVISED -	STATE OF ILLINOIS DEPARTMENT OF TRANSPORTATION	TEMPORARY INTERCONNECT PLAN ILL. RTE. 53 (ROHLWING RD.) FROM NORDIC ROAD TO THORNDALE AVE. (SHEET 1 OF 3)			F.A.P. RTE. 2578	SECTION 532B	COUNTY DuPage	TOTAL SHEETS 781	SHEET NO. 532
	PLOT SCALE = #SCALE#	CHECKED - PKG, EA	REVISED -		SCALE: 1"=50'	SHEET NO. OF SHEETS	STA. TO STA.	FED. ROAD DIST. NO.	ILLINOIS FED. AID PROJECT	CONTRACT NO. 60477		
PLOT DATE = #DATE#	DATE - 5/18/2011	REVISED -										

Rev. 6-8-11