

NOTES:

1. THE CONTRACTOR SHALL REMOVE AND SAFELY STORE (FREE FROM THEFT OR DAMAGE) OR COVER ALL CONFLICTING EXISTING SIGNS.

LEGEND

- CONSTRUCTION ZONE
- TRAFFIC MOVEMENT
- SIGN
- ARROW BOARD
- TYPE II BARRICADES OR DRUMS WITH MONO-DIRECTIONAL STEADY BURNING LIGHT
- TYPE III BARRICADE WITH MONO-DIRECTIONAL STEADY BURNING LIGHTS
- BARRICADE OR DRUM

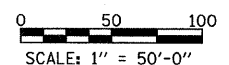
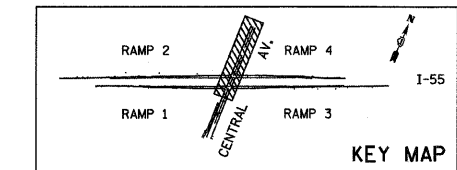
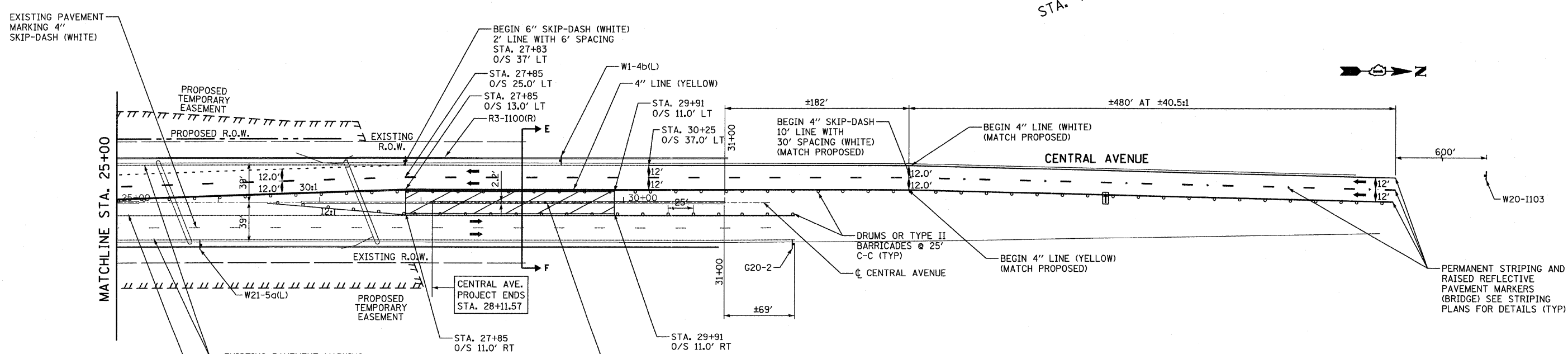
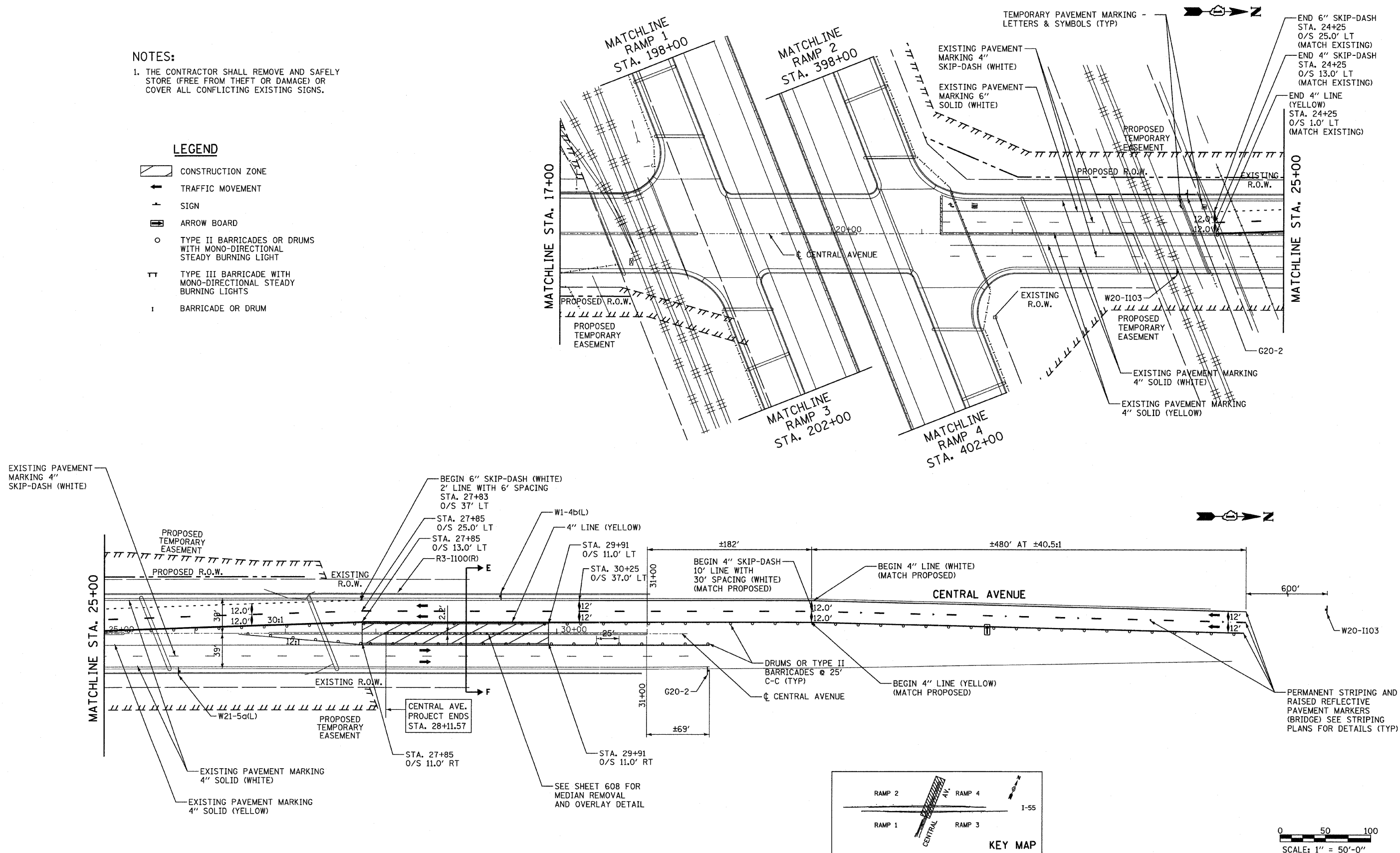

TYLIN INTERNATIONAL USER NAME = #USER# PLOT SCALE = #SCALE# PLOT DATE = 4/28/2011	DESIGNED - RLB	REVISED -	STATE OF ILLINOIS DEPARTMENT OF TRANSPORTATION	CENTRAL AVENUE OVER I-55 MAINTENANCE OF TRAFFIC - PRE-STAGE - CENTRAL AVENUE		F.A.I. RTE. I-55	SECTION 0711.2R & 1011.1BR	COUNTY COOK	TOTAL SHEETS 741	SHEET NO. 34	
	DRAWN - RLB	REVISED -		SCALE: 1:50	SHEET NO. 1 OF 1 SHEETS	STA. 17+00 TO STA.	FED. ROAD DIST. NO.	ILLINOIS FED. AID PROJECT	CONTRACT NO. 60999		
	CHECKED - JDF	REVISED -									
	DATE - 03/25/2011	REVISED -									