

P:\01345\ROAD\55\pish02elo.dgn 4/28/2011 12:40:22 PM

NOTES:

1. SEE EXISTING LIGHTING PLAN FOR REMOVAL OF EXISTING LIGHTING UNITS.
2. REMOVE SIGN PANEL ASSEMBLY, TYPE A OR TYPE B INCLUDES THE REMOVAL OF THE EXISTING SIGN PANELS.
3. CONCRETE BARRIER REMOVAL SHALL INCLUDE ANY ATTACHED APPURTENANCES AND BARRIER BASE.

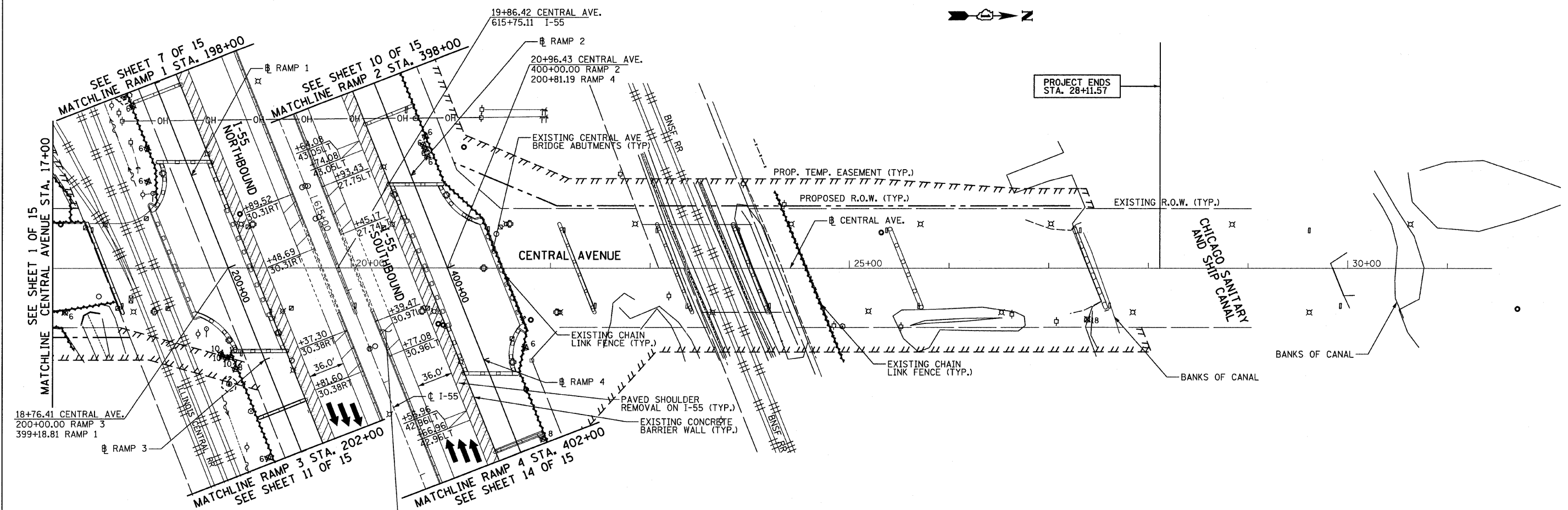

LEGEND - REMOVAL

- APPROACH SLAB REMOVAL
- PAVEMENT REMOVAL
- SIDEWALK REMOVAL, MEDIAN REMOVAL, SHOULDER REMOVAL
- GUARDRAIL REMOVAL, COMB. CC&G REMOVAL
- FENCE REMOVAL
- CONCRETE BARRIER REMOVAL
- TREE REMOVAL (SIZE IN UNITS)
- TREE TRUNK PROTECTION

EXISTING PLAN

I-55 MAINLINE AT CENTRAL AVE

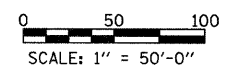
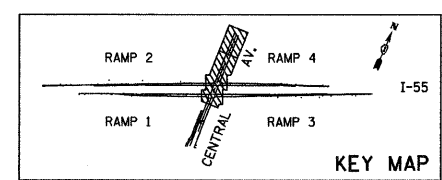

TYLIN INTERNATIONAL	USER NAME = #USER#	DESIGNED - AZ	REVISED -	STATE OF ILLINOIS DEPARTMENT OF TRANSPORTATION	CENTRAL AVENUE OVER I-55 EXISTING PLAN I-55 MAINLINE AT CENTRAL AVE					F.A.I. RTE.	SECTION	COUNTY	TOTAL SHEETS	SHEET NO.
	PLOT SCALE = #SCALE#	CHECKED - DMJ	REVISED -		I-55	0711.2R & 1011.1BR	COOK	741	107					
	PLOT DATE = 4/28/2011	DATE - 03/25/2011	REVISED -		SCALE: 1:50 SHEET NO. 2 OF 15 SHEETS STA. 17+00 TO STA. 28+11.57					CONTRACT NO. 60999				
					FED. ROAD DIST. NO. ILLINOIS FED. AID PROJECT									

P:\01345\ROAD\55\pish02elo.dgn