

NOTES:

- SEE EXISTING LIGHTING PLAN FOR REMOVAL OF EXISTING LIGHTING UNITS.
- REMOVE SIGN PANEL ASSEMBLY, TYPE A OR TYPE B INCLUDES THE REMOVAL OF THE EXISTING SIGN PANELS.

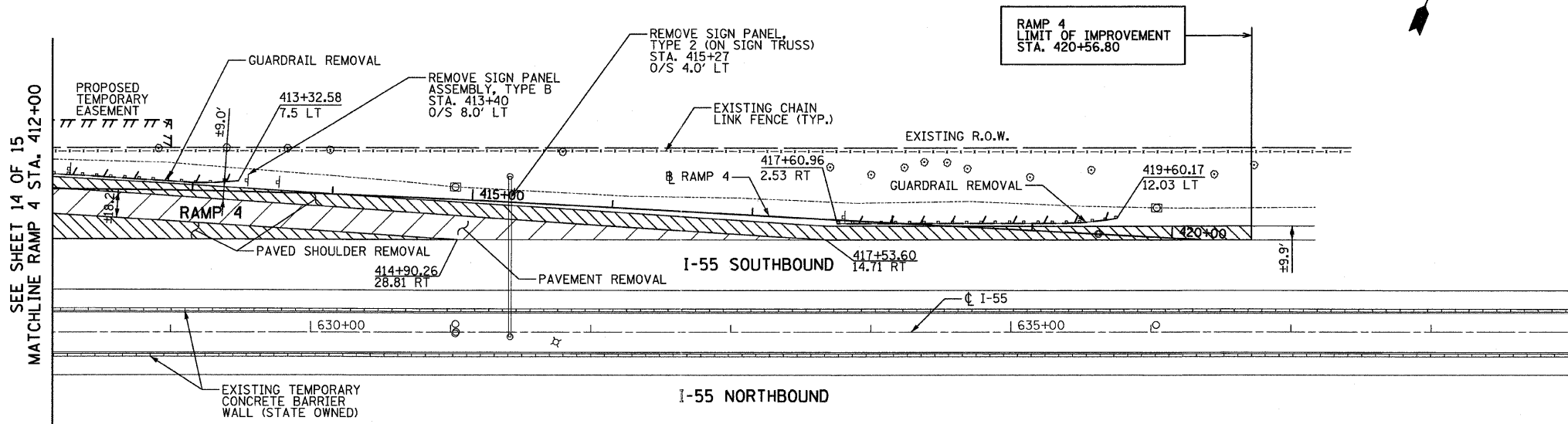

LEGEND - REMOVAL

- APPROACH SLAB REMOVAL
- PAVEMENT REMOVAL
- SIDEWALK REMOVAL, MEDIAN REMOVAL, SHOULDER REMOVAL
- GUARDRAIL REMOVAL, COMB. CC&G REMOVAL
- FENCE REMOVAL
- CONCRETE BARRIER REMOVAL
- TREE REMOVAL (SIZE IN UNITS)
- TREE TRUNK PROTECTION

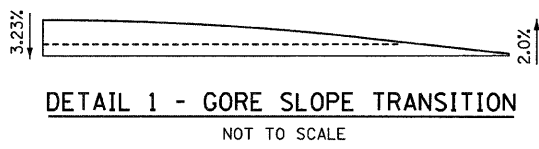
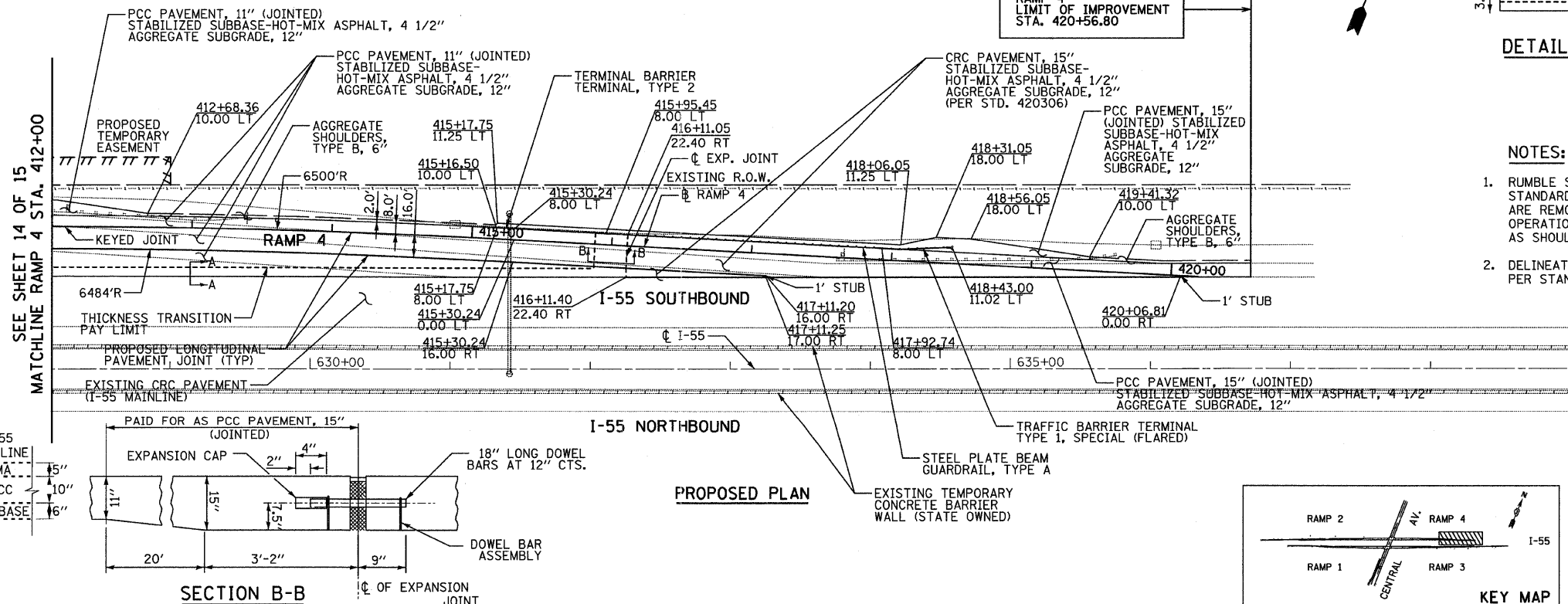

NOTES:

- RUMBLE STRIPS SHALL BE PLACED ALONG I-55 PER STANDARD 642001 IN ALL AREAS WHERE THEY ARE REMOVED FOR MAINTENANCE OF TRAFFIC OPERATIONS. THIS WORK SHALL BE PAID FOR AS SHOULDER RUMBLE STRIP.
- DELINEATORS SHALL BE PLACED ALONG THE RAMPS PER STANDARD 635001 EVERY 100 FT.

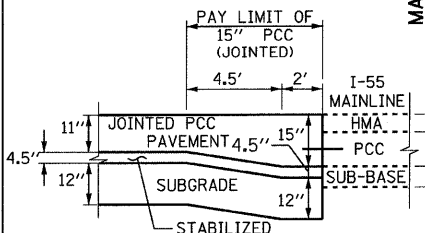

SECTION A-A
NOT TO SCALE

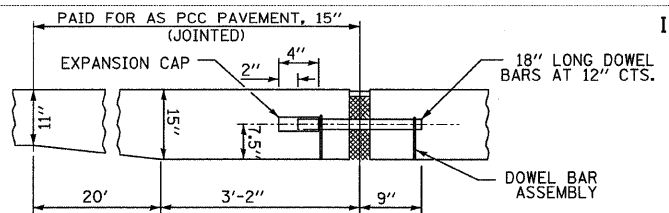

SECTION B-B
NOT TO SCALE

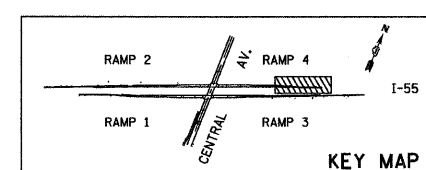

KEY MAP

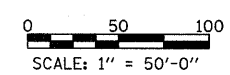

TYLIN INTERNATIONAL	USER NAME = #USER#	DESIGNED - AZ	REVISED -
	PLOT SCALE = #SCALE#	DRAWN - AZ	REVISED -
	PLOT DATE = 4/28/2011	CHECKED - DMJ	REVISED -
		DATE - 03/25/2011	REVISED -

STATE OF ILLINOIS
DEPARTMENT OF TRANSPORTATION

CENTRAL AVENUE OVER I-55		F.A.I. RTE.	SECTION	COUNTY	TOTAL SHEETS	SHEET NO.
EXISTING AND PROPOSED PLAN - I-55 - RAMP 4		I-55	0711.2R & 1011.1BR	COOK	741	120
SCALE: 1:50	SHEET NO. 15 OF 15 SHEETS	STA. 412+00	TO STA. 420+56.80		CONTRACT NO. 60999	
		FED. ROAD DIST. NO.	ILLINOIS FED. AID PROJECT			