

STATE OF ILLINOIS
DEPARTMENT OF TRANSPORTATION

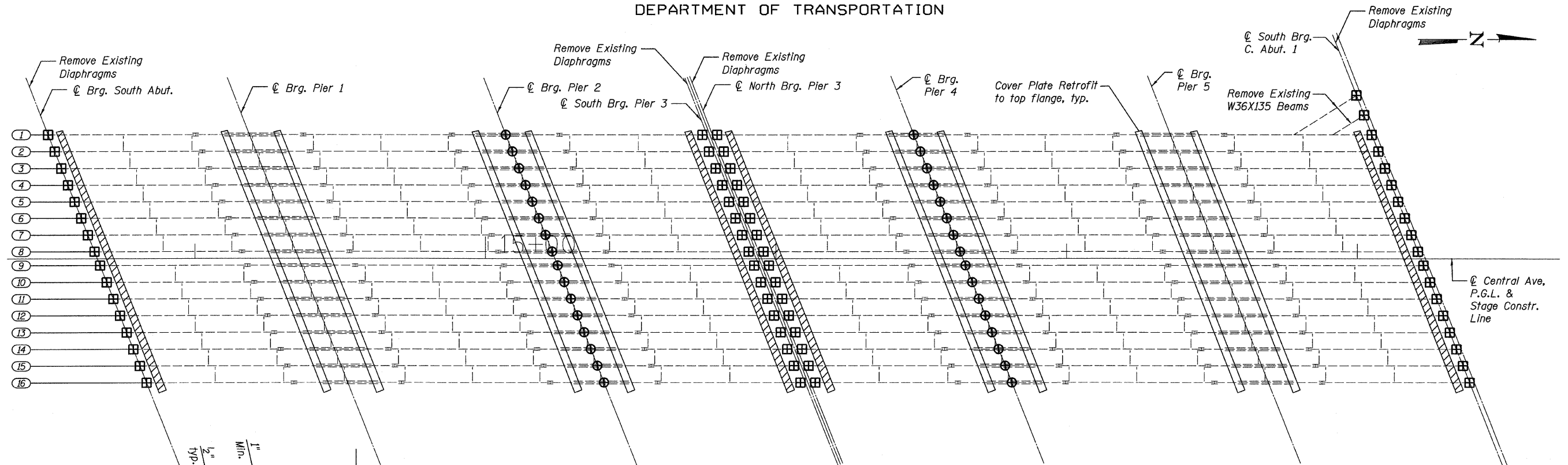

PLAN

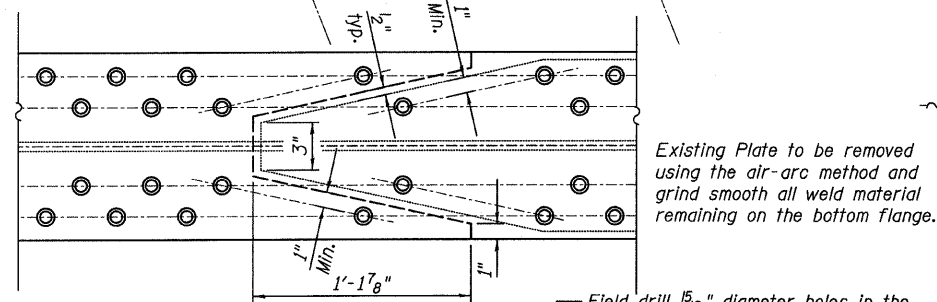

CLEARANCE DETAIL

Field drill $\frac{5}{16}$ " diameter holes in the flanges and cover plates of the existing wide flange section using the retrofit plates as template. Cost of field drilling included with Structural Steel Repair.

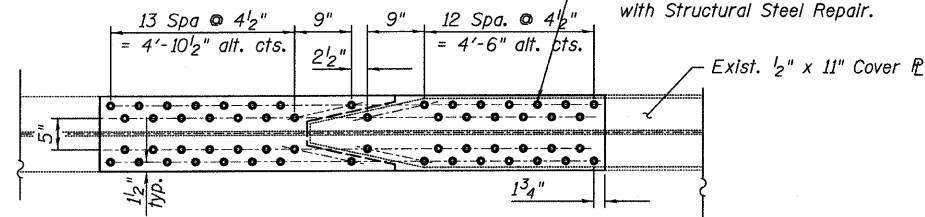

PLAN

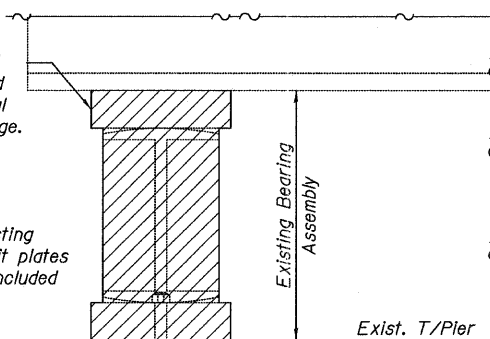

EXISTING BEARING REMOVAL DETAIL

LEGEND

- ⊕ Jack and Remove Existing Bearings
- ⊞ Remove Existing Bearings
- ▨ Jacking Existing Superstructure

BILL OF MATERIAL

Item	Unit	Total
Jack and Remove Existing Bearings	Each	32
Jacking Existing Superstructure	L Sum	0.55
Structural Steel Removal	L Sum	0.45
Structural Steel Repair	Pound	45,090
Removal of Existing Bearings	Each	66

** The total estimated weight for Structural Steel Removal is approximately 18,800 lbs.

JACK EXISTING SUPERSTRUCTURE

- Work shall be performed in accordance with these plans and the Special Provision "Jacking Existing Superstructure".
- Jacking Existing Superstructure shall be performed on the beams after deck removal.
- The following dead loads and jack capacities shall be applicable to each girder at S. Brg. C. Abutment 1, Pier 3 & the S. Abutment:

Dead Loads = 6 kips
Minimum Jack Capacity = 6 Tons

NOTES:

All work is to be performed under staged construction. See Stage Construction Sheets 3 through 5 for details.

Clean and prepare all surfaces that will be in contact with new steel retrofit or sole plates as specified in the Special Provision "Cleaning and Painting Contact Surface Areas for Existing Steel Structures".

The cost for the removal of the bearing plates, pintles, and anchor bolts is included in "Jack and Remove Existing Bearings", or "Removal of Existing Bearings".

The cost for removal of existing diaphragms and W36 beams is included in "Structural Steel Removal".

Structural Steel shall conform to the requirements of AASHTO M270 Grade 50.

Load carrying components designated "NTR" shall conform to the Supplemental Requirements for Notch Toughness, Zone 2.

COVER PLATE RETROFIT
& BEARING REMOVAL
STRUCTURE NO. 016-3241

JACK AND REMOVE EXISTING BEARING

- Work shall be performed in accordance with these plans and the Special Provision "Jack and Remove Existing Bearings". This work shall be done after existing concrete deck is removed and prior to pouring of the new concrete deck. The maximum service dead load reaction per girder at Pier 2 and Pier 4 (weight of steel only) is 20 kips. Minimum jack capacity = 18 Tons.
- Prior to ordering any material, the Contractor shall verify steel extension and shim plate thickness required at each bearing.

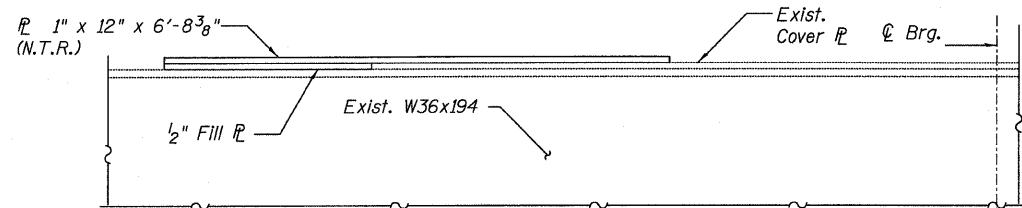

COVER PLATE REHABILITATION - ELEVATION

TYLIN INTERNATIONAL	DESIGNED - SP	REVISIONS	
	CHECKED - AMD,	NAME	DATE
	DRAWN - SP		
	CHECKED - AMD,		
	DATE - 03/25/2011		

SHEET NO. 45	F.A.I. RTE.	SECTION	COUNTY	TOTAL SHEETS	SHEET NO.
	55	0711.2R & 1011.1BR	COOK	741	298
71 SHEETS	CONTRACT NO. 60999				
FED. ROAD DIST. NO. 1 ILLINOIS FED. AID PROJECT					