

STATE OF ILLINOIS  
DEPARTMENT OF TRANSPORTATION

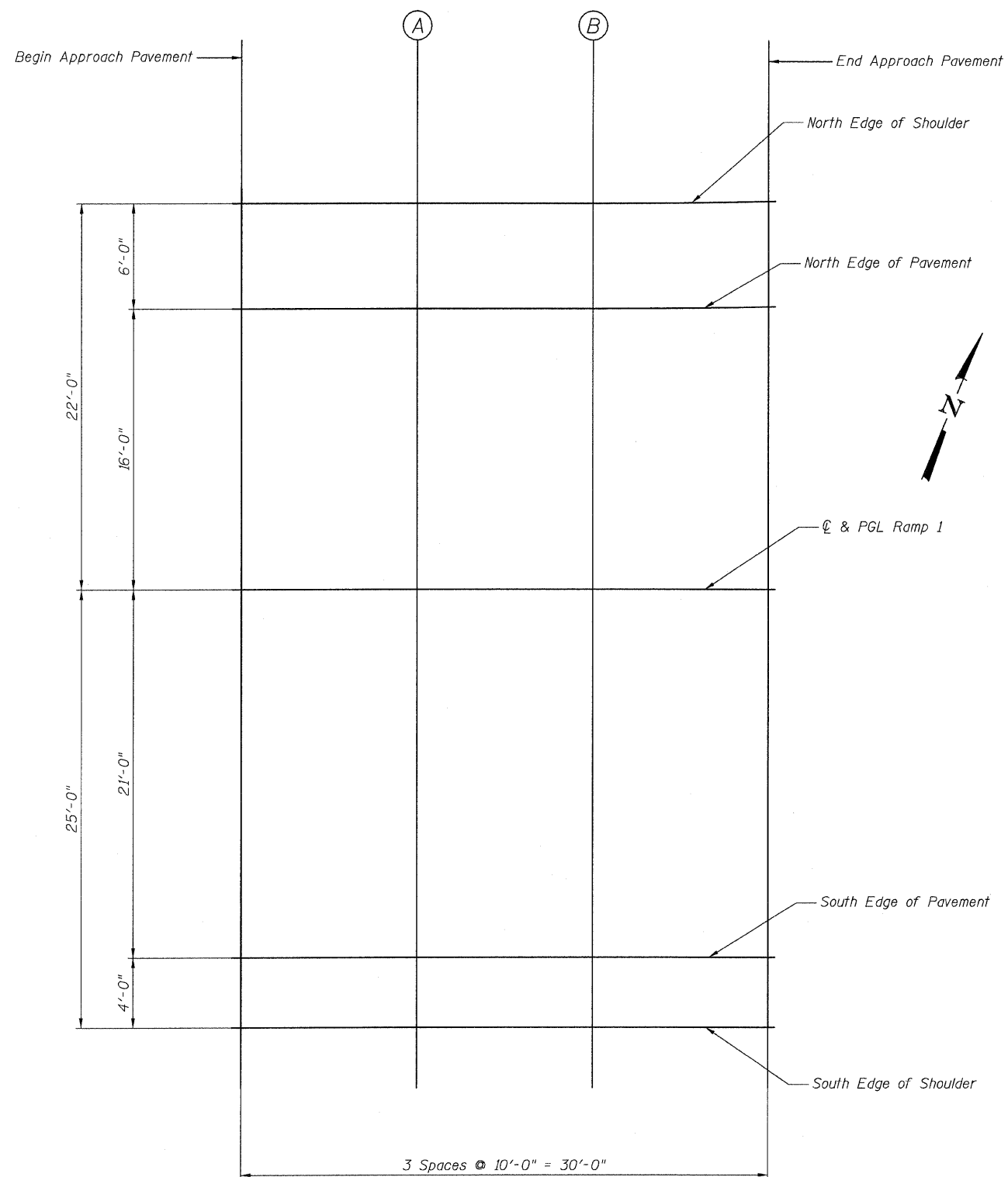

NORTH EDGE OF SHOULDER

Location	Station	Offset	Theoretical Grade Elevations
Begin Appr. Pav't	197+03.89	-22.00	626.17
A	197+13.89	-22.00	626.45
B	197+23.89	-22.00	626.74
End Appr. Pav't	197+33.89	-22.12	627.01

RAMP 1 P.G.L.

Location	Station	Offset	Theoretical Grade Elevations
Begin Appr. Pav't	197+03.89	0.00	622.42
A	197+13.89	0.00	622.63
B	197+23.89	0.00	622.83
End Appr. Pav't	197+33.89	0.00	623.03

NORTH EDGE OF PAVEMENT

Location	Station	Offset	Theoretical Grade Elevations
Begin Appr. Pav't	197+03.89	-16.00	626.23
A	197+13.89	-16.00	626.51
B	197+23.89	-16.00	626.80
End Appr. Pav't	197+33.89	-16.12	627.07

SOUTH EDGE OF PAVEMENT

Location	Station	Offset	Theoretical Grade Elevations
Begin Appr. Pav't	197+03.89	21.00	626.77
A	197+13.89	21.00	627.05
B	197+23.89	21.00	627.34
End Appr. Pav't	197+33.89	21.00	627.61

SOUTH EDGE OF SHOULDER

Location	Station	Offset	Theoretical Grade Elevations
Begin Appr. Pav't	197+03.89	25.00	626.86
A	197+13.89	25.00	627.14
B	197+23.89	25.00	627.43
End Appr. Pav't	197+33.89	25.00	627.71

TOP OF RAMP 1 APPROACH  
SLAB ELEVATIONS  
STRUCTURE NO. 016-0724

<b>TYLIN INTERNATIONAL</b>	DESIGNED - EKH	REVISIONS		SHEET NO. 35	F.A.I. RTE. 55	SECTION 0711.2R & 1011.1BR	COUNTY COOK	TOTAL SHEETS 741	SHEET NO. 359
	CHECKED - AMD,	NAME	DATE						
	DRAWN - EKH								
	CHECKED - AMD,								
	DATE - 03/25/2011			239 SHEETS	CONTRACT NO. 60999				
FED. ROAD DIST. NO. 1 ILLINOIS FED. AID PROJECT									