

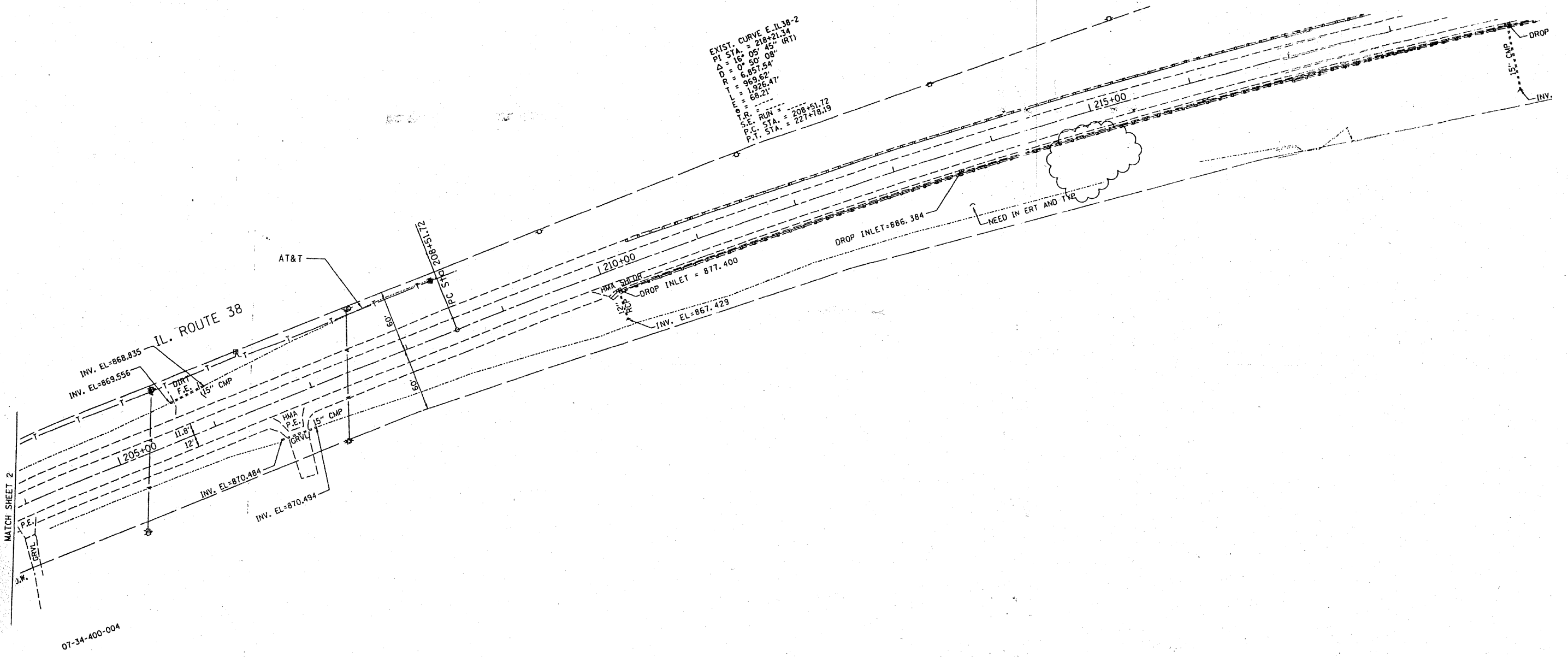

EXIST. CURVE E-IL38-2
 P.I. STA. = 218+21.34
 P.D. = 162.05' (RT)
 D = 685.54'
 ELEV. = 969.62'
 L = 1926.47'
 ELEV. = 68.21'
 S.P. = 208+51.72
 P.C. STA. = 227+78.19



07-34-400-004

- A — A — AERIAL UTILITY
- — — UNKNOWN
- CTV — CTV — CABLE TV
- T — T — TELEPHONE
- G — G — GAS
- E — E — ELECTRIC
- W — W — WATER
- FO — FO — FIBER OPTIC
- — — SEWER
- ⊕ — ⊕ — TBE TEST HOLE

DESIGNED	EG	REVISED	
DRAWN	KLC	REVISED	
CHECKED		REVISED	
DATE	10/27/10	REVISED	

Utilities shown in color on these plans as depicted in the legend have been investigated by Cardno TBE in accordance with SUE Industry Standards. All other information shown has been provided to Cardno TBE by others. TBE's SUE field investigation was finished on 10/01/10. Changes to utilities after this date may have been made and therefore may result in variances from this plan. Consideration should be given to updating this plan if deemed advisable prior to final design and construction.

ALL UTILITIES SHOWN IN COLOR
 QUALITY LEVEL "B" UNLESS NOTED OTHERWISE.

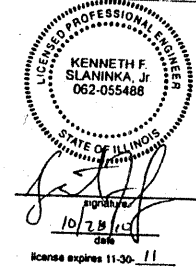

STATE OF ILLINOIS
 DEPARTMENT OF TRANSPORTATION

IL RT. 38 at Meredith Road
 Maple Park, IL.

TBE Job No. IL09510420
 SUE Plan Page: 3 of 4

F.A. RTE.	SECTION	COUNTY	TOTAL SHEETS	SHEET NO.
	SR-N-1	Kane	77	17
FED. ROAD DIST. NO. ILLINOIS IDOT Project No.			Contract No. 60K65	