

DATE: \_\_\_\_\_  
 BY: \_\_\_\_\_  
 SURVEYED \_\_\_\_\_  
 PLOTTED \_\_\_\_\_  
 CHECKED \_\_\_\_\_  
 NOTE BOOK NO. \_\_\_\_\_  
 PL. OF WAY CHECKED \_\_\_\_\_  
 CAD FILE NAME \_\_\_\_\_

DATE: \_\_\_\_\_  
 BY: \_\_\_\_\_  
 SURVEYED \_\_\_\_\_  
 PLOTTED \_\_\_\_\_  
 CHECKED \_\_\_\_\_  
 NOTE BOOK NO. \_\_\_\_\_  
 STRUCTURE NOTATIONS CHKD \_\_\_\_\_

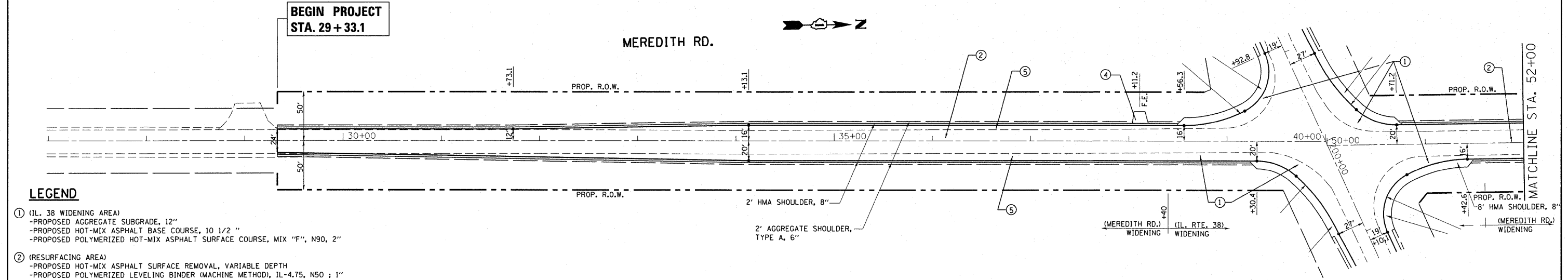

- LEGEND**
- ① (IL. 38 WIDENING AREA)
    - PROPOSED AGGREGATE SUBGRADE, 12"
    - PROPOSED HOT-MIX ASPHALT BASE COURSE, 10 1/2"
    - PROPOSED POLYMERIZED HOT-MIX ASPHALT SURFACE COURSE, MIX "F", N90, 2"
  - ② (RESURFACING AREA)
    - PROPOSED HOT-MIX ASPHALT SURFACE REMOVAL, VARIABLE DEPTH
    - PROPOSED POLYMERIZED LEVELING BINDER (MACHINE METHOD), IL-4.75, N50, 1"
    - PROPOSED POLYMERIZED HOT-MIX ASPHALT SURFACE COURSE, MIX "F", N90, 2"
  - ③ (HMA P.E.) PRIVATE ENTRANCE
    - PROPOSED HOT-MIX ASPHALT BASE COURSE, 6"
    - PROPOSED HOT-MIX ASPHALT SURFACE COURSE, MIX "C", N50, 2"
  - ④ (HMA F.E.) FIELD ENTRANCE
    - PROPOSED AGGREGATE BASE COURSE, TYPE B, 8"
    - PROPOSED HOT-MIX ASPHALT SURFACE COURSE, MIX "C", N50, 2"
  - ⑤ (MEREDITH RD. WIDENING AREA)
    - PROPOSED AGGREGATE SUBGRADE, 12"
    - PROPOSED HOT-MIX ASPHALT BASE COURSE, 7"
    - PROPOSED POLYMERIZED HOT-MIX ASPHALT SURFACE COURSE, MIX "F", N90, 2"

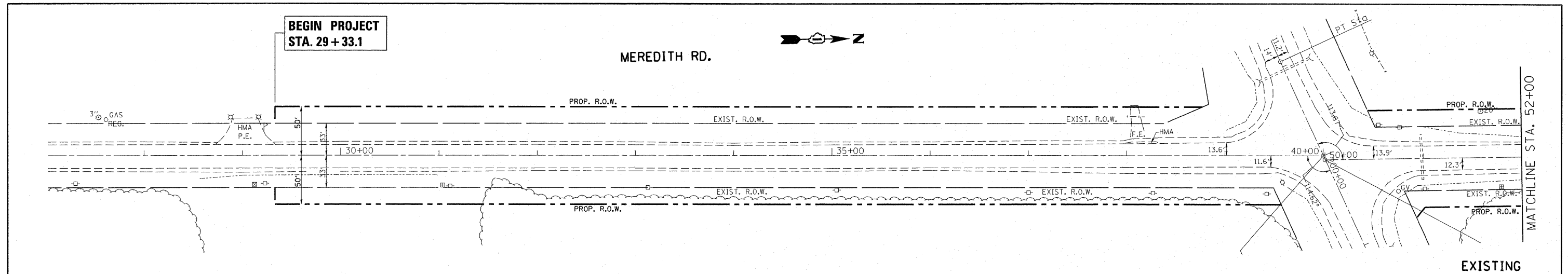
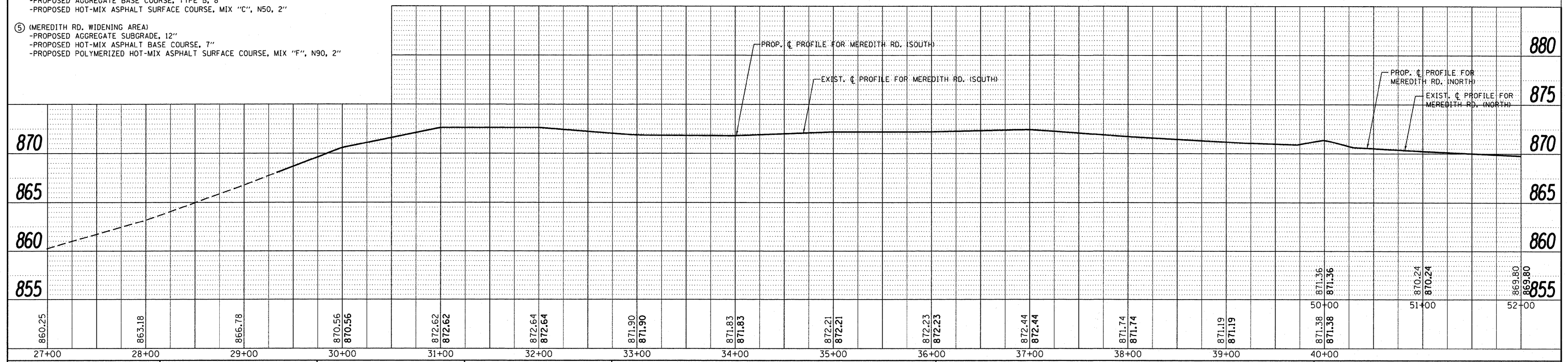

|  |                    |            |           |   |   |                           |                                  |                    |                 |              |  |  |
|--|--------------------|------------|-----------|---|---|---------------------------|----------------------------------|--------------------|-----------------|--------------|--|--|
| FILE NAME =                              | USER NAME = abreuh | DESIGNED - | REVISED - | <b>STATE OF ILLINOIS<br/>DEPARTMENT OF TRANSPORTATION</b> | <b>ROADWAY PLAN &amp; PROFILE<br/>IL. RTE. 38 AT MEREDITH RD.</b> | F.A.P. RTE. 567           | SECTION 5 R-N-1                  | COUNTY KANE        | TOTAL SHEETS 77 | SHEET NO. 21 |  |  |
| es:\pwork\pudot\abreuh\d0139641\VP115308 | sh:plnprf.dgn      | DRAWN -    | REVISED - |   |   | SCALE: 1"=50'             | SHEET NO. OF SHEETS STA. TO STA. | CONTRACT NO. 60K65 |                 |              |  |  |
|  |                    | CHECKED -  | REVISED - |   |   | ILLINOIS FED. AID PROJECT |                                  |                    |                 |              |  |  |
|  |                    | DATE -     | REVISED - |   |   |                           |                                  |                    |                 |              |  |  |