

**WOLF ROAD
STAGE 1
STA. 195+41.79 TO STA. 198+76.88**

LEGEND:

- (A) TEMPORARY PAVEMENT MARKING, TYPE III
4" SOLID WHITE EDGE LINE
- (B) TEMPORARY PAVEMENT MARKING, TYPE III
4" SOLID DOUBLE YELLOW
- (C) TEMPORARY PAVEMENT MARKING, TYPE III
6" SOLID WHITE (TURN LANE)
- (D) TEMPORARY PAVEMENT MARKING, TYPE III
6" WHITE DOTTED (TURN LANE)
- PAVEMENT REMOVAL
- TEMPORARY PAVEMENT, 10"
- WORK ZONE

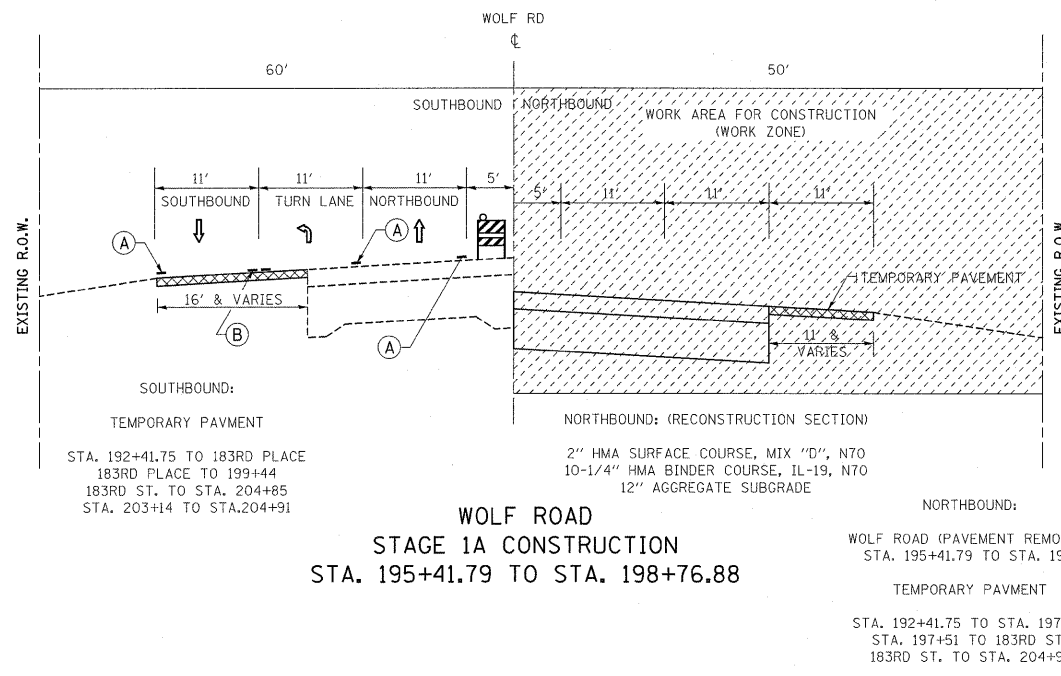

**WOLF ROAD
STAGE 1A CONSTRUCTION
STA. 195+41.79 TO STA. 198+76.88**

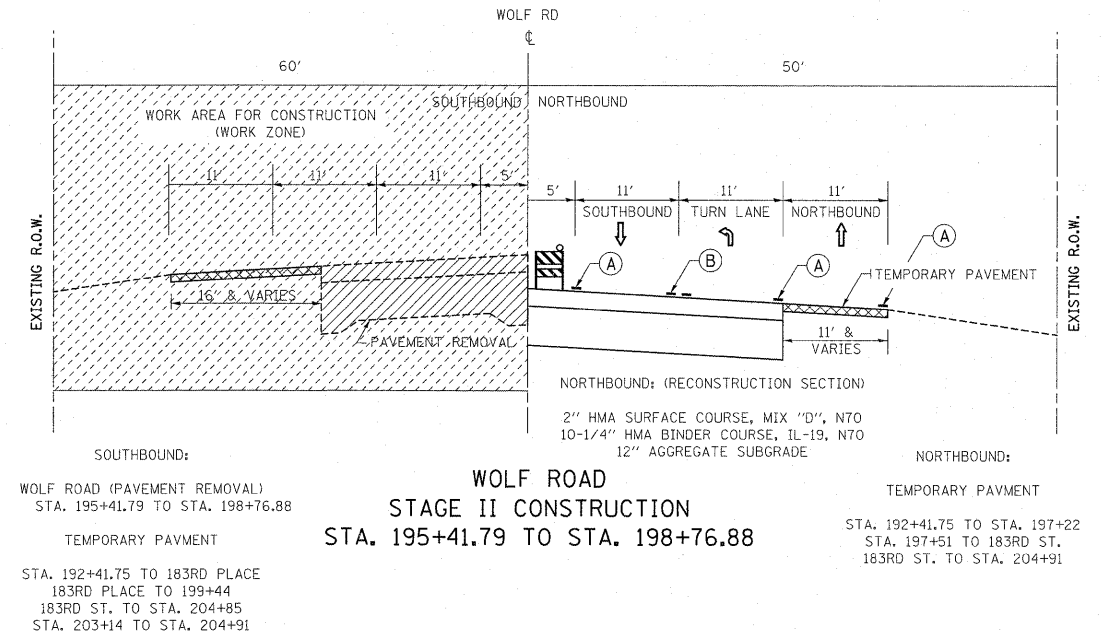

**WOLF ROAD
STAGE II CONSTRUCTION
STA. 195+41.79 TO STA. 198+76.88**

FILE NAME =	USER NAME = galbanjr	DESIGNED -	REVISED -
ct:\pw_work\p\p\dot\galbanjr\d0150417\PI14309-Design.dgn		DRAWN -	REVISED -
		CHECKED -	REVISED -
		DATE -	REVISED -
	PLOT SCALE = 50.0000' / IN.		
	PLOT DATE = 5/3/2011		

**STATE OF ILLINOIS
DEPARTMENT OF TRANSPORTATION**

TYPICAL SECTIONS FOR MAINTENANCE OF TRAFFIC			
SCALE:	SHEET NO.	OF SHEETS	STA. TO STA.

F.A.U. RTE. 2688	SECTION 44 R-N	COUNTY COOK/WILL	TOTAL SHEETS 68	SHEET NO. 13
CONTRACT NO. 60K66				ILLINOIS FED. AID PROJECT