

**PROJECT BEGINS  
STA. 191 + 08.41**

**WOLF ROAD**

**183RD PLACE**

STA. 197+00

**LEGEND:**

- (A) TEMPORARY PAVEMENT MARKING, TYPE III  
4" SOLID WHITE EDGE LINE
- (B) TEMPORARY PAVEMENT MARKING, TYPE III  
4" SOLID DOUBLE YELLOW
- (C) TEMPORARY PAVEMENT MARKING, TYPE III  
6" SOLID WHITE (TURN LANE)
- (D) TEMPORARY PAVEMENT MARKING, TYPE III  
6" WHITE DOTTED (TURN LANE)
- (E) TEMPORARY PAVEMENT MARKING, TYPE III  
24" SOLID WHITE (STOP BAR)

- BARRICADE TYPE I OR TYPE II OR REFLECTORIZED DRUM  
OR VERTICAL PANEL WITH ONE BURN LIGHT
- ⊥ TYPE II BARRICADE WITH 2 LIGHTS ONE SYMBOL  
REPRESENTS ANY NUMBER OF BARRICADES REQUIRED  
TO ADEQUATELY PROTECT THE AREA SHOWN
- ⊥ CONSTRUCTION SIGN AND REFERENCE NUMBER  
(REFER TO SIGN DETAIL LEGEND SHEET)
- ↑ TRAFFIC LANE

• RECONSTRUCTION SECTION:  
STA. 195+41.79 TO STA. 198+76.88

FOR WIDENING AND RESURFACING OPERATIONS  
THE SIGNING, BARRICADING AND LANE CLOSURE  
SHALL BE IN ACCORDANCE WITH STD. 701606  
IN ADDITION TO THE SIGNS SHOWN.

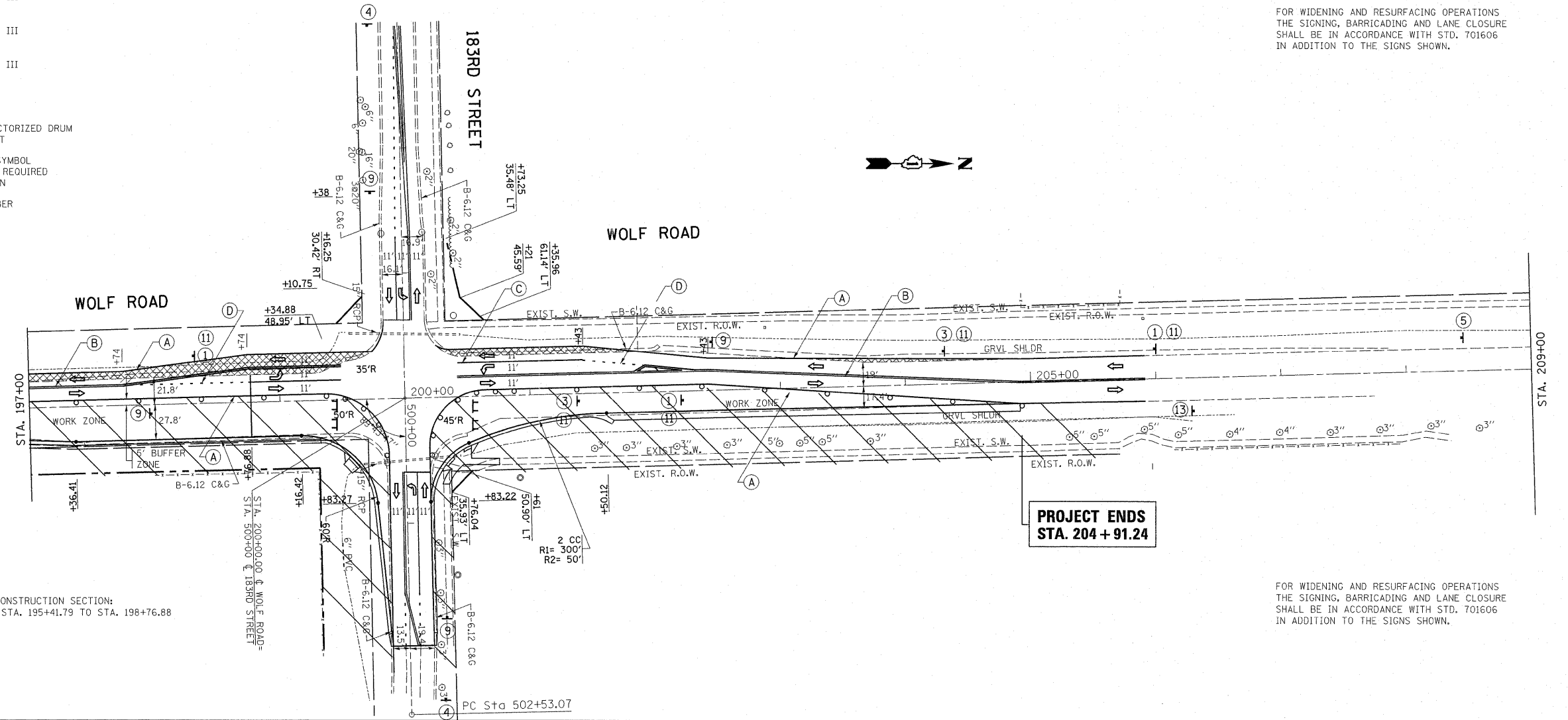

**PROJECT ENDS  
STA. 204 + 91.24**

• RECONSTRUCTION SECTION:  
STA. 195+41.79 TO STA. 198+76.88

FOR WIDENING AND RESURFACING OPERATIONS  
THE SIGNING, BARRICADING AND LANE CLOSURE  
SHALL BE IN ACCORDANCE WITH STD. 701606  
IN ADDITION TO THE SIGNS SHOWN.

FILE NAME =	USER NAME = galbenjr	DESIGNED -	REVISED -	<b>STATE OF ILLINOIS DEPARTMENT OF TRANSPORTATION</b>	<b>WOLF ROAD AT 183RD STREET SUGGESTED STAGING &amp; TRAFFIC CONTROL PLAN, STAGE I</b>				F.A.U. RTE. 2688	SECTION 44 R-N	COUNTY COOK/WILL	TOTAL SHEETS 68	SHEET NO. 16
es:\pw_work\pwidet\galbenjr\d0150417\14309-Design.dgn	PLOT SCALE = 58.0000' / IN.	DRAWN -	REVISED -		SCALE:	SHEET NO.	OF	SHEETS	STA.	TO STA.	CONTRACT NO. 60K66		
PLOT DATE = 5/3/2011	DATE -	CHECKED -	REVISED -		ILLINOIS FED. AID PROJECT								
		DATE -	REVISED -										