

RESTORATION OF WORK AREA. RESTORATION OF THE TRAFFIC SIGNAL WORK AREA SHALL BE INCLUDED IN THE RELATED PAY ITEM SUCH AS FOUNDATION, CONDUIT, HANDHOLE, TRENCH AND BACKFILL, ETC., AND NO EXTRA COMPENSATION SHALL BE ALLOWED. ALL ROADWAY SURFACES SUCH AS SHOULDERS, MEDIAN, SIDEWALKS, PAVEMENT ETC. SHALL BE REPLACED IN KIND. ALL DAMAGE TO MOWED LAWNS SHALL BE REPLACED WITH AN APPROVED SOD, AND ALL DAMAGE TO UNMOWED FIELDS SHALL BE SEEDED IN ACCORDANCE WITH STANDARD SPECIFICATIONS 252 AND 250 RESPECTIVELY.

THE TRAFFIC SIGNAL CONTROL EQUIPMENT FOR THIS PROJECT SHALL BE NTCIP COMPLIANT "ECONOLITE" FOR COMPATIBILITY WITH THE ADJACENT SYSTEM

CONSTRUCTION NOTES:

1. AT LOCATIONS WHERE UPS IS INSTALLED AND AN EMERGENCY VEHICLE PRIORITY SYSTEM IS IN USE, ANY EXISTING INCANDESCENT CONFIRMATION BEACONS SHALL BE REPLACED WITH LED LAMPS IN ACCORDANCE WITH THE DISTRICT ONE EMERGENCY VEHICLE PRIORITY SYSTEM SPECIFICATION AT NO ADDITIONAL COST TO THE CONTRACT.
2. PAN TILT ZOOM CAMERA TO BE INSTALLED ON 20 FOOT LUMINAIRE ARM.
3. THE 2" CONDUIT STUB SHALL INCLUDE A CAP TO PROTECT THE PIPE THREADS AND PREVENT DIRT OR MOISTURE FROM ENTERING THE HANDHOLE.

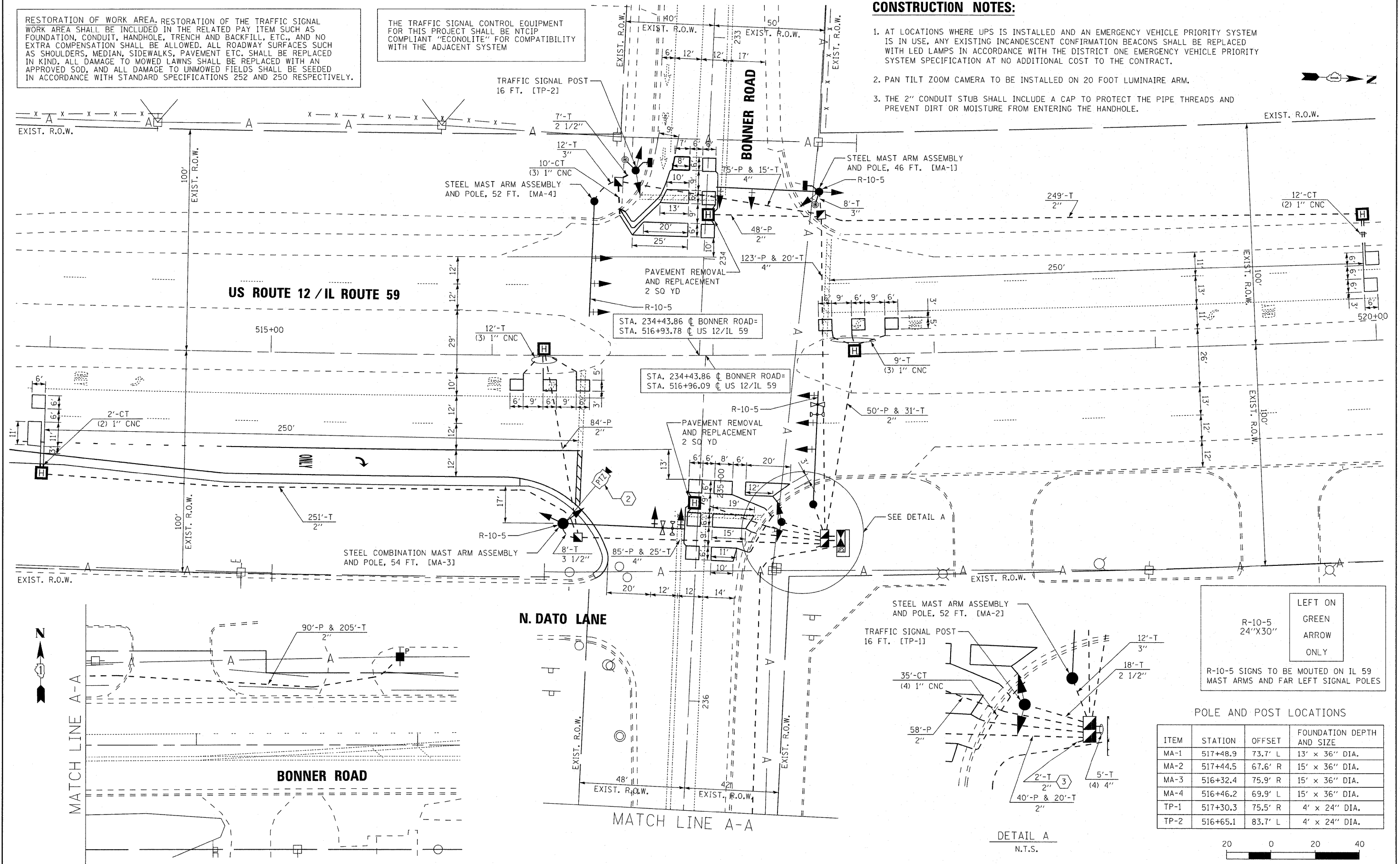

LEFT ON
GREEN
ARROW
ONLY

R-10-5
24"X30"

R-10-5 SIGNS TO BE MOUNTED ON IL 59
MAST ARMS AND FAR LEFT SIGNAL POLES

POLE AND POST LOCATIONS

ITEM	STATION	OFFSET	FOUNDATION DEPTH AND SIZE
MA-1	517+48.9	73.7' L	13' x 36" DIA.
MA-2	517+44.5	67.6' R	15' x 36" DIA.
MA-3	516+32.4	75.9' R	15' x 36" DIA.
MA-4	516+46.2	69.9' L	15' x 36" DIA.
TP-1	517+30.3	75.5' R	4' x 24" DIA.
TP-2	516+65.1	83.7' L	4' x 24" DIA.

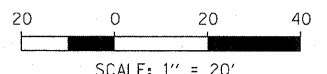

DETAIL A
N.T.S.