

AUXILIARY LANE MARKINGS

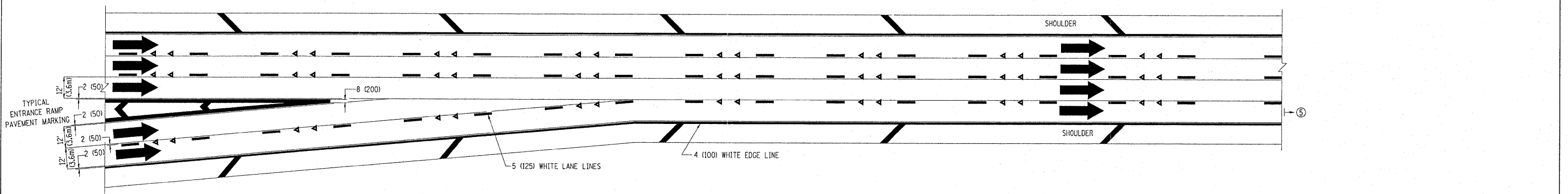

TWO LANE ENTRANCE RAMP WITH MERGE MARKINGS

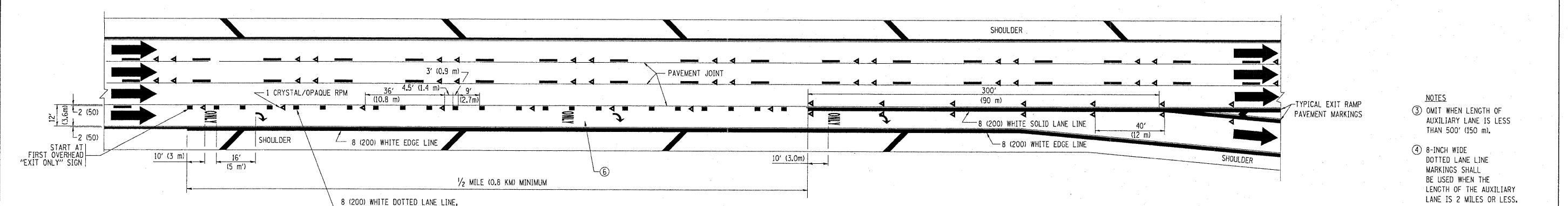

EXIT ONLY LANE MARKINGS

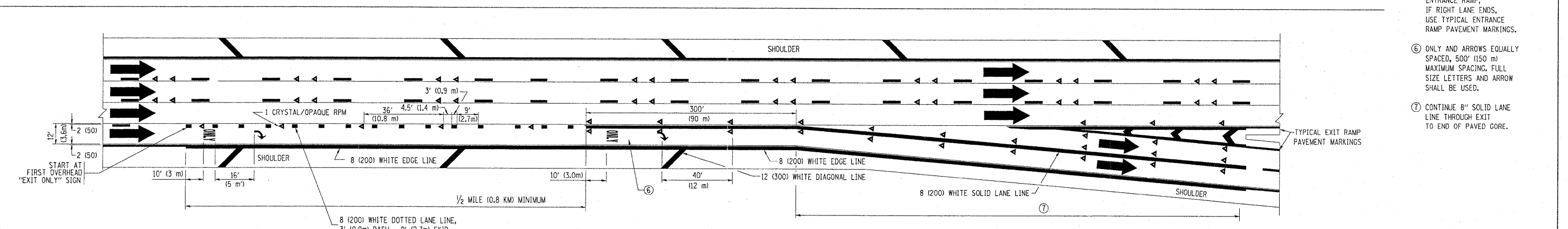

EXIT ONLY WITH OPTION LANE MARKINGS

- NOTES**
- ③ OMIT WHEN LENGTH OF AUXILIARY LANE IS LESS THAN 500' (150 m).
 - ④ 8-INCH WIDE DOTTED LANE LINE MARKINGS SHALL BE USED WHEN THE LENGTH OF THE AUXILIARY LANE IS 2 MILES OR LESS.
 - ⑤ FOR TWO-LANE ENTRANCE RAMP, IF RIGHT LANE ENDS, USE TYPICAL ENTRANCE RAMP PAVEMENT MARKINGS.
 - ⑥ ONLY AND ARROWS EQUALLY SPACED, 500' (150 m) MAXIMUM SPACING. FULL SIZE LETTERS AND ARROW SHALL BE USED.
 - ⑦ CONTINUE 8" SOLID LANE LINE THROUGH EXIT TO END OF PAVED GORE.

6-2-2011

Added Sheet 6-6-11

FILE NAME =	USER NAME = lsgsa	DESIGNED - D.W.S.	REVISED - D.W.S. 07-96	STATE OF ILLINOIS DEPARTMENT OF TRANSPORTATION	MULTI-LANE FREEWAY PAVEMENT MARKING DETAILS			F.A.R. RTE.	SECTION	COUNTY	TOTAL SHEETS	SHEET NO.
oi:\pwork\PWIDOT\LEYSA\d0106315\to12.dgn		DRAWN -	REVISED - J.A.F. 02-06		345	BR-1-RS-4	KANE/COOK	124	118B			
PLOT SCALE = 50.000' / IN.		CHECKED -	REVISED - S.P.B. 01-07		TC-12			CONTRACT NO. 60M46				
PLOT DATE = 1/22/2010		DATE - 01-90	REVISED - S.P.B. 01-10		SCALE: NONE	SHEET NO. 2 OF 2 SHEETS	STA. TO STA.	FED. ROAD DIST. NO. 1 ILLINOIS FED. AID PROJECT				