

FILE NAME : P:\2009\ME09006_VerVer_Plan\CADD\W021.US20\Shs\0160M46-33-Sign07.dgn
 USER NAME : Millennium Professional Services

MATCHLINE STA. 240+00
SEE SHEET 31

MATCHLINE STA. 255+00

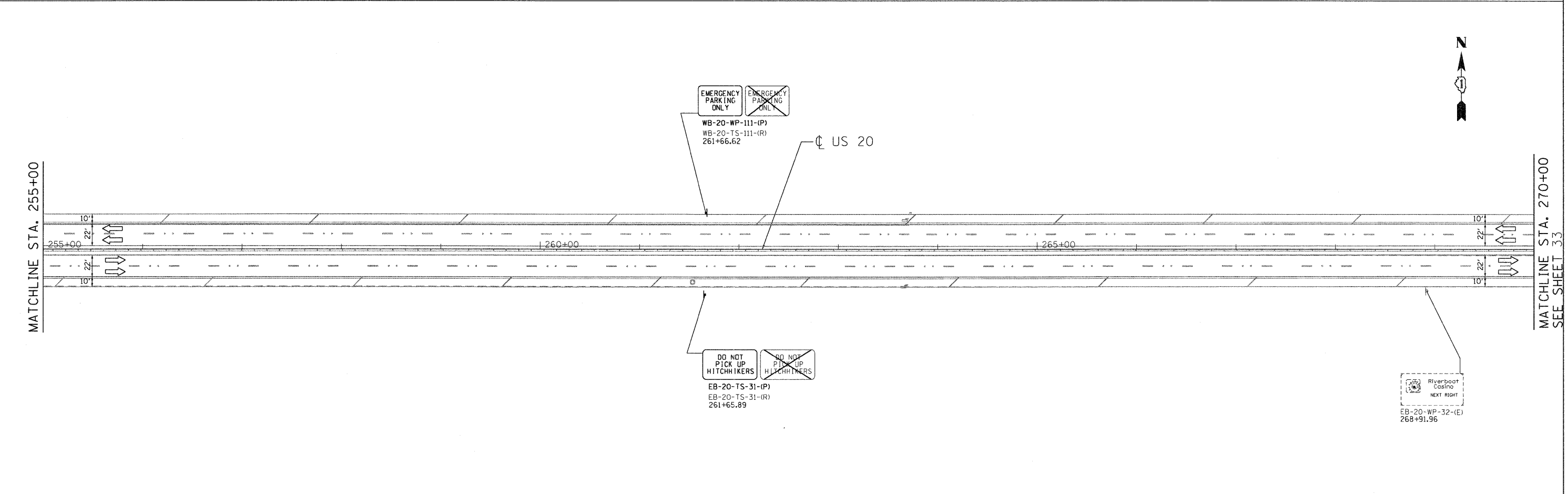

MATCHLINE STA. 255+00

MATCHLINE STA. 270+00
SEE SHEET 33

MILLENNIA PROFESSIONAL SERVICES
 200 22ND Street, Suite 216, Lombard, IL 60148
 630.765.8110 voice, 630.839.2566 fax
 www.mps-il.com

DESIGNED -	CJD	REVISED -	
DRAWN -	CJD	REVISED -	
CHECKED -	TVN	REVISED -	
DATE -	4/4/2011	REVISED -	

**STATE OF ILLINOIS
DEPARTMENT OF TRANSPORTATION**

**US ROUTE 20 (LAKE STREET)
RANDALL RD TO SHALES PARKWAY**

SIGNING PLAN

SCALE: SHEET NO. OF SHEETS STA. TO STA.

F.A.P. RTE.	SECTION	COUNTY	TOTAL SHEETS	SHEET NO.
345	BR-1-RS-4	KANE/COOK	124	32
CONTRACT NO. 60M46				

FED. ROAD DIST. NO. 1 ILLINOIS FED. AID PROJECT

P:\2009\ME09006_VerVer_Plan\CADD\W021.US20\Shs\0160M46-33-Sign07.dgn