

CANADIAN PACIFIC RAILWAY PROP. TRACK #1 COORDINATES

ALIGNMENT CPR 1	NORTHING	EASTING	BEARING	DISTANCE
POINT OF SWITCH PI STA. 10272+ 35.24	1,926,727.7085	1,092,978.8381	N 78° 46' 00.08" W	39.95
PI TURNOUT PI STA. 10272+ 75.19	1,926,735.4910	1,092,939.6534	N 74° 56' 54.08" W	328.53
CPR1-C1 PC STA. 10276+ 03.72	1,926,820.8067	1,092,622.3949		
PI STA. 10276+ 29.32	1,926,827.4571	1,092,597.6646		
PT STA. 10276+ 54.93	1,926,833.5532	1,092,572.7919	N 76° 13' 43.12" W	131.73
CPR1-S01 TS STA. 10277+ 86.86	1,926,864.9108	1,092,444.8507		
PI STA. 10278+ 46.66	1,926,879.1949	1,092,386.5704		
SC STA. 10278+ 76.66	1,926,887.5210	1,092,357.7439	N 73° 53' 22.01" W	N/A
CPR1-C2 SC STA. 10278+ 76.66	1,926,887.5210	1,092,357.7439		
PI STA. 10286+ 36.94	1,927,098.4945	1,091,627.3139		
CS STA. 10292+ 07.31	1,927,856.2311	1,092,565.0795	N 4° 41' 42.99" W	N/A
CPR1-S02 CS STA. 10292+ 07.31	1,927,856.2311	1,092,565.0795		
PI STA. 10292+ 37.32	1,927,886.1352	1,091,562.6235		
ST STA. 10292+ 97.31	1,927,946.0897	1,091,560.1567	N 2° 21' 21.89" W	1134.06
CPR1-C3 PC STA. 10304+ 31.37	1,929,079.1887	1,091,513.5358		
PI STA. 10304+ 80.05	1,929,127.8322	1,091,511.5344		
PT STA. 10305+ 28.72	1,929,176.3468	1,089,223.4604	N 4° 47' 23.11" W	91.03
CPR1-C4 PC STA. 10306+ 19.75	1,929,267.0597	1,091,499.8682		
PI STA. 10306+ 68.43	1,929,315.5743	1,091,495.8031		
PT STA. 10307+ 17.09	1,929,364.2178	1,091,493.8017	N 2° 21' 21.89" W	1811.44
CPR1-C5 PC STA. 10325+ 28.53	1,931,174.1237	1,091,419.3339		
PI STA. 10326+ 20.49	1,931,266.0086	1,091,415.5534		
PT STA. 10327+ 12.44	1,931,357.9677	1,091,414.7318	N 0° 30' 42.83" W	213.43
POT PI STA. 10329+ 25.87	1,931,571.3864	1,091,412.8250		

CANADIAN PACIFIC RAILWAY PROP. TRACK #2 COORDINATES

ALIGNMENT CPR 2	NORTHING	EASTING	BEARING	DISTANCE
POINT OF SWITCH PI STA. 20276+ 11.43	1,926,806.6365	1,092,581.4353	N 78° 46' 00.08" W	39.95
PI TURNOUT PI STA. 20276+ 51.38	1,926,814.4190	1,092,542.2507	N 74° 56' 54.08" W	130.38
CPR2-S01 TS STA. 20277+ 81.76	1,926,848.2772	1,092,416.3441		
PI STA. 20278+ 41.77	1,926,863.8599	1,092,358.3977		
SC STA. 20278+ 71.76	1,926,872.8017	1,092,329.7565	N 72° 39' 41.78" W	N/A
CPR2-C1 SC STA. 20278+ 71.76	1,926,872.8017	1,092,329.7565		
PI STA. 20286+ 32.54	1,927,099.5244	1,091,603.5482		
CS STA. 20292+ 09.84	1,927,857.8050	1,091,541.9678	N 4° 38' 34.18" W	N/A
CPR2-S02 CS STA. 20292+ 09.84	1,927,857.8050	1,091,541.9678		
PI STA. 20292+ 39.84	1,927,887.7111	1,091,539.5392		
ST STA. 20292+ 99.84	1,927,947.6654	1,091,537.0724	N 2° 21' 21.89" W	3192.99
CPR2-C2 PC STA. 20324+ 92.83	1,931,137.9625	1,091,405.8091		
PI STA. 20325+ 84.42	1,931,229.4688	1,091,402.0441		
PT STA. 20326+ 75.98	1,931,321.0487	1,091,401.2056	N 0° 31' 28.50" W	250.23
POT PI STA. 20329+ 26.21	1,931,571.2621	1,091,398.9146		

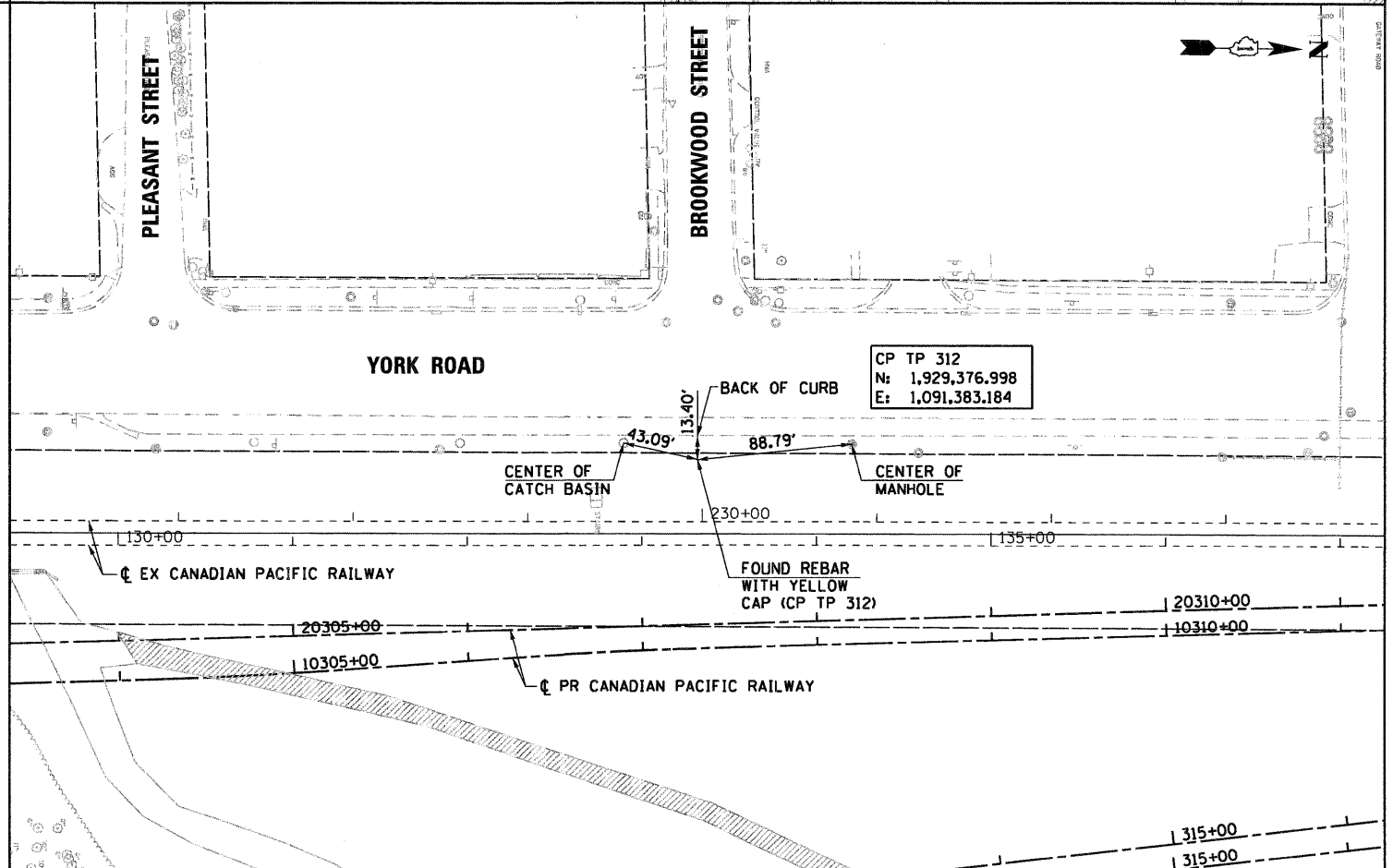

FILE NAME = ...\\D16086-SHT-ATB-RR02.DGN

USER NAME = nmatern
 PLOT SCALE = 50.00' / IN.
 PLOT DATE = 3/25/2011

DESIGNED - NMR
 DRAWN - NMR
 CHECKED - LGP
 DATE - 03/17/2011

REVISED -
 REVISED -
 REVISED -
 REVISED -

STATE OF ILLINOIS
 DEPARTMENT OF TRANSPORTATION

ALIGNMENT TIES & BENCHMARKS
 CANADIAN PACIFIC RAILWAY

SCALE: 1"=50' SHEET NO. 2 OF 2 SHEETS STA. TO STA.

F.A.U. RTE.	SECTION	COUNTY	TOTAL SHEETS	SHEET NO.
1321	2010-134-T	DUPAGE	40	8
CONTRACT NO. 60N06				
ILLINOIS FED. AID PROJECT				