

- NOTES:
1. SEEDING, CLASS 7; MULCH, METHOD 4; AND TEMPORARY EROSION CONTROL SEEDING SHALL BE INSTALLED AS EMBANKMENT IS COMPLETED.
 2. THE INSTALLED PERIMETER EROSION BARRIER SHALL REMAIN IN PLACE UNTIL THE START OF IDOT CONTRACT 60B42.

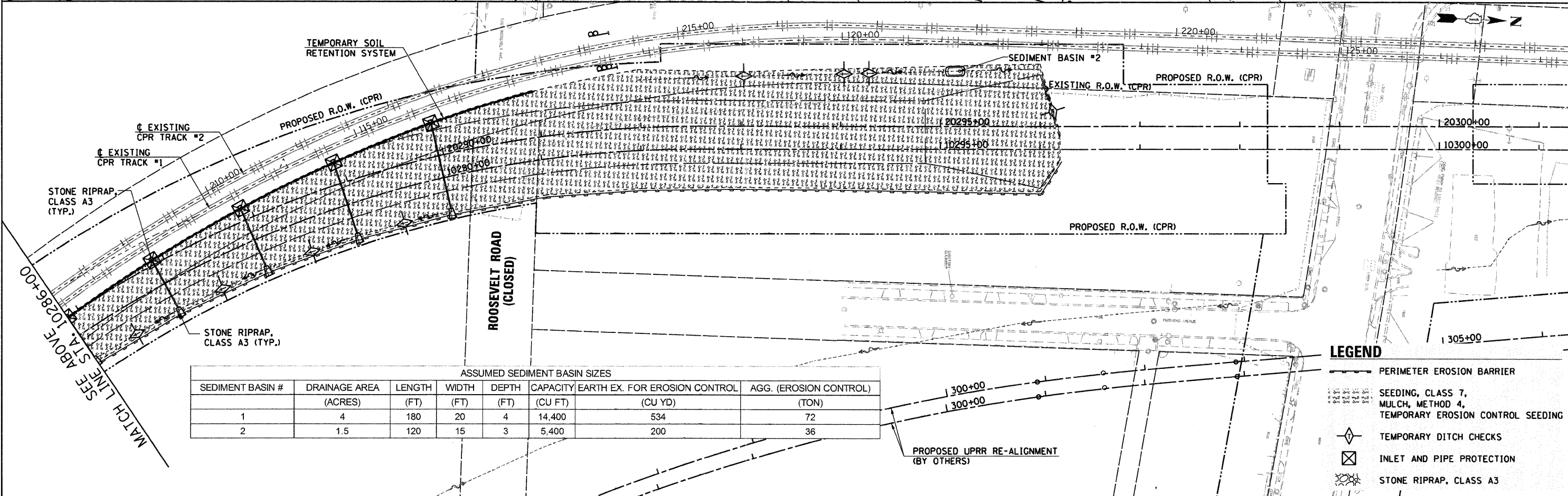

ASSUMED SEDIMENT BASIN SIZES

SEDIMENT BASIN #	DRAINAGE AREA (ACRES)	LENGTH (FT)	WIDTH (FT)	DEPTH (FT)	CAPACITY (CU FT)	EARTH EX. FOR EROSION CONTROL (CU YD)	AGG. (EROSION CONTROL) (TON)
1	4	180	20	4	14,400	534	72
2	1.5	120	15	3	5,400	200	36

- LEGEND**
- PERIMETER EROSION BARRIER
 - SEEDING, CLASS 7, MULCH, METHOD 4, TEMPORARY EROSION CONTROL SEEDING
 - TEMPORARY DITCH CHECKS
 - INLET AND PIPE PROTECTION
 - STONE RIPRAP, CLASS A3

FILE NAME = ...ND160N06-SHT-EROS-RR02.DGN

USER NAME = nroterm
 DESIGNED - JJS
 DRAWN - JJS
 CHECKED - LGP
 PLOT DATE = 3/25/2011
 REVISED -
 REVISED -
 REVISED -
 REVISED -

**STATE OF ILLINOIS
 DEPARTMENT OF TRANSPORTATION**

**EROSION CONTROL PLAN
 CANADIAN PACIFIC RAILWAY**

SCALE: 1"=50' SHEET NO. 2 OF 2 SHEETS STA. 10272+26.24 TO STA. 10298+00

F.A.U. RTE.	SECTION	COUNTY	TOTAL SHEETS	SHEET NO.
1321	2010-134-T	DUPAGE	40	15
CONTRACT NO. 60N06			ILLINOIS FED. AID PROJECT	