

150 140 130 120 110 100 90 80 70 60 50 40 30 20 10 0 10 20 30 40 50 60 70 80 90 100 110 120 130 140 150

NOTES:  
 1) UTILITIES NOT SHOWN ON CROSS SECTIONS.  
 SEE UTILITY PLANS FOR LOCATION OF EXISTING UTILITIES.  
 2) FOR DESIGN CLARITY NOT ALL PROPOSED FUTURE TRACKS  
 (BY OTHERS) ARE SHOWN.  
 3) CULVERT INLET AND OUTLET PROTECTION NOT SHOWN.  
 SEE EROSION CONTROL PLAN FOR DESIGN DETAILS.

DATE	
BY	
FINAL SURVEY	
REVIEWED	
PLOTTED	
TEMPLATE	
AREAS CHECKED	
NO.	

DATE	
BY	
ORIGINAL SURVEY	
REVIEWED	
PLOTTED	
TEMPLATE	
AREAS CHECKED	
NO.	

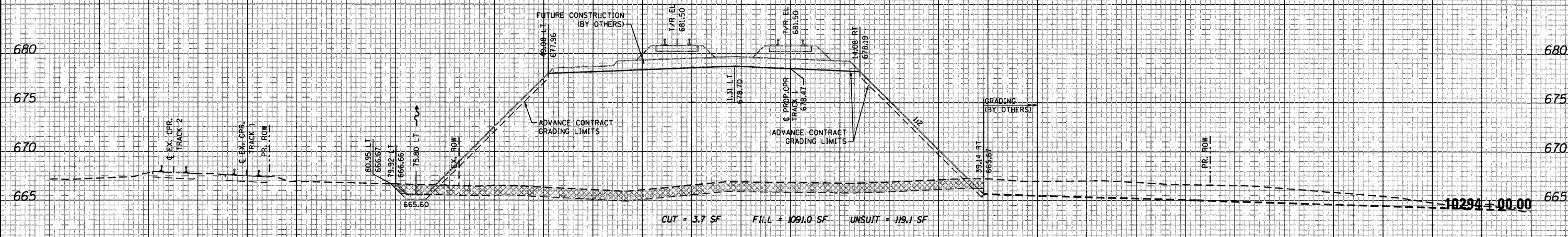
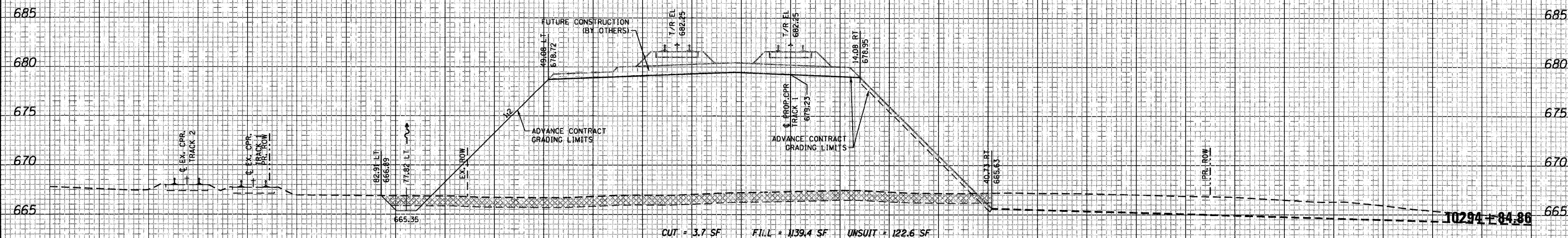

150 140 130 120 110 100 90 80 70 60 50 40 30 20 10 0 10 20 30 40 50 60 70 80 90 100 110 120 130 140 150

FILE NAME = ... \D150N06-SHT-XSC-R01.dgn

USER NAME = nmatern  
 DESIGNED - NMR  
 DRAWN - NMR  
 CHECKED - LGP  
 PLOT DATE = 3/25/2011

REVISED -  
 REVISED -  
 REVISED -  
 REVISED -

STATE OF ILLINOIS  
 DEPARTMENT OF TRANSPORTATION

CANADIAN PACIFIC RAILWAY CROSS SECTIONS  
 SCALE: SHEET NO. 8 OF 10 SHEETS STA. 10294+00.00 TO STA. 10294+84.86

F.A.U. RTE.	SECTION	COUNTY	TOTAL SHEETS	SHEET NO.
1321	2010-134-T	DUPAGE	40	38
CONTRACT NO. 60N06				
ILLINOIS FED. AID PROJECT				