

**LEGEND**

1. EXISTING COMBINATION CONCRETE CURB AND GUTTER
2. EXISTING P.C. CONCRETE BASE COURSE, ± 9"
3. EXISTING HMA SURFACE COURSE
4. EXISTING SAND CUSHION, 1"
5. EXISTING BRICK COURSE, 4"
6. EXISTING SUB-BASE GRANULAR MATERIAL, TYPE B, 4 1/2"
7. EXISTING CONCRETE CURB
8. EXISTING TOP SOIL AND SODDING, 4"
9. PROPOSED HMA SURFACE REMOVAL, 2 1/4"
10. PROPOSED POLYMERIZED LEVELING BINDER (MACHINE METHOD), IL-4.75, N50, 3/4"
11. PROPOSED HMA SURFACE COURSE, MIX "D", N70, 1 1/2"
12. PROPOSED AGGREGATE WEDGE SHOULDER, TYPE B (WHERE NECESSARY)
13. PROPOSED GRADING AND SHAPING SHOULDERS (WHERE NECESSARY)

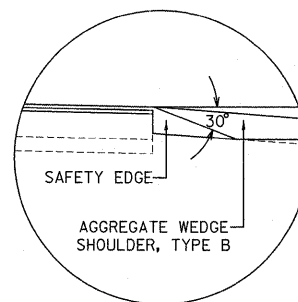

SAFETY EDGE DETAIL

**NOTE**

THE CONTRACTOR SHALL PATCH FIRST BEFORE MILLING  
 \* USE SAFETY EDGE DETAIL WHEN HMA SHOULDER IS 1' OR LESS (WHERE NECESSARY)

HOT-MIX ASPHALT MIXTURE REQUIREMENTS	
MIXTURE TYPE	AIR VOIDS(%)
<b>PAVEMENT RESURFACING</b>	
HMA SURFACE COURSE, MIX "D", N70 (IL-9.5 MM)	4% @ 70 GYR.
POLYMERIZED LEVELING BINDER COURSE (MM), IL-4.75, N50	4% @ 50 GYR.
<b>PATCHING</b>	
CLASS D PATCHES (HMA BINDER IL-25 mm)	4% @ 70 GYR.
HMA REPLACEMENT OVER PATCHES (HMA BINDER IL-19 mm)	4% @ 70 GYR.

NOTE 1: THE UNIT WEIGHT USED TO CALCULATE ALL HOT-MIX ASPHALT SURFACE MIXTURE QUANTITIES IS 112 LBS/SQ YD/IN.

NOTE 2: THE "AC TYPE" FOR POLYMERIZED HMA MIXES SHALL BE "SBS/SBR PG 70 -22 AND FOR NON-POLYMERIZED HMA THE "AC TYPE" SHALL BE "PG 64 -22" UNLESS MODIFIED BY DISTRICT ONE SPECIAL PROVISIONS.

FOR "PERCENT OF RAP" SEE DISTRICT ONE SPECIAL PROVISIONS.

FILE NAME =	USER NAME = qureshiga	DESIGNED -	REVISED -	<b>STATE OF ILLINOIS DEPARTMENT OF TRANSPORTATION</b>	<b>IL. ROUTE 25 EXISTING &amp; PROPOSED TYPICAL SECTIONS</b>			F.A.U. RTE. 2503	SECTION 2010-151-RS	COUNTY KANE	TOTAL SHEETS 20	SHEET NO. 4
cr:\pwork\pwork\qureshiga\d252940\DI3511-ah-t-plen.dgn	PLT SCALE = 50.0000' / IN.	DRAWN -	REVISED -		SCALE:	SHEET NO. OF SHEETS	STA. TO STA.	CONTRACT NO. 60N35				
	PLT DATE = 5/6/2011	CHECKED -	REVISED -		Rev. 6-9-11							
		DATE -	REVISED -		FED. ROAD DIST. NO. 1 ILLINOIS FED. AID PROJECT							

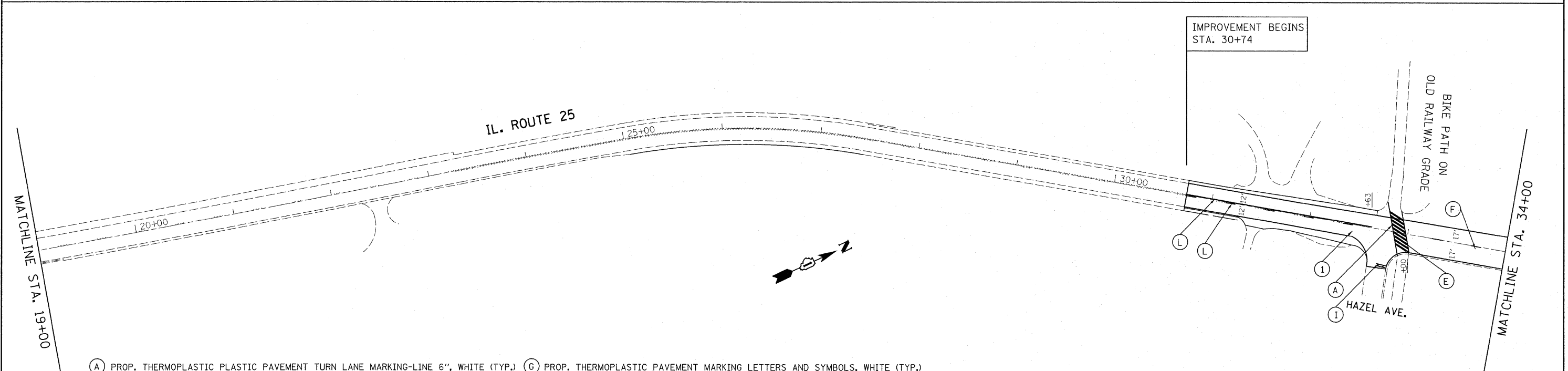
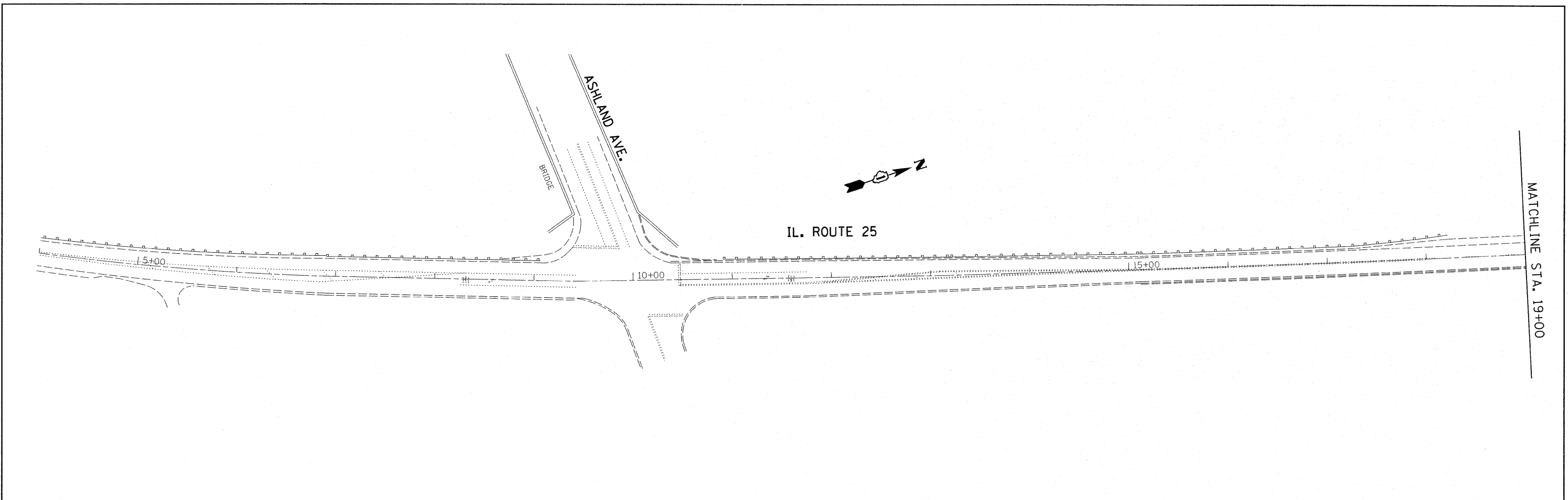

- (A) PROP. THERMOPLASTIC PLASTIC PAVEMENT TURN LANE MARKING-LINE 6", WHITE (TYP.)
- (B) PROP. THERMOPLASTIC PAVEMENT MARKING-LINE 4", WHITE (TYP.)
- (C) PROP. THERMOPLASTIC PAVEMENT MARKING-LINE 4", YELLOW (TYP.)
- (D) PROP. THERMOPLASTIC PAVEMENT MARKING-LINE 8", WHITE (TYP.)
- (E) PROP. THERMOPLASTIC PAVEMENT MARKING-LINE 12", WHITE (TYP.)
- (F) PROP. THERMOPLASTIC PAVEMENT MARKING-LINE 4", 10' DASH-30' SKIP, WHITE (TYP.)
- (G) PROP. THERMOPLASTIC PAVEMENT MARKING LETTERS AND SYMBOLS, WHITE (TYP.)
- (H) PROP. THERMOPLASTIC PAVEMENT MARKING-LINE 6", 2' DASH-6' SKIP, WHITE (TYP.)
- (I) PROP. THERMOPLASTIC PAVEMENT STOP MARKING-LINE 24", WHITE (TYP.)
- (J) PROP. THERMOPLASTIC PAVEMENT CROSSWALK MARKING-LINE 6", 2 @ 6' SPACE, WHITE (TYP.)
- (K) PROP. THERMOPLASTIC PAVEMENT MARKING DOUBLE LINES 4" @ 11" C-C, YELLOW (TYP.)
- (L) PROP. THERMOPLASTIC PAVEMENT SOLID AND SKIP-DASH MARKING-LINES 4" @ 5 1/2" C-C, YELLOW (TYP.)

- (1) PROP. HOT MIX ASPHALT SURFACE REMOVAL, 2 1/4"  
PROP. HMA SURFACE COURSE, MIX "D", N70, 1 1/2"  
PROP. POLYMERIZED LEVELING BINDER COURSE (MACHINE METHOD), IL-4.75, N50, 3/4"
- STREET PARKING

FILE NAME =  
c:\p\work\p\dot\qureshyo\d0252940\0130511-sht-plan.dgn

USER NAME = qureshyo  
DESIGNED -  
DRAWN -  
CHECKED -  
PLOT DATE = 4/16/2011

DESIGNED -  
DRAWN -  
CHECKED -  
DATE -

REVISED -  
REVISED -  
REVISED -  
REVISED -

**STATE OF ILLINOIS  
DEPARTMENT OF TRANSPORTATION**

**IL. ROUTE 25  
ROADWAY PLAN**

SCALE: SHEET NO. OF SHEETS STA. TO STA.

F.A.U. RTE.	SECTION	COUNTY	TOTAL SHEETS	SHEET NO.
2503	2010-151-RS	KANE	20	6
CONTRACT NO. 60N35				
ILLINOIS FED. AID PROJECT				

Rev 6-9-11

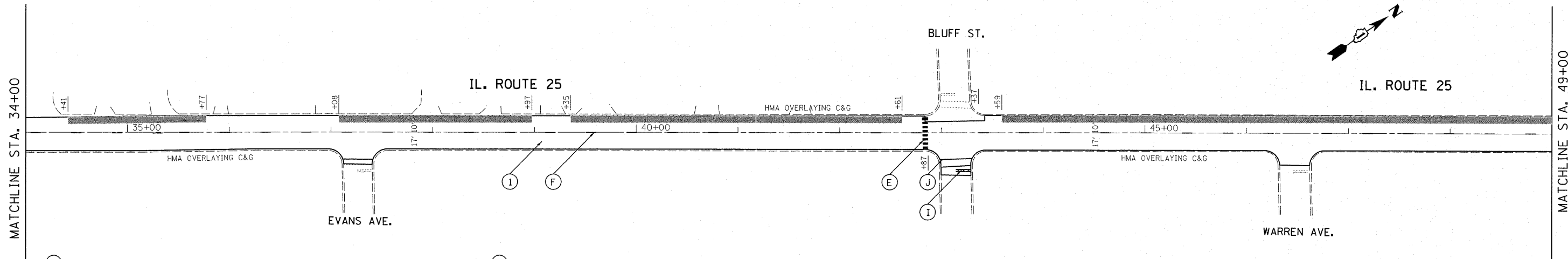

- (A) PROP. THERMOPLASTIC PLASTIC PAVEMENT TURN LANE MARKING-LINE 6", WHITE (TYP.)
- (B) PROP. THERMOPLASTIC PAVEMENT MARKING-LINE 4", WHITE (TYP.)
- (C) PROP. THERMOPLASTIC PAVEMENT MARKING-LINE 4", YELLOW (TYP.)
- (D) PROP. THERMOPLASTIC PAVEMENT MARKING-LINE 8", WHITE (TYP.)
- (E) PROP. THERMOPLASTIC PAVEMENT MARKING-LINE 12", WHITE (TYP.)
- (F) PROP. THERMOPLASTIC PAVEMENT MARKING-LINE 4", 10' DASH-30' SKIP, WHITE (TYP.)
- (G) PROP. THERMOPLASTIC PAVEMENT MARKING LETTERS AND SYMBOLS, WHITE (TYP.)
- (H) PROP. THERMOPLASTIC PAVEMENT MARKING-LINE 6", 2' DASH-6' SKIP, WHITE (TYP.)
- (I) PROP. THERMOPLASTIC PAVEMENT STOP MARKING-LINE 24", WHITE (TYP.)
- (J) PROP. THERMOPLASTIC PAVEMENT CROSSWALK MARKING-LINE 6", 2 @ 6' SPACE, WHITE (TYP.)
- (K) PROP. THERMOPLASTIC PAVEMENT MARKING DOUBLE LINES 4" @ 11" C-C, YELLOW (TYP.)
- (L) PROP. THERMOPLASTIC PAVEMENT SOLID AND SKIP-DASH MARKING-LINES 4" @ 5 1/2" C-C, YELLOW (TYP.)

① PROP. HOT-MIX ASPHALT SURFACE REMOVAL, 2 1/4"  
 PROP. HMA SURFACE COURSE, MIX "D", N70, 1 1/2"  
 PROP. POLYMERIZED LEVELING BINDER COURSE (MACHINE METHOD), IL-4.75, N50, 3/4"

■ STREET PARKING

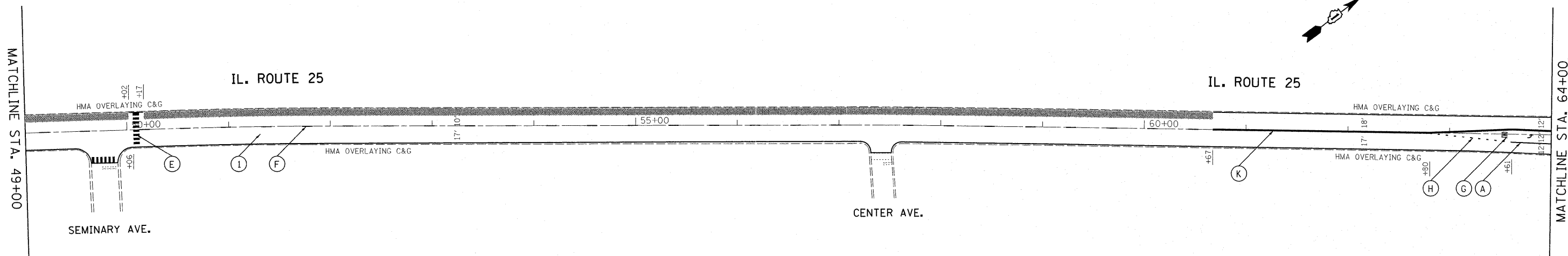

- (A) PROP. THERMOPLASTIC PLASTIC PAVEMENT TURN LANE MARKING-LINE 6", WHITE (TYP.)
- (B) PROP. THERMOPLASTIC PAVEMENT MARKING-LINE 4", WHITE (TYP.)
- (C) PROP. THERMOPLASTIC PAVEMENT MARKING-LINE 4", YELLOW (TYP.)
- (D) PROP. THERMOPLASTIC PAVEMENT MARKING-LINE 8", WHITE (TYP.)
- (E) PROP. THERMOPLASTIC PAVEMENT MARKING-LINE 12", WHITE (TYP.)
- (F) PROP. THERMOPLASTIC PAVEMENT MARKING-LINE 4", 10' DASH-30' SKIP, WHITE (TYP.)
- (G) PROP. THERMOPLASTIC PAVEMENT MARKING LETTERS AND SYMBOLS, WHITE (TYP.)
- (H) PROP. THERMOPLASTIC PAVEMENT MARKING-LINE 6", 2' DASH-6' SKIP, WHITE (TYP.)
- (I) PROP. THERMOPLASTIC PAVEMENT STOP MARKING-LINE 24", WHITE (TYP.)
- (J) PROP. THERMOPLASTIC PAVEMENT CROSSWALK MARKING-LINE 6", 2 @ 6' SPACE, WHITE (TYP.)
- (K) PROP. THERMOPLASTIC PAVEMENT MARKING DOUBLE LINES 4" @ 11" C-C, YELLOW (TYP.)
- (L) PROP. THERMOPLASTIC PAVEMENT SOLID AND SKIP-DASH MARKING-LINES 4" @ 5 1/2" C-C, YELLOW (TYP.)

① PROP. HOT-MIX ASPHALT SURFACE REMOVAL, 2 1/4"  
 PROP. HMA SURFACE COURSE, MIX "D", N70, 1 1/2"  
 PROP. POLYMERIZED LEVELING BINDER COURSE (MACHINE METHOD), IL-4.75, N50, 3/4"

■ STREET PARKING

FILE NAME =	USER NAME = qureshiya	DESIGNED -	REVISED -	<b>STATE OF ILLINOIS DEPARTMENT OF TRANSPORTATION</b>	<b>IL. ROUTE 25 ROADWAY PLAN</b>	F.A.U. RTE. 2503	SECTION 2010-151-R5	COUNTY KANE	TOTAL SHEETS 20	SHEET NO. 7	
CONTRACT NO. 60N35	PLOT SCALE = 50.0000' / IN.		CHECKED -		REVISED -	SCALE:	SHEET NO. OF SHEETS	STA. TO STA.	ILLINOIS FED. AID PROJECT		
	PLOT DATE = 4/16/2011		DATE -		REVISED -						

Rev. 6-9-11

- ① PROP. HOT-MIX ASPHALT SURFACE REMOVAL, 2 1/4"
- PROP. HMA SURFACE COURSE, MIX "D", N70, 1 1/2"
- PROP. POLYMERIZED LEVELING BINDER COURSE (MACHINE METHOD), IL-4.75, N50, 3/4"

STREET PARKING

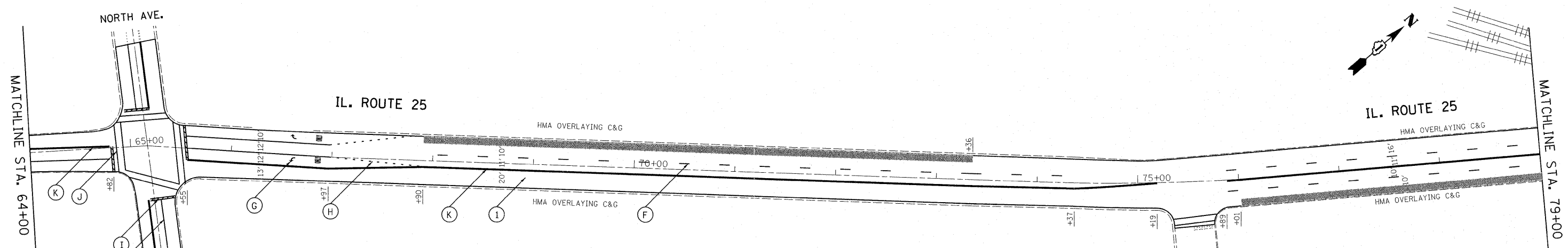

- ① PROP. THERMOPLASTIC PLASTIC PAVEMENT TURN LANE MARKING-LINE 6", WHITE (TYP.)
- ② PROP. THERMOPLASTIC PAVEMENT MARKING-LINE 4", WHITE (TYP.)
- ③ PROP. THERMOPLASTIC PAVEMENT MARKING-LINE 4", YELLOW (TYP.)
- ④ PROP. THERMOPLASTIC PAVEMENT MARKING-LINE 8", WHITE (TYP.)
- ⑤ PROP. THERMOPLASTIC PAVEMENT MARKING-LINE 12", WHITE (TYP.)
- ⑥ PROP. THERMOPLASTIC PAVEMENT MARKING-LINE 4", 10' DASH-30' SKIP, WHITE (TYP.)
- ⑦ PROP. THERMOPLASTIC PAVEMENT MARKING LETTERS AND SYMBOLS, WHITE (TYP.)
- ⑧ PROP. THERMOPLASTIC PAVEMENT MARKING-LINE 6", 2' DASH-6' SKIP, WHITE (TYP.)
- ⑨ PROP. THERMOPLASTIC PAVEMENT STOP MARKING-LINE 24", WHITE (TYP.)
- ⑩ PROP. THERMOPLASTIC PAVEMENT CROSSWALK MARKING-LINE 6", 2 @ 6' SPACE, WHITE (TYP.)
- ⑪ PROP. THERMOPLASTIC PAVEMENT MARKING DOUBLE LINES 4" @ 11" C-C, YELLOW (TYP.)
- ⑫ PROP. THERMOPLASTIC PAVEMENT SOLID AND SKIP-DASH MARKING-LINES 4" @ 5 1/2" C-C, YELLOW (TYP.)

- ① PROP. HOT-MIX ASPHALT SURFACE REMOVAL, 2 1/4"
- PROP. HMA SURFACE COURSE, MIX "D", N70, 1 1/2"
- PROP. POLYMERIZED LEVELING BINDER COURSE (MACHINE METHOD), IL-4.75, N50, 3/4"

STREET PARKING

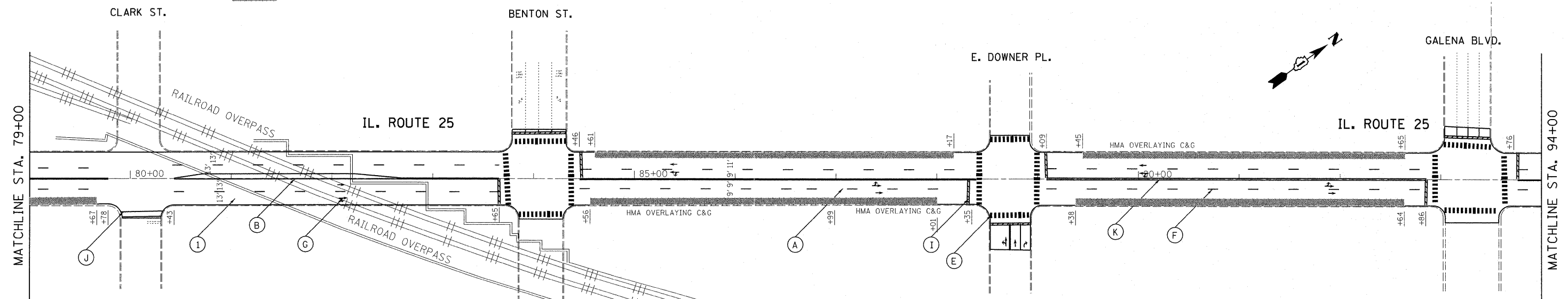

- ① PROP. THERMOPLASTIC PLASTIC PAVEMENT TURN LANE MARKING-LINE 6", WHITE (TYP.)
- ② PROP. THERMOPLASTIC PAVEMENT MARKING-LINE 4", WHITE (TYP.)
- ③ PROP. THERMOPLASTIC PAVEMENT MARKING-LINE 4", YELLOW (TYP.)
- ④ PROP. THERMOPLASTIC PAVEMENT MARKING-LINE 8", WHITE (TYP.)
- ⑤ PROP. THERMOPLASTIC PAVEMENT MARKING-LINE 12", WHITE (TYP.)
- ⑥ PROP. THERMOPLASTIC PAVEMENT MARKING-LINE 4", 10' DASH-30' SKIP, WHITE (TYP.)
- ⑦ PROP. THERMOPLASTIC PAVEMENT MARKING LETTERS AND SYMBOLS, WHITE (TYP.)
- ⑧ PROP. THERMOPLASTIC PAVEMENT MARKING-LINE 6", 2' DASH-6' SKIP, WHITE (TYP.)
- ⑨ PROP. THERMOPLASTIC PAVEMENT STOP MARKING-LINE 24", WHITE (TYP.)
- ⑩ PROP. THERMOPLASTIC PAVEMENT CROSSWALK MARKING-LINE 6", 2 @ 6' SPACE, WHITE (TYP.)
- ⑪ PROP. THERMOPLASTIC PAVEMENT MARKING DOUBLE LINES 4" @ 11" C-C, YELLOW (TYP.)
- ⑫ PROP. THERMOPLASTIC PAVEMENT SOLID AND SKIP-DASH MARKING-LINES 4" @ 5 1/2" C-C, YELLOW (TYP.)

Rev. 6-9-11

FILE NAME =	USER NAME = qureshiya	DESIGNED -	REVISED -	<b>STATE OF ILLINOIS DEPARTMENT OF TRANSPORTATION</b>	<b>IL. ROUTE 25 ROADWAY PLAN</b>			F.A.U. RTE.	SECTION	COUNTY	TOTAL SHEETS	SHEET NO.	
cr:\pw\work\p\dot\qureshiya\d0252940\013	0511-shr-plan.dgn	DRAWN -	REVISED -		SCALE:	SHEET NO.	OF	SHEETS	STA.	TO STA.	2503	20	8
	PLOT SCALE = 50.0000' / IN.	CHECKED -	REVISED -										
	PLOT DATE = 4/16/2011	DATE -	REVISED -										
											CONTRACT NO. 60N35		
											ILLINOIS FED. AID PROJECT		

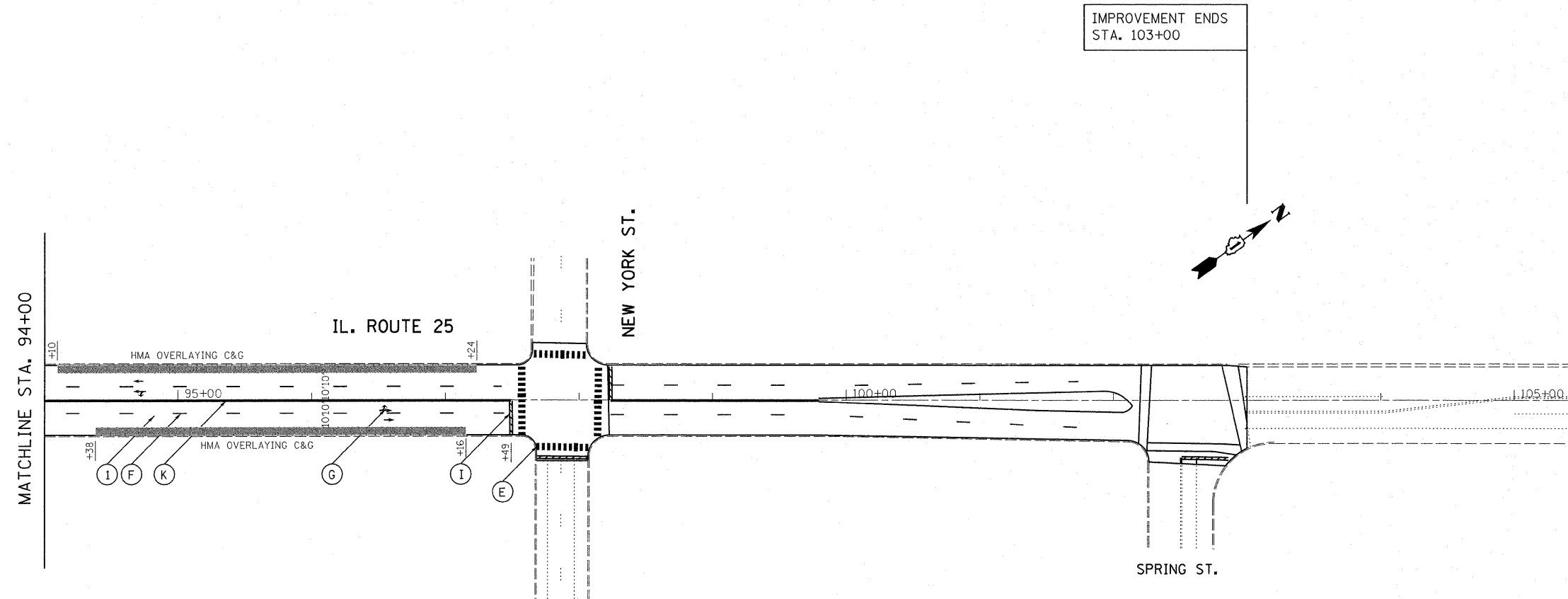

- (A) PROP. THERMOPLASTIC PLASTIC PAVEMENT TURN LANE MARKING-LINE 6", WHITE (TYP.)
- (B) PROP. THERMOPLASTIC PAVEMENT MARKING-LINE 4", WHITE (TYP.)
- (C) PROP. THERMOPLASTIC PAVEMENT MARKING-LINE 4", YELLOW (TYP.)
- (D) PROP. THERMOPLASTIC PAVEMENT MARKING-LINE 8", WHITE (TYP.)
- (E) PROP. THERMOPLASTIC PAVEMENT MARKING-LINE 12", WHITE (TYP.)
- (F) PROP. THERMOPLASTIC PAVEMENT MARKING-LINE 4", 10' DASH-30' SKIP, WHITE (TYP.)
- (G) PROP. THERMOPLASTIC PAVEMENT MARKING LETTERS AND SYMBOLS, WHITE (TYP.)
- (H) PROP. THERMOPLASTIC PAVEMENT MARKING-LINE 6", 2' DASH-6' SKIP, WHITE (TYP.)
- (I) PROP. THERMOPLASTIC PAVEMENT STOP MARKING-LINE 24", WHITE (TYP.)
- (J) PROP. THERMOPLASTIC PAVEMENT CROSSWALK MARKING-LINE 6", 2 @ 6' SPACE, WHITE (TYP.)
- (K) PROP. THERMOPLASTIC PAVEMENT MARKING DOUBLE LINES 4" @ 11" C-C, YELLOW (TYP.)
- (L) PROP. THERMOPLASTIC PAVEMENT SOLID AND SKIP-DASH MARKING-LINES 4" @ 5 1/2" C-C, YELLOW (TYP.)

- (1) PROP. HOT-MIX ASPHALT SURFACE REMOVAL, 2 1/4"  
PROP. HMA SURFACE COURSE, MIX "D", N70, 1 1/2"  
PROP. POLYMERIZED LEVELING BINDER COURSE (MACHINE METHOD), IL-4.75, N50, 3/4"

STREET PARKING

Rev. 6-9-11

FILE NAME =	USER NAME = qureshiga	DESIGNED -	REVISED -	<b>STATE OF ILLINOIS DEPARTMENT OF TRANSPORTATION</b>	<b>IL. ROUTE 25 ROADWAY PLAN</b>	F.A.U. RTE. 2503	SECTION 2010-151-RS	COUNTY KANE	TOTAL SHEETS 20	SHEET NO. 9	
es:\pwork\pwork\qureshiga\d0252940\0130511-sht-plan.dgn		DRAWN -	REVISED -		SCALE:      SHEET NO.      OF      SHEETS      STA.      TO STA.	CONTRACT NO. 60N35	ILLINOIS FED. AID PROJECT				
		CHECKED -	REVISED -								
		DATE -	REVISED -								