

- ① PROP. THERMOPLASTIC PVMT. MARKING 4", LINE, WHITE (TYP.)
- ② PROP. THERMOPLASTIC PVMT. MARKING 4", DOUBLE YELLOW (TYP.)
- ③ PROP. THERMOPLASTIC PVMT. MARKING 4", SKIP DASH, YELLOW (TYP.)
- ④ PROP. THERMOPLASTIC PVMT. MARKING 4", SKIP DASH, WHITE (TYP.)
- ⑤ PROP. THERMOPLASTIC PVMT. MARKING 6", TURN LANE, WHITE (TYP.)
- ⑥ PROP. THERMOPLASTIC PVMT. MARKING 6", CROSSWALK, WHITE (TYP.)
- ⑦ PROP. THERMOPLASTIC PVMT. MARKING 12", LONGITUDINAL BAR, WHITE (TYP.)
- ⑧ PROP. THERMOPLASTIC PVMT. MARKING 12", DIAGONALS, YELLOW (TYP.)
- ⑨ PROP. THERMOPLASTIC PVMT. MARKING 24", STOP BAR, WHITE (TYP.)

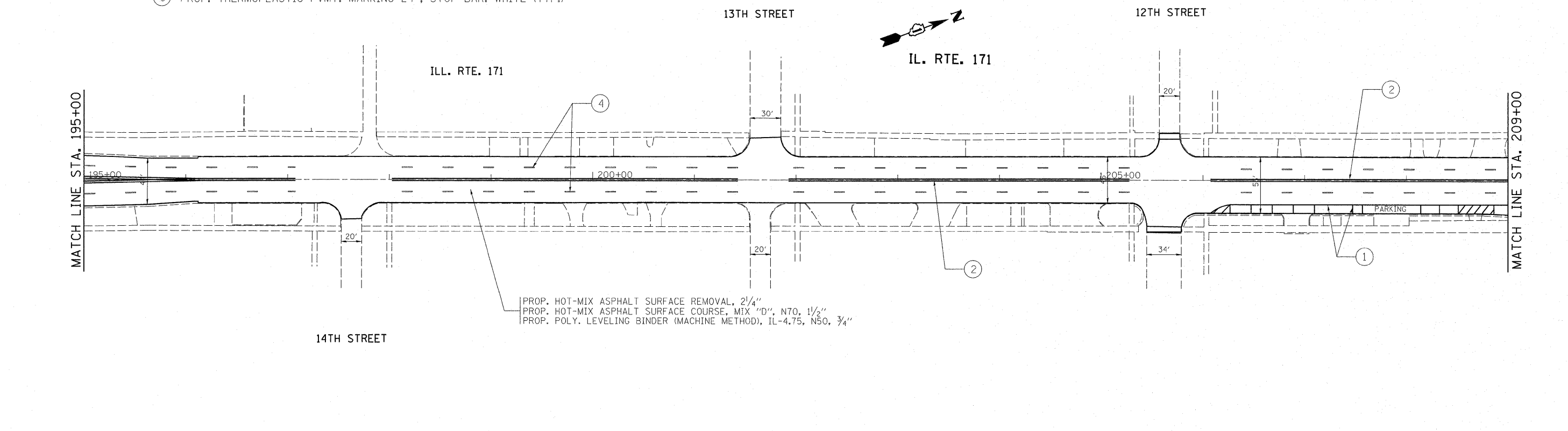

FILE NAME =	USER NAME = midyja	DESIGNED -	REVISED -	<b>STATE OF ILLINOIS DEPARTMENT OF TRANSPORTATION</b>	<b>ILL 171 ROADWAY AND PAVEMENT MARKING PLAN</b>			F.A.P. RTE. 577	SECTION D-RS-7	COUNTY WILL	TOTAL SHEETS 38	SHEET NO. 14
c:\pwork\pwork\midyja\0248692\013301-sh1-plan.dgn		DRAWN -	REVISED -		SCALE:	SHEET NO.	OF	SHEETS	STA.	TO STA.	ILLINOIS FED. AID PROJECT	
		CHECKED -	REVISED -								CONTRACT NO. 60N60	
		DATE -	REVISED -									