

**IMPROVEMENT BEGINS
STA.45 + 41.72
O/S = 25', LT.**

**IMPROVEMENT ENDS
STA.57 + 92.92
O/S = 84.70', LT.**

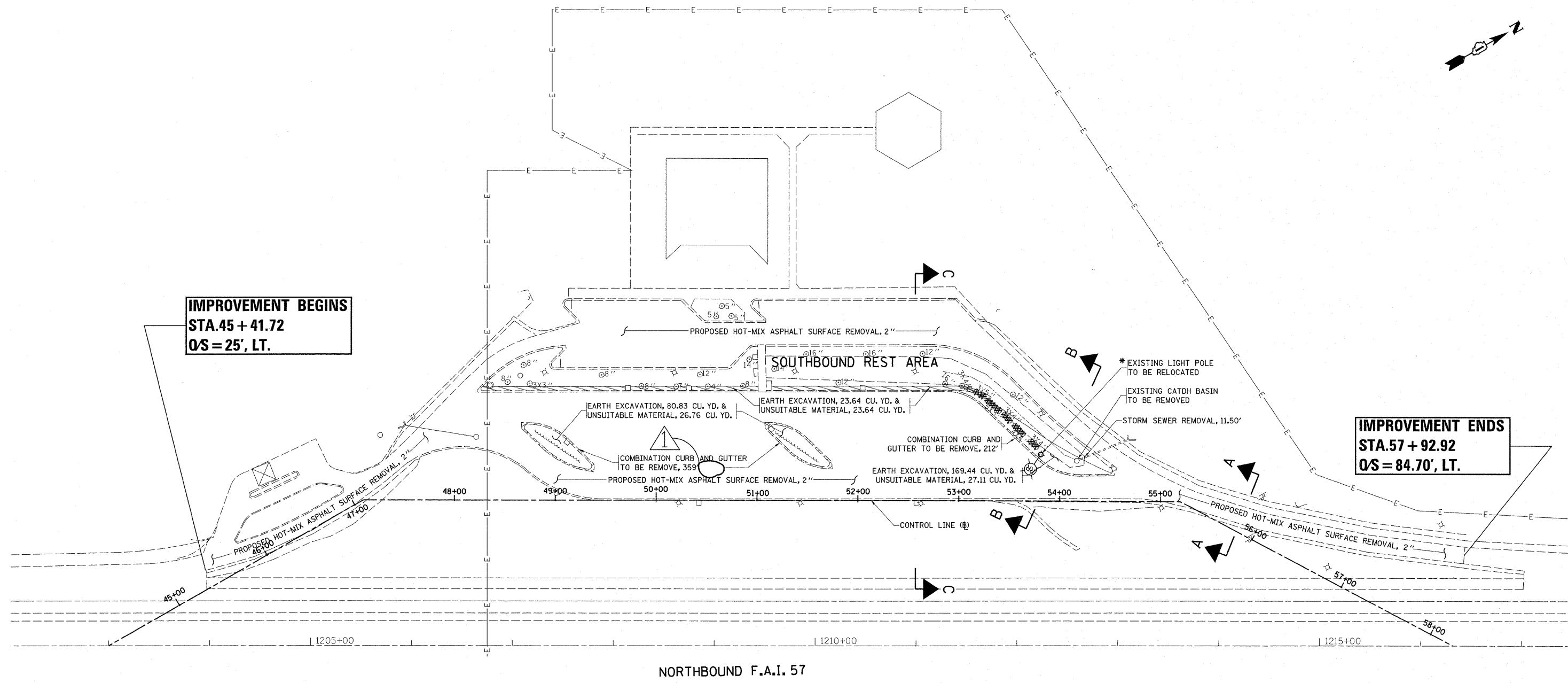

NORTHBOUND F.A.I. 57

* THE REMOVAL OF EXISTING LIGHT POLE FOUNDATION IS INCLUDED IN THE COST OF EARTH EXCAVATION.

REVISION SYMBOL: REVISED SHEET 6/10/11 AH

FILE NAME = c:\pv_work\pwsdot\hamdanah\d0264498\shp\plan.dgn	USER NAME = hamdanah	DESIGNED -	REVISED -	STATE OF ILLINOIS DEPARTMENT OF TRANSPORTATION	I-57 AT PRARIE VIEW REST AREA IN PEOTONE EXISTING PLAN (SOUTHBOUND REST AREA)	F.A.I. RTE. 57	SECTION 99-I-RA-WRS	COUNTY WILL	TOTAL SHEETS 14	SHEET NO. 7
	PLOT SCALE = 50.0000' / 1" =	CHECKED -	REVISED -			SCALE:	SHEET NO. 2 OF 2 SHEETS	STA. TO STA.	ILLINOIS FED. AID PROJECT	
PLOT DATE = 6/10/2011	DATE -	REVISED -	REVISED -	CONTRACT NO. 60P08						