

SUMMARY OF QUANTITIES			URBAN 100% STATE CONSTRUCTION TYPE CODE					SUMMARY OF QUANTITIES			URBAN 100% STATE CONSTRUCTION TYPE CODE								
CODE NO	ITEM	UNIT	TOTAL QUANTITIES	South Bound I-57	North Bound I-57					CODE NO	ITEM	UNIT	TOTAL QUANTITIES	South Bound I-57	North Bound I-57				
				0005	0005									0005	0005				
20200100	EARTH EXCAVATION	CU YD	1209.43	632.91	576.52					70300260	TEMPORARY PAVEMENT MARKING - LINE 12"	FOOT	560	280	280				
20201200	REMOVAL AND DISPOSAL OF UNSUITABLE MATERIAL	CU YD	308.8	77.51	231.29					78000100	THERMOPLASTIC PAVEMENT MARKING - LETTERS AND SYMBOLS	SQ FT	124	62	62				
21101615	TOPSOIL FURNISH AND PLACE, 4"	SQ YD	148.1	74.6	73.5					78000200	THERMOPLASTIC PAVEMENT MARKING - LINE 4"	FOOT	13448	6724	6724				
25200110	SODDING, SALT TOLERANT	SQ YD	148.1	74.6	73.5					78000400	THERMOPLASTIC PAVEMENT MARKING - LINE 6"	FOOT	88	44	44				
25000310	SEEDING, CLASS 4	ACRE	0.3		0.3					78000500	THERMOPLASTIC PAVEMENT MARKING - LINE 8"	FOOT	180	90	90				
40600200	BITUMINOUS MATERIALS (PRIME COAT)	TON	19	9	10					78000600	THERMOPLASTIC PAVEMENT MARKING - LINE 12"	FOOT	1576	788	788				
25100630	EROSION CONTROL BLANKET	SQ YD	1467		1467					81603090	UNIT DUCT, 600V, 3-1C NO. 4, 1/C NO. 6 GROUND, (XLP-TYPE USE), 1 1/4" DIA. POLYETHYLENE	FOOT	50	50					
40600300	AGGREGATE (PRIME COAT)	TON	94	46	48					81900200	TRENCH AND BACKFILL FOR ELECTRICAL WORK	FOOT	300	300					
40600400	MIXTURE FOR CRACKS, JOINTS, AND FLANGEWAYS	TON	35	17	18					83600200	LIGHT POLE FOUNDATION, 24" DIAMETER	FOOT	10	10					
40600895	CONSTRUCTING TEST STRIP	EACH	1	0.5	0.5					84400105	RELOCATE EXISTING LIGHTING UNIT	EACH	1	1					
40600982	HOT-MIX ASPHALT SURFACE REMOVAL - BUTT JOINT	SQ YD	55	28	27					X0322919	CLEAN EXISTING STRUCTURES	EACH	4	2	2				
40603085	HOT-MIX ASPHALT BINDER COURSE, 1 1/2" 19.0, N70	TON	2204	1102	1102					X2020110	GRADING AND SHAPING SHOULDERS	UNIT	26	11	15				
40603340	HOT-MIX ASPHALT SURFACE COURSE, MIX "D", N70	TON	3367	1658	1709					X5539700	STORM SEWERS TO BE CLEANED	FOOT	150	75	75				
40701901	HOT-MIX ASPHALT PAVEMENT (FULL-DEPTH) 11"	SQ YD	1035	556	479					X7011015	TRAFFIC CONTROL AND PROTECTION (EXPRESSWAYS)	L SUM	1	0.5	0.5				
42001300	PROTECTIVE COAT	SQ YD	282	141	141					Z0001050	AGGREGATE SUBGRADE 12"	SQ YD	4246	2123	2123				
42400100	PORTLAND CEMENT CONCRETE SIDEWALK, 4"	SQ FT	600	300	300					Z0013798	CONSTRUCTION LAYOUT	L SUM	1	0.5	0.5				
44000157	HOT-MIX ASPHALT SURFACE REMOVAL, 2"	SQ YD	23277	11097	12180					31101816	SUB-BASE GRANULAR MATERIAL, TYPE B 13 1/2"	SQ YD	56.88	28.44	28.44				
44000500	COMBINATION CURB AND GUTTER REMOVAL	FOOT	1733	871	862					Z0033028	MAINTENANCE OF LIGHTING SYSTEM	CAL MO	3	3					
44000600	SIDEWALK REMOVAL	SQ FT	600	300	300					81603035	UNIT DUCT 600V, 2-1C NO. 6, 1/C NO. 6 GROUND, (XLP-TYPE USE), 1" DIA POLYETHYLENE	FOOT	300	300					
44004250	PAVED SHOULDER REMOVAL	SQ YD	563		563														
44201753	CLASS D PATCHES, TYPE II, 9 INCH	SQ YD	704.28	342.99	361.29														
44201757	CLASS D PATCHES, TYPE III, 9 INCH	SQ YD	704.28	342.99	361.29														
44201759	CLASS D PATCHES, TYPE IV, 9 INCH	SQ YD	1939	957	981														
48102100	AGGREGATE WEDGE SHOULDER, TYPE B	TON	47	20	27														
48101200	AGGREGATE SHOULDERS, TYPE B	TON	172	73	99														
48203029	HOT-MIX ASPHALT SHOULDERS, 8"	SQ YD	427.5	212.73	214.77														
550A0070	STORM SEWERS, CLASS A, TYPE 1 15"	FOOT	9		9														
55100700	STORM SEWER REMOVAL 15"	FOOT	11.5	11.5															
60207605	CATCH BASINS, TYPE C, TYPE B GRATE	EACH	2	1	1														
60250500	CATCH BASINS TO BE ADJUSTED WITH NEW TYPE 1 FRAME, CLOSED LID	EACH	1		1														
60300105	FRAMES AND GRATES TO BE ADJUSTED	EACH	3	1	2														
60404300	FRAMES AND GRATES, TYPE 3	EACH	1	1															
60500050	REMOVING CATCH BASINS	EACH	2	1	1														
60603800	COMBINATION CONCRETE CURB AND GUTTER, TYPE B-6.12	FOOT	1113	563	550														
60618300	CONCRETE MEDIAN SURFACE, 4 INCH	SQ FT	512	256	256														
67100100	MOBILIZATION	L SUM	1	0.5	0.5														
67000400	ENGINEER'S FIELD OFFICE	CAL MO	4	2	2														
70300220	TEMPORARY PAVEMENT MARKING - LINE 4"	FOOT	13117	6371	6746														

• SPECIALTY ITEMS

Rev.

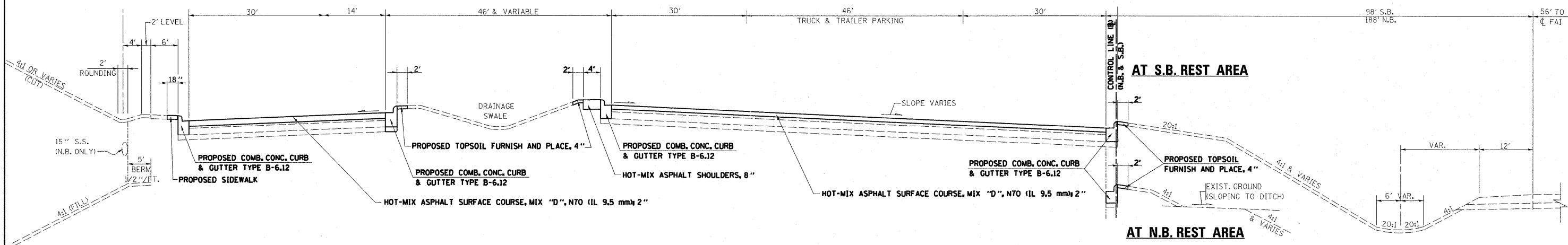

SECTION C-C

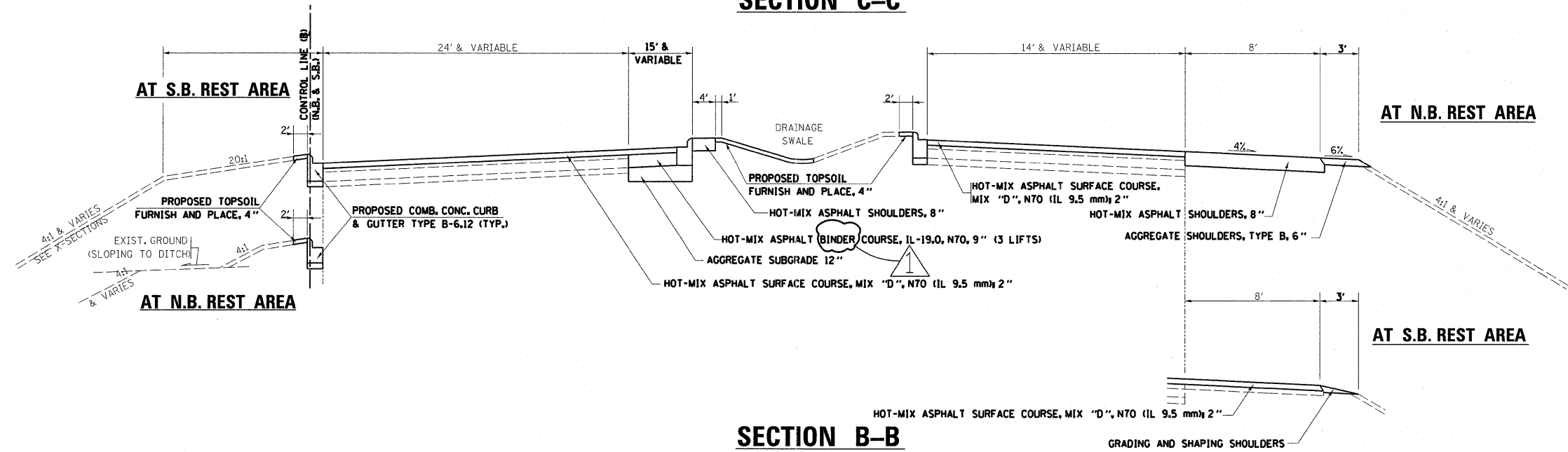

SECTION B-B

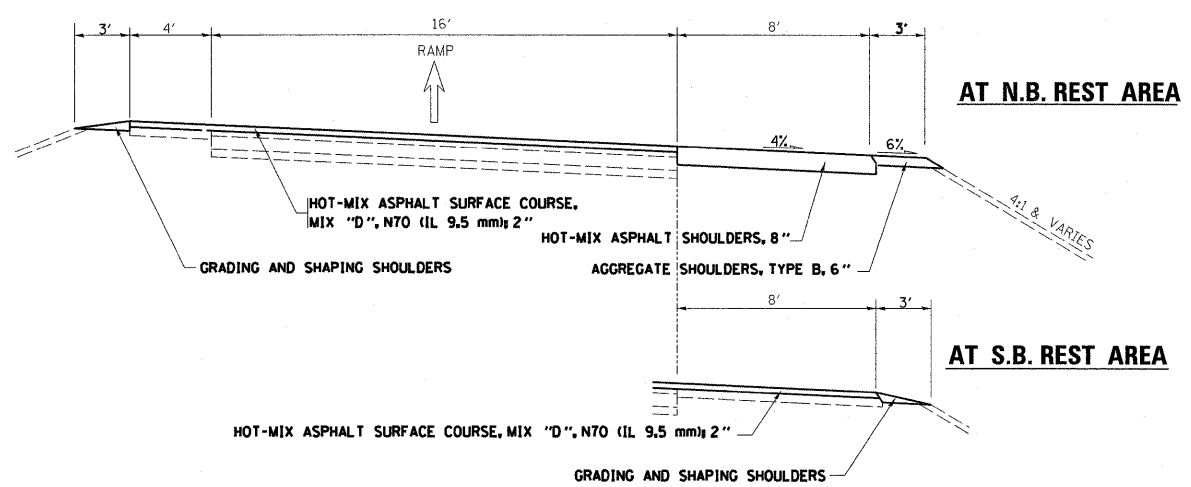

SECTION A-A

REVISD SHEET 6/10/11 AH

FILE NAME =	USER NAME = hmdanesh	DESIGNED -	REVISED -
cr:\pw_work\pwsdot\hmdanesh\d0264490\sh...	pln.dgn	DRAWN -	REVISED -
PLOT SCALE = 50.0000' / 1"	CHECKED -	REVISED -	REVISED -
PLOT DATE = 6/10/2011	DATE -	REVISED -	REVISED -

**STATE OF ILLINOIS
DEPARTMENT OF TRANSPORTATION**

**I-57 AT PRARIE VIEW REST AREA IN PEOTONE
PROPOSED CROSS SECTION**

SCALE: SHEET NO. 1 OF 1 SHEETS STA. TO STA.

F.A.I. RTE.	SECTION	COUNTY	TOTAL SHEETS	SHEET NO.
57	99-I-RA-WRS	WILL	14	5
CONTRACT NO. 60P08				
ILLINOIS FED. AID PROJECT				

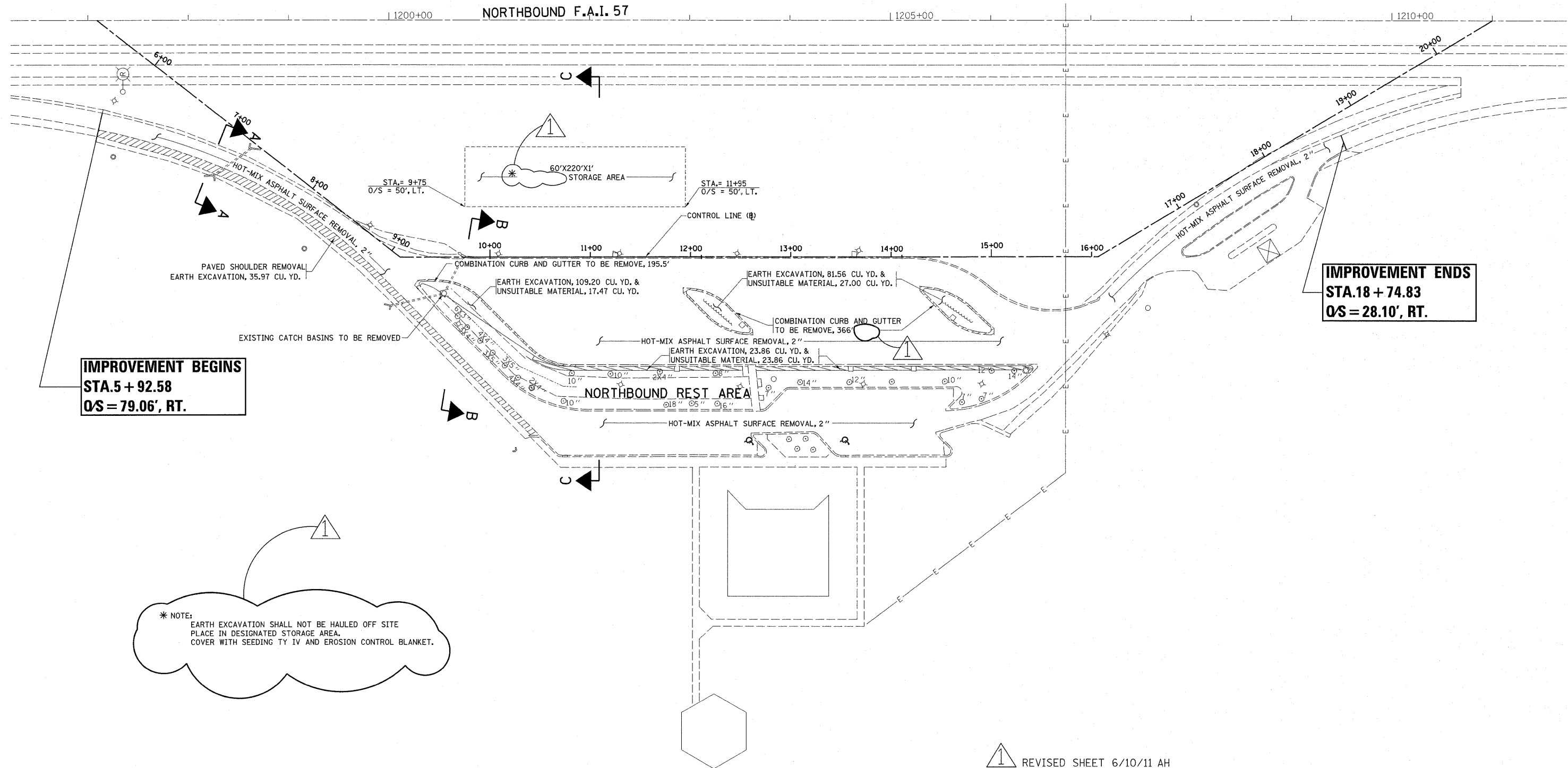
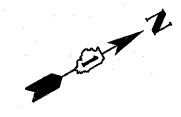

IMPROVEMENT BEGINS
STA. 5 + 92.58
OS = 79.06', RT.

IMPROVEMENT ENDS
STA. 18 + 74.83
OS = 28.10', RT.

* NOTE:
 EARTH EXCAVATION SHALL NOT BE HAULED OFF SITE
 PLACE IN DESIGNATED STORAGE AREA.
 COVER WITH SEEDING TY IV AND EROSION CONTROL BLANKET.

REVISION SYMBOL: REVISED SHEET 6/10/11 AH

FILE NAME =	USER NAME = hamdanah	DESIGNED -	REVISED -	STATE OF ILLINOIS DEPARTMENT OF TRANSPORTATION	I-57 AT PRARIE VIEW REST AREA IN PEOTONE EXISTING PLAN (NORTHBOUND REST AREA)			F.A.I. RTE.	SECTION	COUNTY	TOTAL SHEETS	SHEET NO.
es:\pw_work\pwsdot\hamdanah\d0264490\shp\plan.dgn	PLANT SCALE = 50.0000' / 1" =	DRAWN -	REVISED -		57	99-I-RA-WRS	WILL	14	6			
PLANT DATE = 6/10/2011	DATE -	CHECKED -	REVISED -		CONTRACT NO. 60P08							
					ILLINOIS FED. AID PROJECT							

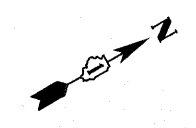

**IMPROVEMENT BEGINS
STA.45 + 41.72
O/S = 25', LT.**

**IMPROVEMENT ENDS
STA.57 + 92.92
O/S = 84.70', LT.**

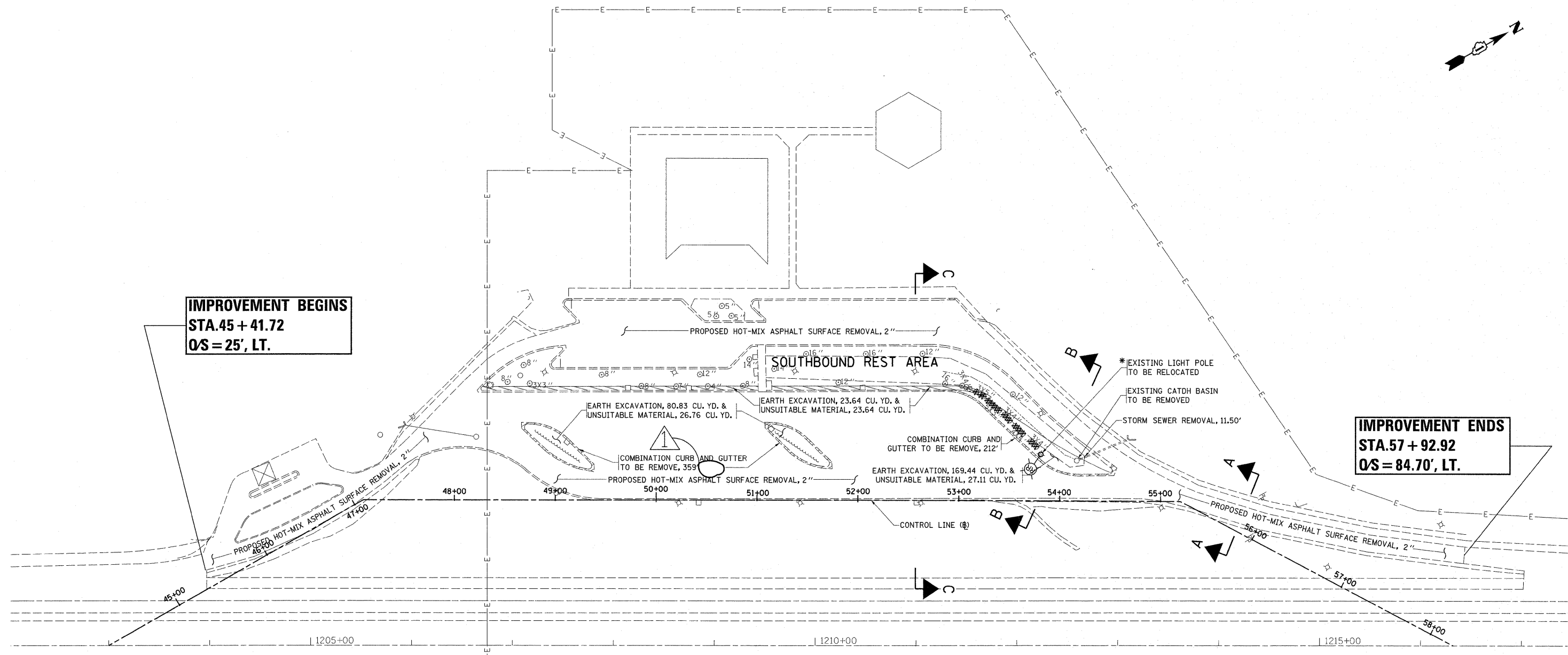

NORTHBOUND F.A.I. 57

* THE REMOVAL OF EXISTING LIGHT POLE FOUNDATION IS INCLUDED IN THE COST OF EARTH EXCAVATION.

REVISOR SYMBOL (triangle with '1') REVISED SHEET 6/10/11 AH

FILE NAME =	USER NAME = hamdanah	DESIGNED -	REVISED -	STATE OF ILLINOIS DEPARTMENT OF TRANSPORTATION	I-57 AT PRARIE VIEW REST AREA IN PEOTONE EXISTING PLAN (SOUTHBOUND REST AREA)	F.A.I. RTE.	SECTION	COUNTY	TOTAL SHEETS	SHEET NO.	
et:\pv_work\pwsdot\hamdanah\d0264498\shp\plan.dgn	PLOT SCALE = 50.0000' / 1" =	DRAWN -	REVISED -			57	99-I-RA-WRS	WILL	14	7	
PLOT DATE = 6/10/2011	DATE -	CHECKED -	REVISED -			CONTRACT NO. 60P08					
						ILLINOIS FED. AID PROJECT					

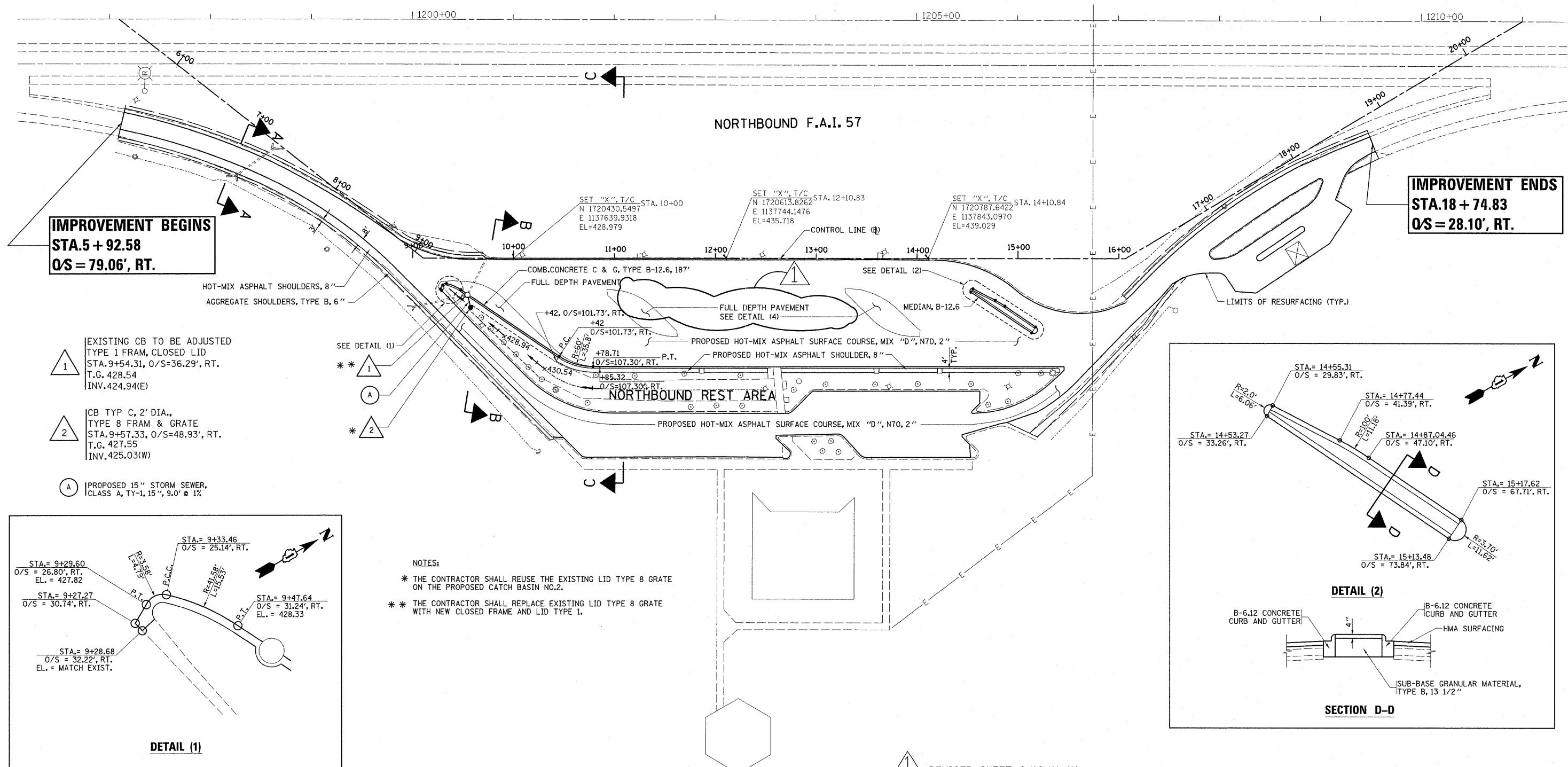
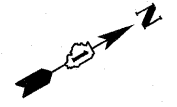

IMPROVEMENT BEGINS
STA. 5 + 92.58
O/S = 79.06', RT.

IMPROVEMENT ENDS
STA. 18 + 74.83
O/S = 28.10', RT.

- 1 EXISTING CB TO BE ADJUSTED
 TYPE 1 FRAM, CLOSED LID
 STA. 9+54.31, O/S=36.29', RT.
 T.G. 428.54
 INV. 424.94(E)
- 2 CB TYP C, 2' DIA.,
 TYPE 8 FRAM & GRATE
 STA. 9+57.33, O/S=48.93', RT.
 T.G. 427.55
 INV. 425.03(W)
- A PROPOSED 15" STORM SEWER,
 CLASS A, TY-1, 15", 9.0' @ 1%

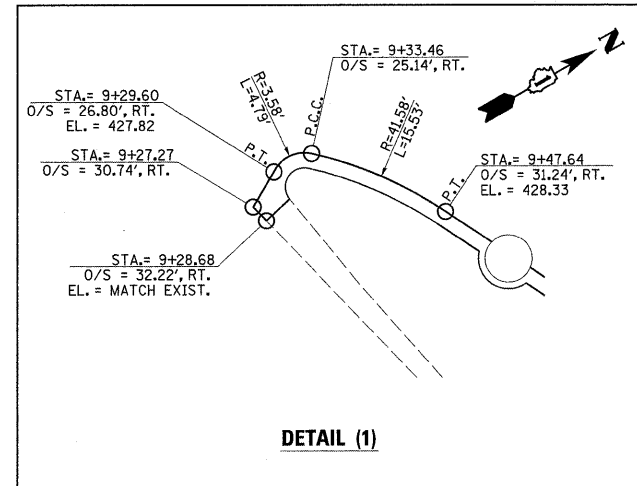

DETAIL (1)

- NOTES:**
- * THE CONTRACTOR SHALL REUSE THE EXISTING LID TYPE 8 GRATE ON THE PROPOSED CATCH BASIN NO.2.
 - * THE CONTRACTOR SHALL REPLACE EXISTING LID TYPE 8 GRATE WITH NEW CLOSED FRAME AND LID TYPE 1.

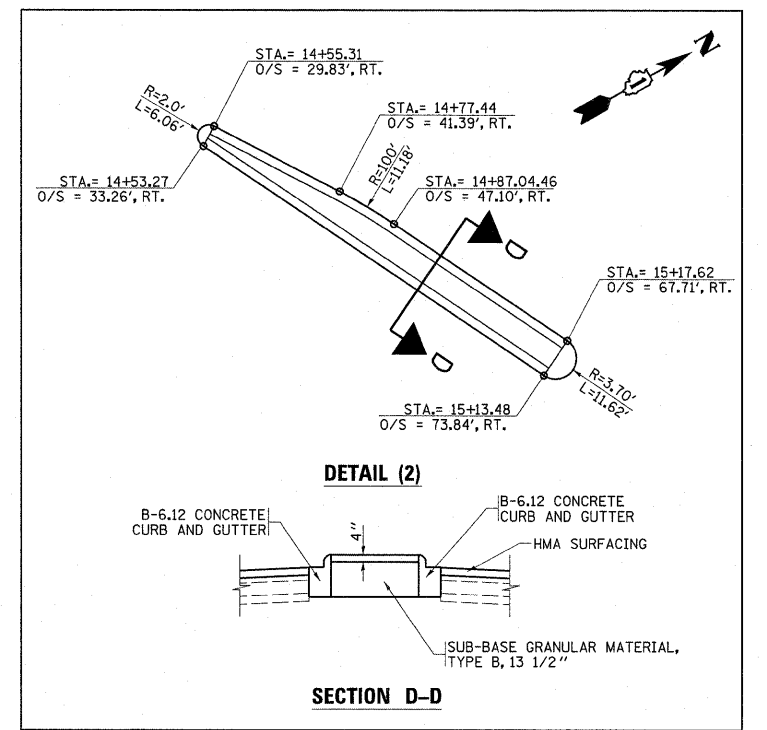

DETAIL (2)

SECTION D-D

1 REVISIED SHEET 6/10/11 AH

FILE NAME =	USER NAME = hemdanah	DESIGNED -	REVISED -	STATE OF ILLINOIS DEPARTMENT OF TRANSPORTATION	I-57 AT PRARIE VIEW REST AREA IN PEOTONE PROPOSED PLAN (NORTHBOUND REST AREA)	F.A.I. RTE.	SECTION	COUNTY	TOTAL SHEETS	SHEET NO.
es:\pw_work\pwwdot\hemdanah\d0264490\shp\plan.dgn		DRAWN -	REVISED -			57	99-I-RA-WRS	WILL	14	8
PLOT SCALE = 50:0000' / 1\"/>										
PLOT DATE = 6/10/2011		CHECKED -	REVISED -			CONTRACT NO. 60P08				
		DATE -	REVISED -	SCALE: SHEET NO. 1 OF 2 SHEETS STA. TO STA.		[ILLINOIS] FED. AID PROJECT				