

F.A.I. RTE.	SECTION	COUNTY	TOTAL SHEETS	SHEET NO.
90/94	2003-03II	COOK	976	272
STA. 1282+00		TO STA. 1295+00		
FED. ROAD DIST. NO.		ILLINOIS FED. AID PROJECT		
		62583		

- NOTES:
- SEE DRAWINGS ME-01 AND ME-02 FOR ELECTRICAL SYMBOLS AND ABBREVIATIONS.
 - SEE DRAWING UL-16 FOR 83rd STREET UNDERPASS LIGHTING PLANS.

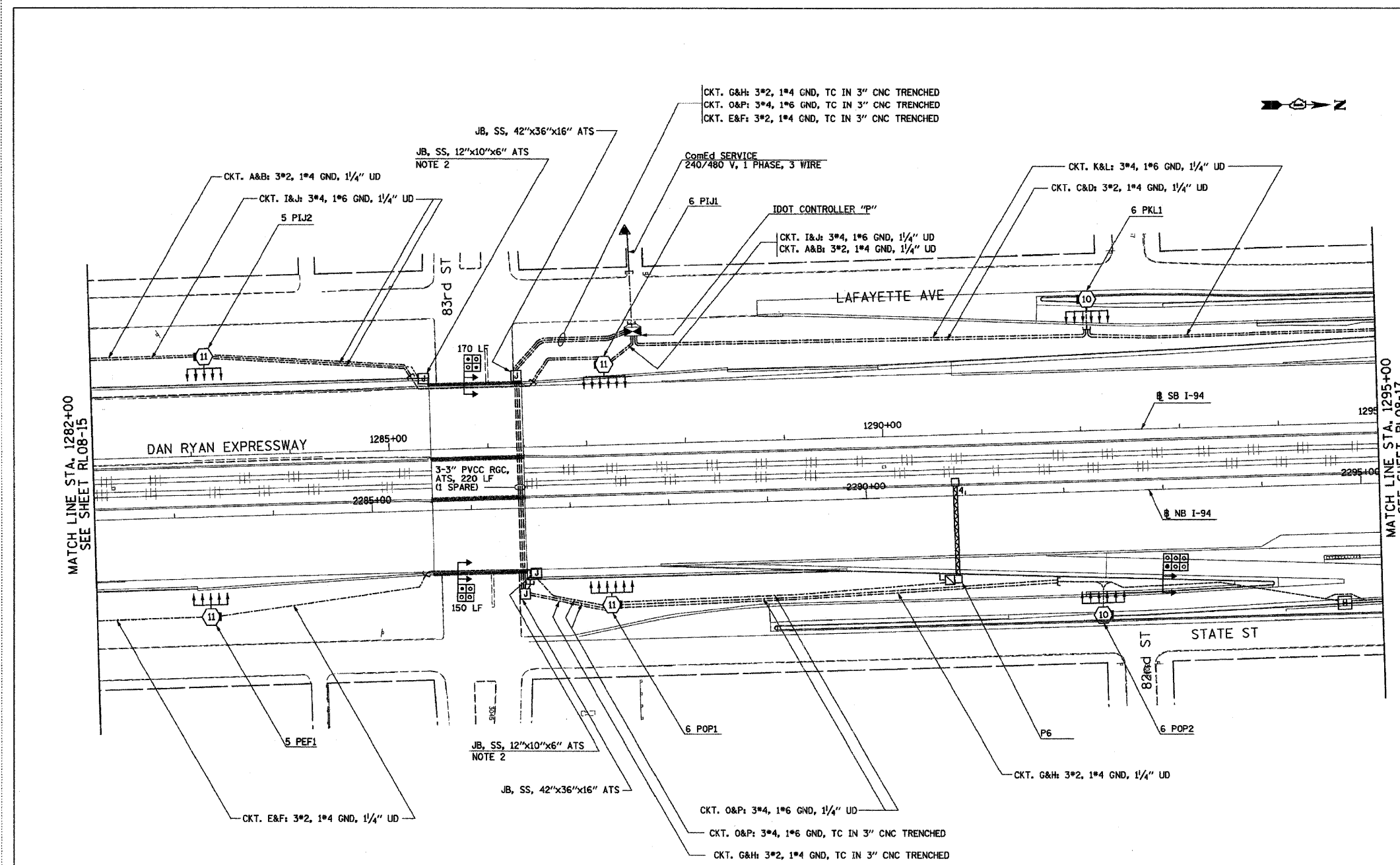

MATCH LINE STA. 1282+00
SEE SHEET RL08-15

MATCH LINE STA. 1295+00
SEE SHEET RL08-17

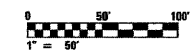

RL08-16

SINGH 300 N. ADAMS ST.
CHICAGO, IL 60606
TEL: (312) 629-2240
SINGH & ASSOCIATES, INC. FAX: (312) 629-8449
CONSULTING ENGINEERS

REVISIONS	
NAME	DATE

ILLINOIS DEPARTMENT OF TRANSPORTATION
F.A.I. 90/94 (DAN RYAN EXPRESSWAY)
31st STREET TO I-57
ROADWAY LIGHTING PLANS
PROPOSED IMPROVEMENTS 2008
SCALE: 1"=50'
DATE: OCTOBER 29, 2004
DRAWN BY: VG
CHECKED BY: TM

FOR INFORMATION ONLY

(Sheet 1 of 3)

**STATE OF ILLINOIS
DEPARTMENT OF TRANSPORTATION**

**ROADWAY LIGHTING LOCATION
6POP2**



USER NAME =	DESIGNED - MTH	REVISED -
FILE NAME =	CHECKED - ADB	REVISED -
PLOT SCALE =	DRAWN - AJF	REVISED -
PLOT DATE =	CHECKED - MTH	REVISED -

F.A.I. RTE.	SECTION	COUNTY	TOTAL SHEETS	SHEET NO.
90/94	2011-021-L	COOK	19	8
				CONTRACT NO. 60P16
ILLINOIS FED. AID PROJECT				