

ROUTE FAI 90/94	SECTION 2011-027-1	COUNTY COOK	TOTAL SHEETS 87	SHEET NUMBER 43
--------------------	-----------------------	----------------	--------------------	--------------------

CONTRACT NO. 60P27

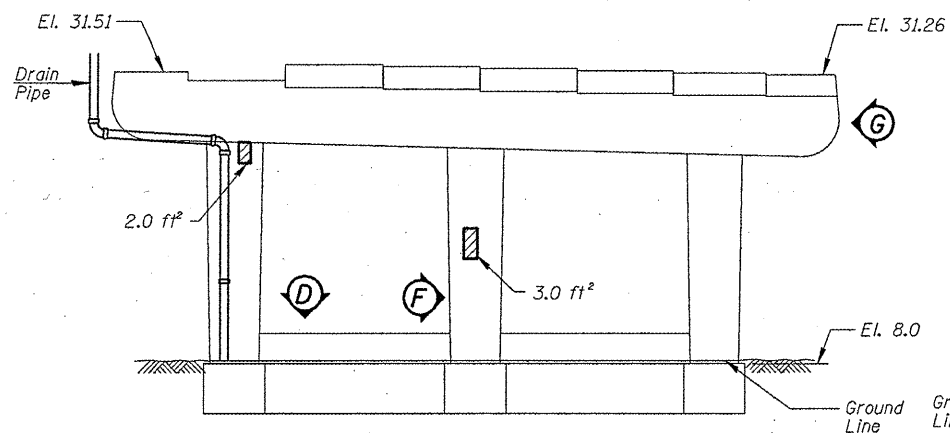

**PIER D-10 - SOUTH ELEVATION**  
(Looking North)

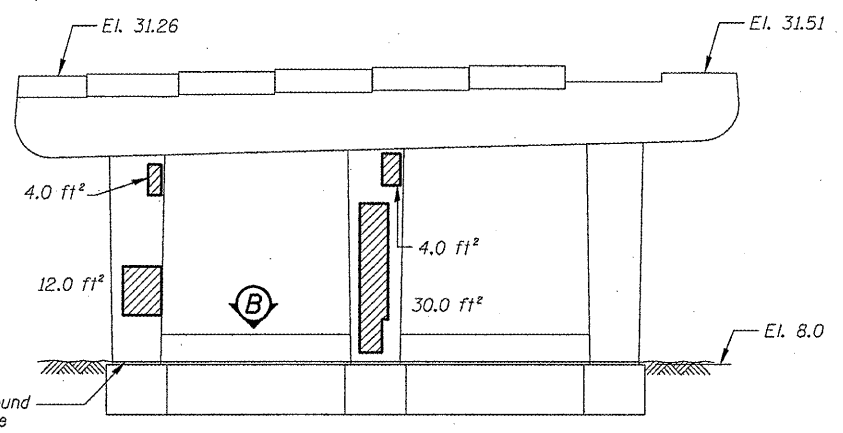

**PIER D-10 - NORTH ELEVATION**  
(Looking South)

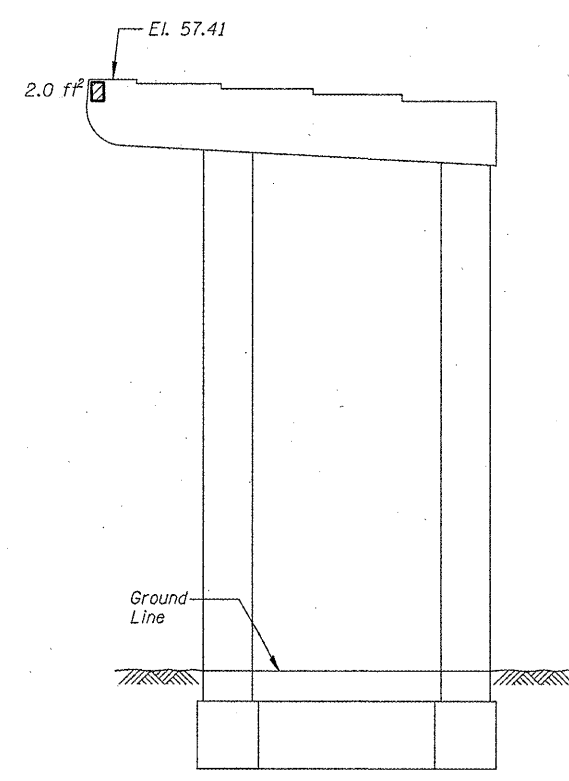

**PIER C-2 - SOUTH ELEVATION**  
(Looking North)

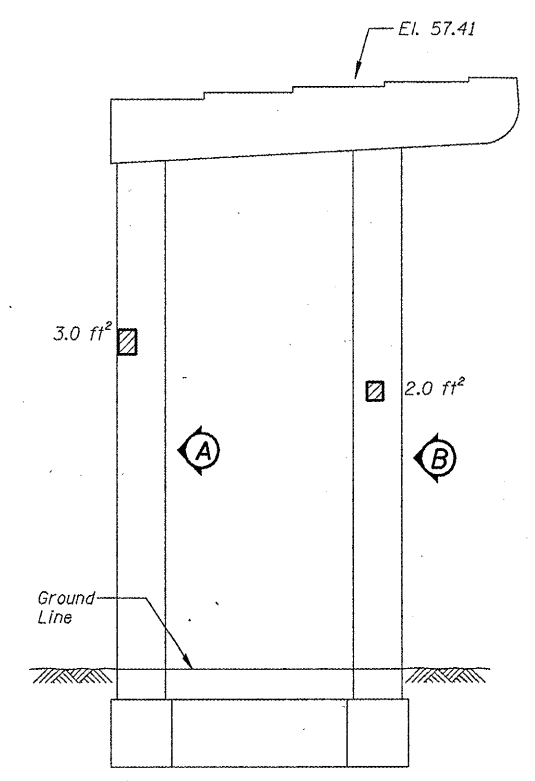

**PIER C-2 - NORTH ELEVATION**  
(Looking South)

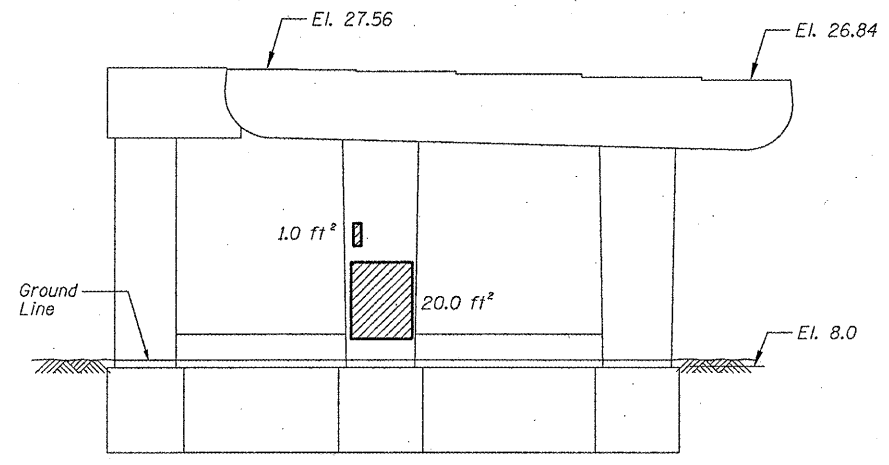

**PIER D-11 - SOUTH ELEVATION**  
(Looking North)

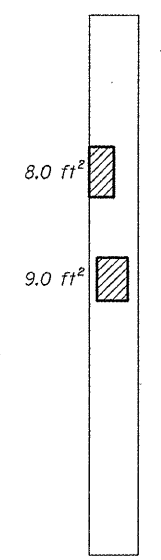

**PIER C-2 - VIEW A**  
Looking East at side of column

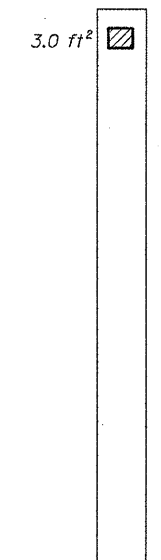

**PIER C-2 - VIEW B**  
Looking East at side of column

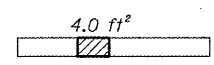

**PIER D-10 - VIEW B**  
Looking down at top of grade beam

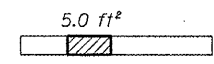

**PIER D-10 - VIEW D**  
Looking down at top of grade beam

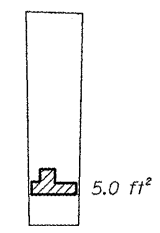

**PIER D-10 - VIEW F**  
Looking East at side of column

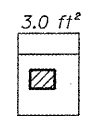

**PIER D-10 - VIEW G**  
Looking West at end of cap

**BILL OF MATERIAL**

ITEM	UNIT	QUANTITY
Structural Repair of Concrete (Depth equal to or less than 5")	SQ. FT.	120.0

▨ - Structural Repair of Concrete (Depth equal to or less than 5")

ILLINOIS DEPARTMENT OF  
TRANSPORTATION  
I-90/94 (DAN RYAN EXPRESSWAY)  
SUBSTRUCTURE REPAIRS  
SN 016-1113  
PIERS D-10, D-11, & C-2