

ROUTE FAI 90/94	SECTION 2011-027-I	COUNTY COOK	TOTAL SHEETS 87	SHEET NUMBER 66
--------------------	-----------------------	----------------	--------------------	--------------------

CONTRACT NO. 60P27

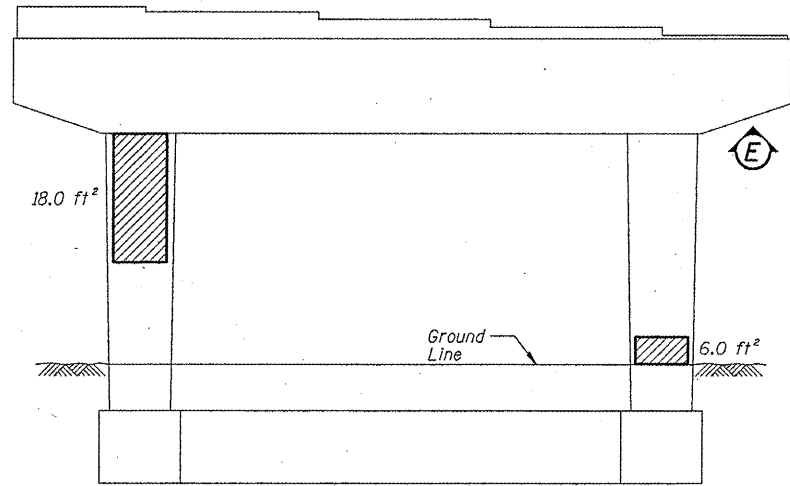

**PIER 15 - NORTH ELEVATION**  
(Looking South)

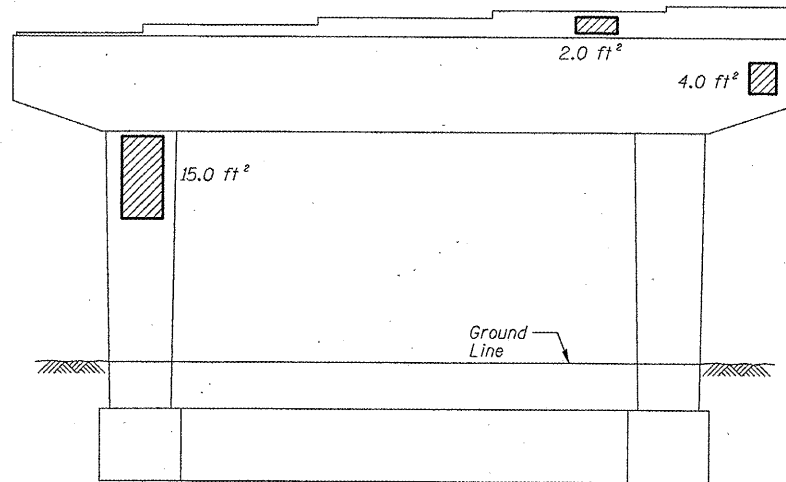

**PIER 15 - SOUTH ELEVATION**  
(Looking North)

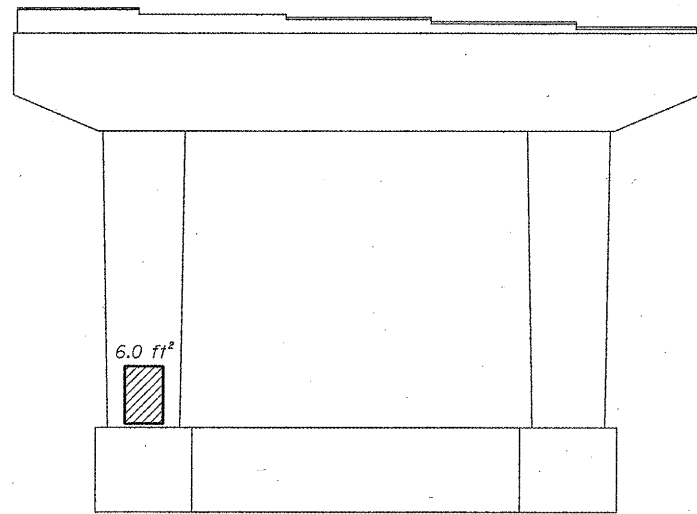
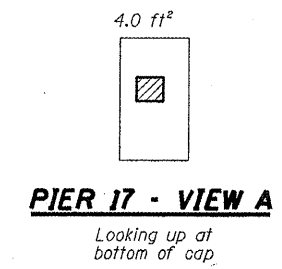
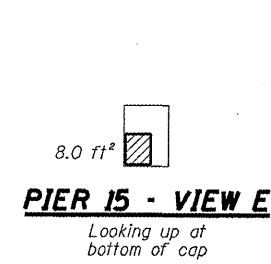

**PIER 16 - NORTH ELEVATION**  
(Looking South)

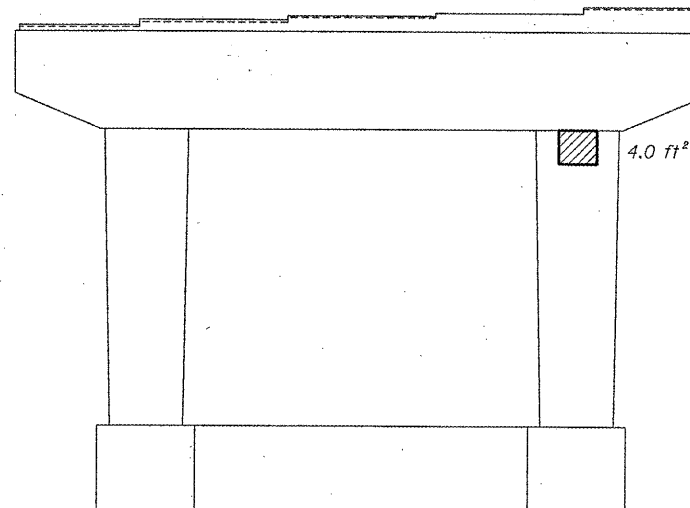

**PIER 16 - SOUTH ELEVATION**  
(Looking North)

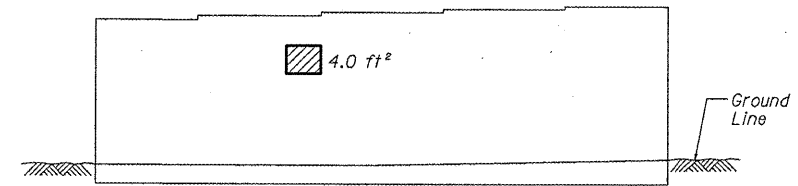

**ABUTMENT 18 - WEST ELEVATION**  
(Looking East)

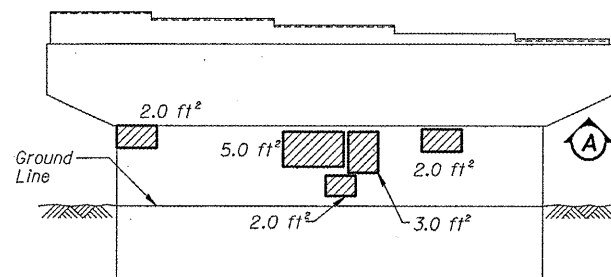

**PIER 17 - NORTH ELEVATION**  
(Looking South)

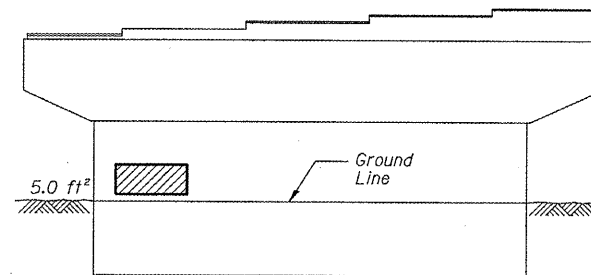

**PIER 17 - SOUTH ELEVATION**  
(Looking North)

**BILL OF MATERIAL**

ITEM	UNIT	QUANTITY
Structural Repair of Concrete (Depth equal to or less than 5")	SQ. FT.	90.0

▨ - Structural Repair of Concrete (Depth equal to or less than 5")

ILLINOIS DEPARTMENT OF  
TRANSPORTATION

I-90/94 (DAN RYAN EXPRESSWAY)  
SUBSTRUCTURE REPAIRS  
SN 016-1140  
PIERS 15, 16, 17, & ABUT 18