

EXISTING PLAN
PROPOSED PLAN

- LEGEND**
- ✕ REMOVE AND RELOCATE SIGN PANEL ASSEMBLY AND SIGN PANEL(S) (SEE GENERAL NOTES)
 - ✕ TREE REMOVAL
 - ✕ STUMP REMOVAL
 - SEE TREE REMOVAL SCHEDULE
 - ⊗ DRIVEWAY PAVEMENT REMOVAL
 - ▨ PAVED SHOULDER REMOVAL

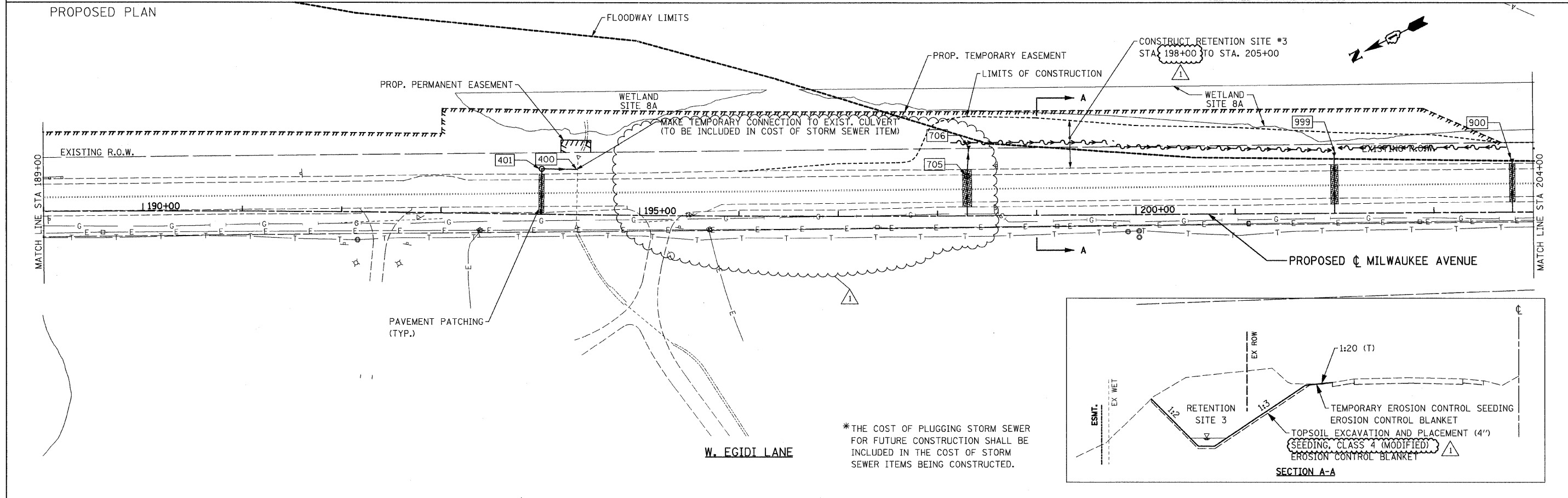

*THE COST OF PLUGGING STORM SEWER FOR FUTURE CONSTRUCTION SHALL BE INCLUDED IN THE COST OF STORM SEWER ITEMS BEING CONSTRUCTED.

FILE NAME = sht-plan02.dgn	USER NAME = IDOT	DESIGNED - EJM	REVISED - 06/03/11 J.V.	STATE OF ILLINOIS DEPARTMENT OF TRANSPORTATION	ROADWAY PLAN IL RTE 21 (MILWAUKEE AVE)			F.A.P. RTE. 330	SECTION 128-I-3	COUNTY LAKE	TOTAL SHEETS 128	SHEET NO. 20
PLOT SCALE = 50,0000' / IN.		DRAWN - BK	REVISED -		SCALE: 1" = 50'	SHEET NO.	OF SHEETS	STA. 189+00.00 TO STA. 204+00.00	CONTRACT NO. 60P33			
PLOT DATE = 6/2/2011		CHECKED - GFL	REVISED -		ILLINOIS FED. AID PROJECT							
		DATE - 3/18/2011	REVISED -									