

LEGEND

- X REMOVE AND RELOCATE SIGN PANEL ASSEMBLY AND SIGN PANEL(S) (SEE GENERAL NOTES)
- ⊗ TREE REMOVAL
- ⊗ STUMP REMOVAL (SEE TREE REMOVAL SCHEDULE)
- ⊗ DRIVEWAY PAVEMENT REMOVAL
- ⊗ PAVED SHOULDER REMOVAL

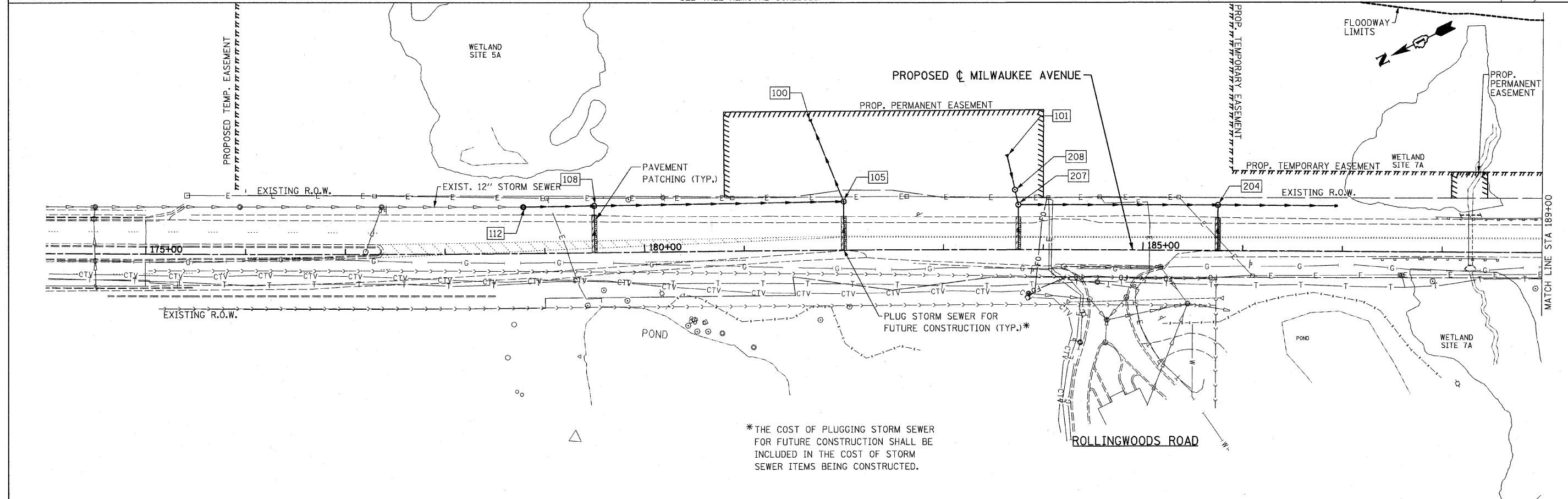

*THE COST OF PLUGGING STORM SEWER FOR FUTURE CONSTRUCTION SHALL BE INCLUDED IN THE COST OF STORM SEWER ITEMS BEING CONSTRUCTED.

| | | | | | | | | | | | | |
|---|------------------|------------------|-----------|---|---|-----------|-----------|----------------------------------|--------------------|----------------|------------------------|--------------------|
| FILE NAME = I:\102905_IL21.edv\CADD Sheets\ht-plan01.dgn | USER NAME = IDOT | DESIGNED - EJM | REVISED - | STATE OF ILLINOIS DEPARTMENT OF TRANSPORTATION | ROADWAY PLAN IL RTE 21 (MILWAUKEE AVE) | | | F.A.P. RTE. 330 | SECTION 128-1-3 | COUNTY LAKE | TOTAL SHEETS 128 | SHEET NO. 19 |
| PLOT SCALE = 50,0000' / IN. | | CHECKED - GFL | REVISED - | | SCALE: 1" = 50' | SHEET NO. | OF SHEETS | STA. 174+00.00 TO STA. 189+00.00 | CONTRACT NO. 60P33 | | | |
| PLOT DATE = 5/9/2011 | | DATE - 3/18/2011 | REVISED - | | ILLINOIS FED. AID PROJECT | | | | | | | |
| | | | | | | | | | | | | |