

DETOUR SIGNING

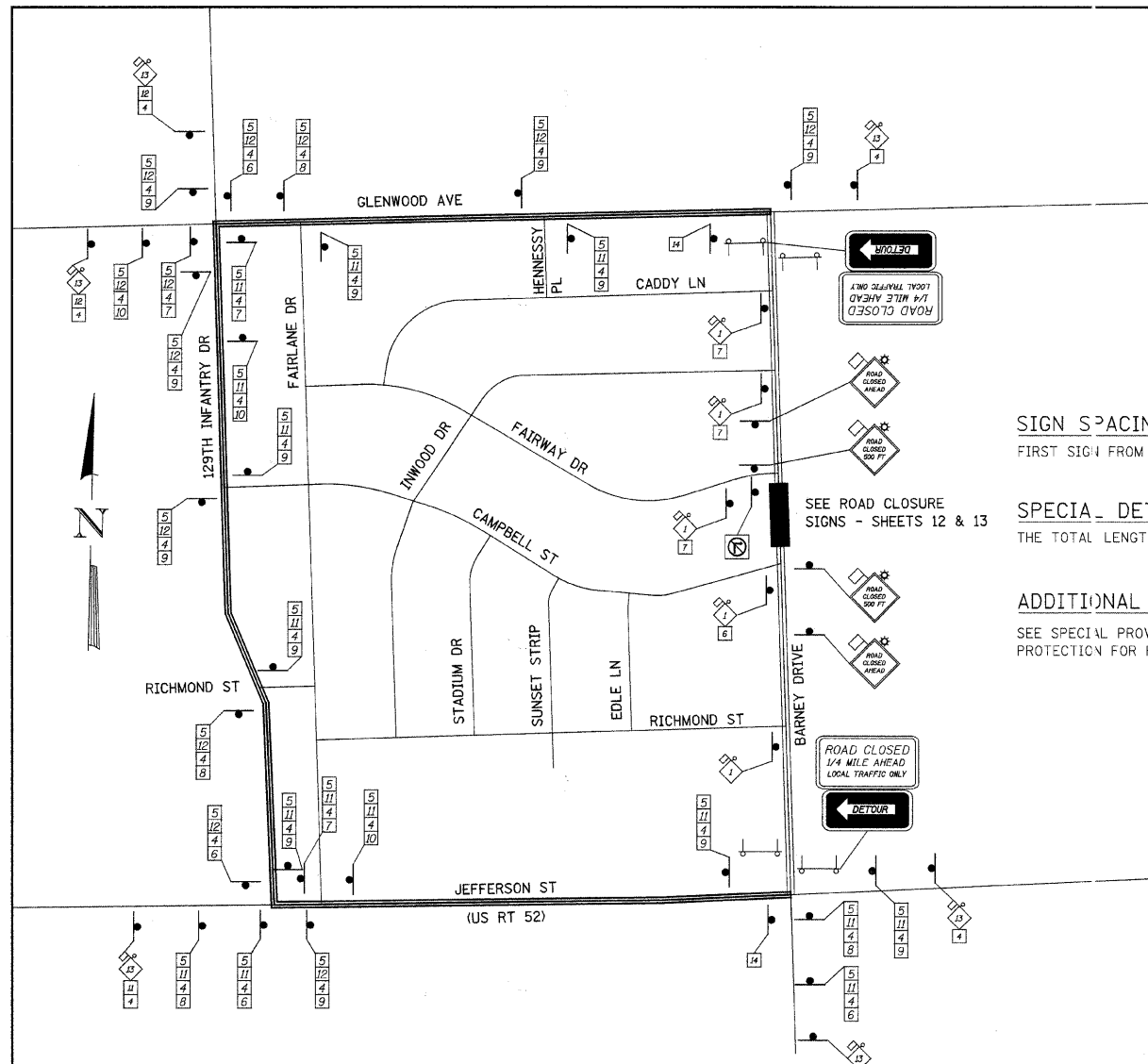

SIGN SPACING

FIRST SIGN FROM INTERSECTION 25'±.

SPECIAL DETOUR NOTES

THE TOTAL LENGTH OF THE DETOUR IS 1.3 MILES.

ADDITIONAL SIGNS

SEE SPECIAL PROVISIONS TRAFFIC CONTROL AND PROTECTION FOR ROAD CLOSED AND OTHER SIGNING REQUIREMENTS

- ALL SIGNING SHALL BE IN ACCORDANCE WITH THE APPLICABLE PROVISIONS OF THE STATE OF ILLINOIS "STANDARD SPECIFICATIONS FOR ROAD AND BRIDGE CONSTRUCTIONS ADOPTED JAN. 1, 2007", "THE QUALITY STANDARD FOR WORK ZONE TRAFFIC CONTROL DEVICES, LATEST EDITION", THE DETAILS IN THESE PLANS, AND THE LATEST EDITION OF THE STATE OF ILLINOIS "MANUAL OF UNIFORM TRAFFIC CONTROL DEVICES".
- THE CONTRACTOR SHALL SCHEDULE ALL WORK IN AN EXPEDIENT MANNER TO REDUCE THE LENGTH OF TIME THAT THE DETOUR NEEDS TO BE IN EFFECT.
- THE ENGINEER SHALL BE NOTIFIED IN WRITING AT LEAST THREE WEEKS PRIOR TO THE DAY THE DETOUR IS TO BE IN EFFECT. ENGINEER WILL CONTACT THE JOLIET POLICE DEPARTMENT (815-726-2491) AND IDOT.
- IF DEEMED NECESSARY BY THE ENGINEER A PRE-CONSTRUCTION MEETING WITH THE CONTRACTOR SHALL BE HELD AT LEAST TWO WEEKS PRIOR TO THE DAY THE DETOUR IS TO BE IN EFFECT.
- THE CONTRACTOR SHALL SUPPLY TO THE ENGINEER THE NAMES AND TELEPHONE NUMBERS OF HIS REPRESENTATIVES ON THE CONSTRUCTION SITE AND HIS REPRESENTATIVES FOR THE DETOUR SIGNING PRIOR TO THE START OF WORK.
- IF REQUESTED BY THE CONTRACTOR IN WRITING AT LEAST THREE WEEKS PRIOR TO THE DAY THE DETOUR IS TO BE IN EFFECT THE ENGINEER WILL FIELD LOCATE THE POSITIONS OF ANY SIGNS. EXISTING SIGNS SHALL BE PROTECTED BY THE CONTRACTOR IN ACCORDANCE WITH ARTICLE 107.25 OF THE STANDARD SPECIFICATIONS.
- LONGITUDINAL DIMENSIONS SHOWN ON THE PLANS MAY BE ADJUSTED TO FIT FIELD CONDITIONS.
- THE ROAD SHALL NOT BE CLOSED UNTIL ALL SIGNING IS ERECTED IN ACCORDANCE WITH THE DETOUR PLAN AND INSPECTED AND APPROVED BY THE ENGINEER.
- THE CONTRACTOR SHALL BE RESPONSIBLE FOR ENSURING THAT ALL BARRICADES, SIGNS, LIGHTS, AND OTHER DEVICES INSTALLED BY HIM ARE IN PLACE AND OPERATING 24 HOURS EACH DAY INCLUDING SUNDAYS AND HOLIDAYS DURING THE TIME THE DETOUR IS IN EFFECT.
- THE CONTRACTOR SHALL MAKE ALL CHANGES IN SIGNING THAT ARE DEEMED NECESSARY BY THE ENGINEER.
- ALL EXISTING SIGNING THAT IS NOT APPLICABLE WHILE THE DETOUR IS IN EFFECT SHALL BE COMPLETELY COVERED BY THE CONTRACTOR, IN A MANNER APPROVED BY THE ENGINEER.
- ALL DETOUR SIGNING EXCEPT REGULATORY SIGNS SHALL HAVE BLACK LEGENDS ON FLUORESCENT ORANGE SHEETING AND STANDARD BLACK BORDERS. THE FLUORESCENT ORANGE REFLECTIVE SHEETING SHALL MEET THE REQUIREMENTS OF ARTICLE 1084.02 OF THE STANDARD SPECIFICATIONS. ALL DETOUR SIGNING SHALL BE NEW OR LIKE NEW CONDITION. THE ENGINEER SHALL BE THE SOLE JUDGE OF THE CONDITION AND ACCEPTANCE OF THE SIGNS.
- THE SIZES OF ALL SIGNS NOT SPECIFIED IN THESE PLANS SHALL BE AS REQUIRED BY THE ILLINOIS MANUAL OF UNIFORM TRAFFIC CONTROL DEVICES.
- AS A MINIMUM, ALL AMBER FLASHING LIGHTS THAT ARE REQUIRED FOR THIS DETOUR SHALL MEET THE REQUIREMENTS FOR TYPE A-LOW INTENSITY FLASHING LIGHTS IN ARTICLE 1084.01 OF THE STANDARD SPECIFICATIONS. ALL LIGHTS SHALL OPERATE DURING THE HOURS OF DARKNESS. ONLY LIGHTS THAT HAVE BEEN APPROVED BY THE ILLINOIS DEPARTMENT OF TRANSPORTATION SHALL BE USED.
- THE MINIMUM DIMENSIONS OF THE ORANGE WARNING FLAGS SHOWN IN THE PLANS ARE 18" X 18".
- THE TYPE III BARRICADES USED AT THE POINT OF CLOSURE TO THRU TRAFFIC SHALL NOT EXCEED 12'-0" IN WIDTH EACH, FOR A SINGLE APPROACH LANE.
- ALL TYPE III BARRICADES SHALL HAVE TWO (2) AMBER TYPE A-LOW INTENSITY FLASHING LIGHTS SPACED NEAR THE CENTERLINE OF THE SUPPORTS.
- CONSTRUCTION EQUIPMENT SHALL NOT BE PARKED IMMEDIATELY BEHIND THE TYPE III BARRICADES DURING NON-WORKING HOURS. IN ANY EVENT ARTICLE 701.11 OF THE STANDARD SPECIFICATIONS SHALL APPLY.
- THE CONTRACTOR SHALL BE RESPONSIBLE FOR MAINTAINING THE VISIBILITY OF ALL DETOUR AND CONSTRUCTION SIGNING. BRUSHING BACK VEGETATION IF DEEMED BY THE ENGINEER.
- THE ENGINEER SHALL BE NOTIFIED AT LEAST TWO (2) HOURS BEFORE THE ROAD IS TO BE OPENED TO TRAFFIC. THE ENGINEER WILL CONTACT THE JOLIET POLICE DEPARTMENT (815-726-2491) AND IDOT.
- THE CONTRACTOR SHALL CONTACT THE IDOT TRAFFIC CONTROL SUPERVISOR AT (847) 705-4470 A MINIMUM OF 72 HOURS PRIOR TO PLACING ANY SIGNS OR TRAFFIC CONTROL DEVICES, INCLUDING DETOUR SIGNING.

LEGEND

- DETOUR ROUTE
- ROAD CLOSURE OPEN TO LOCAL TRAFFIC ONLY (NOT THRU)
- PROJECT LOCATION
- 36" X 36" CONSTRUCTION SIGN WITH AMBER FLASHING LIGHT AND ORANGE WARNING FLAG (OPTIONAL) NUMBER DENOTES SIGN TYPE
- TYPE III BARRICADE W/ FLASHING LIGHTS
- OTHER DETOUR SIGNS, NUMBER DENOTES TYPE

SIGN LEGEND

- | | | | | | |
|---|--|---|---|--|---|
| ① | | W20-3, 36" X 36" WITH AMBER FLASHING LIGHTS AND FLAG. (5 REQ'D) | ⑧ | | M5-1 L, 21" X 15" (4 REQ'D) |
| ② | | R11-3a, 60" X 30" (2 REQ'D) | ⑨ | | M6-3, 21" X 15" (13 REQ'D) |
| ③ | | M4-10, 48" X 18" (2 REQ'D) | ⑩ | | M5-1 R, 21" X 15" (3 REQ'D) |
| ④ | | ROUTE MARKER 24" X 12" (31 REQ'D) | ⑪ | | M3-1, 24" X 12" (16 REQ'D) |
| ⑤ | | M4-8, 24" X 12" (27 REQ'D) | ⑫ | | M3-3, 24" X 12" (14 REQ'D) |
| ⑥ | | M6-1 L, 21" X 15" (4 REQ'D) | ⑬ | | W20-2, 36" X 36" WITH AMBER FLASHING LIGHTS AND FLAG. (6 REQ'D) |
| ⑦ | | M6-1 R, 21" X 15" (5 REQ'D) | ⑭ | | M4-8a, 24" X 18" (2 REQ'D) |

FILE NAME = S:\PROJECTS\2010\12\01\02_BarneyDrPHI_DESIGN\TRANS\DETOUR\Plan.dgn

USER NAME =	DESIGNED - L.G.N.	REVISED -
PLOT SCALE =	CHECKED - G.F.S.	REVISED -
PLOT DATE =	DRAWN - L.G.N.	REVISED -
	CHECKED - G.F.S.	REVISED -

**ILLINOIS DEPARTMENT OF TRANSPORTATION
BARNEY DRIVE OVER TRIBUTARY OF ROCK RUN
STATION 20+00**

**DETOUR SIGNING
STRUCTURE NO. 099-6474**

F.A.U. RTE.	SECTION	COUNTY	TOTAL SHEETS	SHEET NO.
0330	08-00413-00-BR	WILL	33	9
	WHA# 1201010		CONTRACT NO. 63571	
ILLINOIS FED. AID PROJECT BRM-9003162				