

- STAGE 1 CONSTRUCTION SEQUENCE**
1. CONSTRUCT SIDEWALK RAMPS AT 20+93 RT & LT
 2. INSTALL DETOUR SIGNING
 3. INSTALL ROAD CLOSURE
 4. INSTALL STAGE 1 CHAIN LINK FENCE
 5. PERFORM WATERMAIN CONSTRUCTION
 6. PERFORM STAGE 1 STRUCTURAL WORK
 7. PERFORM STAGE 1 ROADWAY WORK
 8. CONSTRUCT TEMPORARY SIDEWALK RAMP AT 19+32 LT

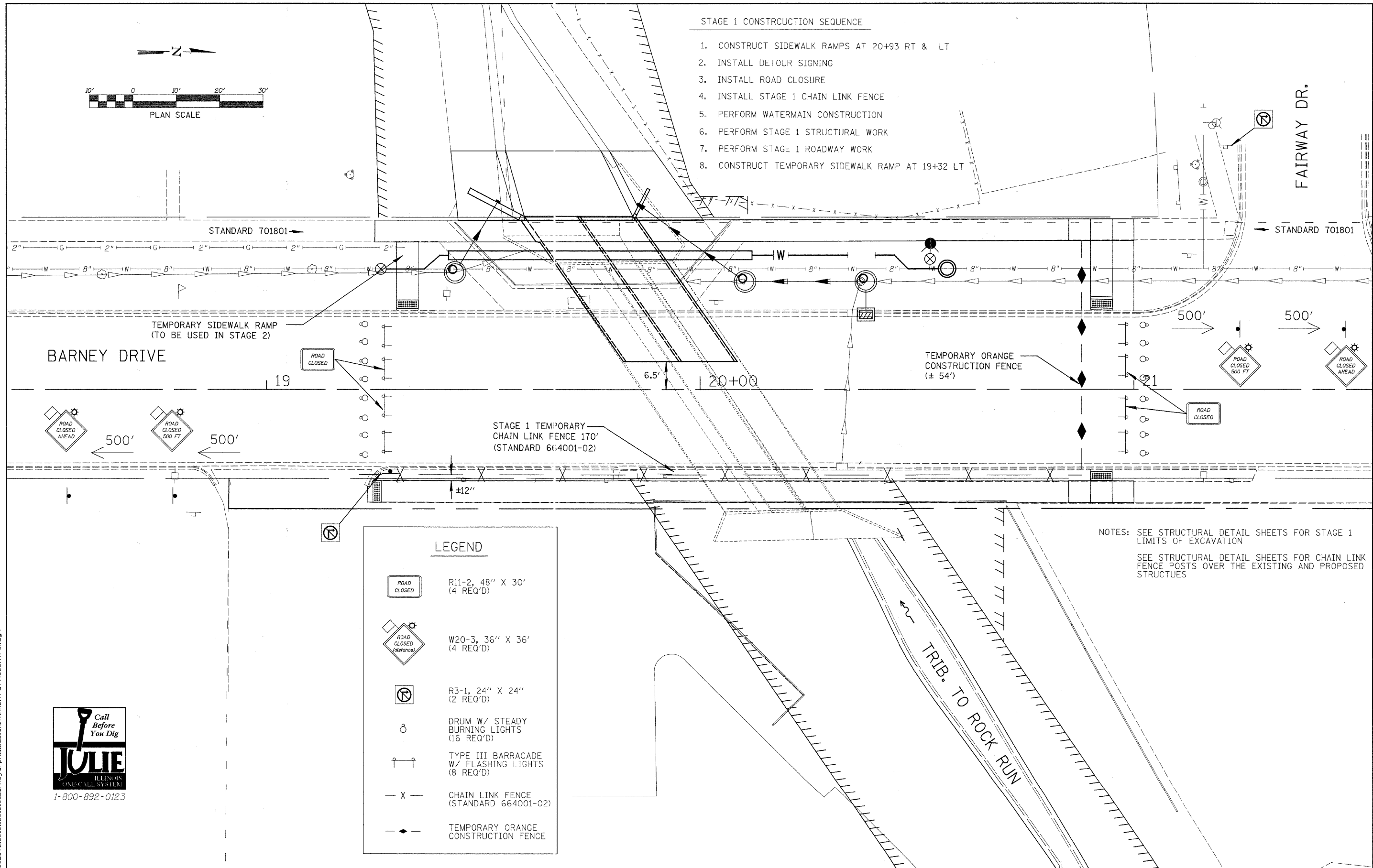

BARNEY DRIVE

FAIRWAY DR.

STAGE 1 TEMPORARY CHAIN LINK FENCE 170' (STANDARD 664001-02)

TEMPORARY ORANGE CONSTRUCTION FENCE (± 54')

TEMPORARY SIDEWALK RAMP (TO BE USED IN STAGE 2)

LEGEND

- R11-2, 48" X 30' (4 REQ'D)
- W20-3, 36" X 36' (4 REQ'D)
- R3-1, 24" X 24" (2 REQ'D)
- DRUM W/ STEADY BURNING LIGHTS (16 REQ'D)
- TYPE III BARRICADE W/ FLASHING LIGHTS (8 REQ'D)
- CHAIN LINK FENCE (STANDARD 664001-02)
- TEMPORARY ORANGE CONSTRUCTION FENCE

NOTES: SEE STRUCTURAL DETAIL SHEETS FOR STAGE 1 LIMITS OF EXCAVATION
SEE STRUCTURAL DETAIL SHEETS FOR CHAIN LINK FENCE POSTS OVER THE EXISTING AND PROPOSED STRUCTURES



FILE = S:\PROJECTS\2010\1201D10_BarneyDrPHI.DESIGN\TRANS.TrafficControl.dgn

USER NAME =	DESIGNED - L.G.N.	REVISED -
PLOT SCALE =	CHECKED - G.F.S.	REVISED -
PLOT DATE =	DRAWN - L.G.N.	REVISED -
	CHECKED - G.F.S.	REVISED -

ILLINOIS DEPARTMENT OF TRANSPORTATION
BARNEY DRIVE OVER TRIBUTARY OF ROCK RUN
STATION 20+00

STAGE 1 PEDESTRIAN CONTROL
STRUCTURE NO. 099-6474
SHEET NO. 1 OF 2 SHEETS

F.A.U. RTE.	SECTION	COUNTY	TOTAL SHEETS	SHEET NO.
0330	08-00413-00-BR	WILL	33	10
WHA# 1201D10		CONTRACT NO. 63571		
ILLINOIS FED. AID PROJECT BRM-9003162				