

STAGE 2 CONSTRUCTION SEQUENCE

1. RELOCATE CHAIN LINK FENCE FROM STAGE 1 TO STAGE 2 LOCATION
2. CONSTRUCT ALL REMAINING STRUCTURAL AND ROADWAY ITEMS
3. REMOVE TEMPORARY SIDEWALK RAMP AT 19+32 LT
4. REMOVE STAGE 2 CHAIN LINK FENCE
5. PERFORM LANDSCAPING WORK
6. REMOVE ROAD CLOSURE AND OPEN ROAD TO TRAFFIC
7. REMOVE DETOUR SIGNING

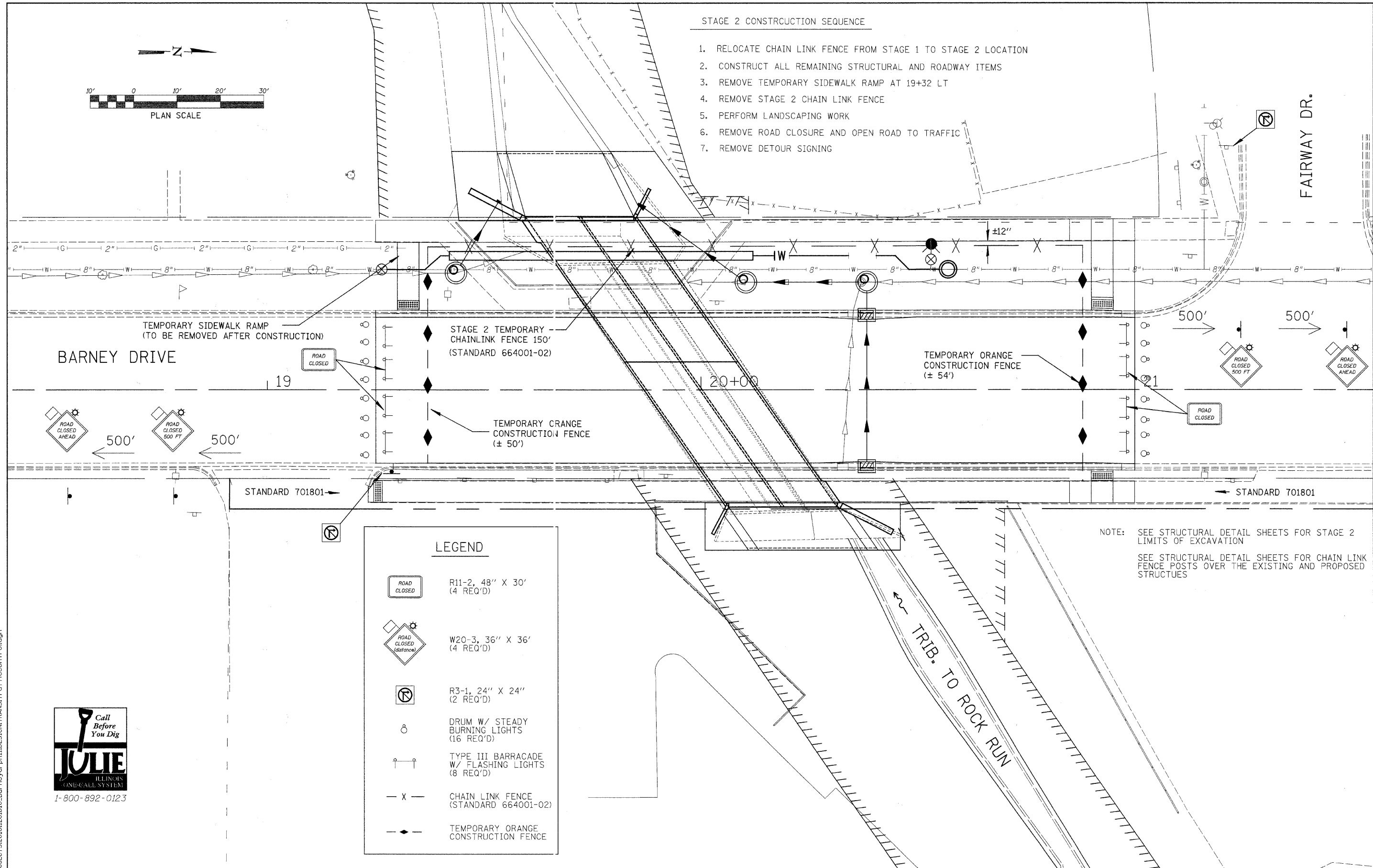

TEMPORARY SIDEWALK RAMP
(TO BE REMOVED AFTER CONSTRUCTION)

STAGE 2 TEMPORARY
CHAINLINK FENCE 150'
(STANDARD 664001-02)

TEMPORARY ORANGE
CONSTRUCTION FENCE
(± 54')

TEMPORARY ORANGE
CONSTRUCTION FENCE
(± 50')

STANDARD 701801

STANDARD 701801

LEGEND

- R11-2, 48" X 30'
(4 REQ'D)
- W20-3, 36" X 36'
(4 REQ'D)
- R3-1, 24" X 24"
(2 REQ'D)
- DRUM W/ STEADY
BURNING LIGHTS
(16 REQ'D)
- TYPE III BARRICADE
W/ FLASHING LIGHTS
(8 REQ'D)
- CHAIN LINK FENCE
(STANDARD 664001-02)
- TEMPORARY ORANGE
CONSTRUCTION FENCE

NOTE: SEE STRUCTURAL DETAIL SHEETS FOR STAGE 2
LIMITS OF EXCAVATION
SEE STRUCTURAL DETAIL SHEETS FOR CHAIN LINK
FENCE POSTS OVER THE EXISTING AND PROPOSED
STRUCTURES



FILE = S: PROJECTS\2010\1201D10_Barneydr\PHII_DESIGN_TRANSPORTATION\TrafficControl.dgn

USER NAME =	DESIGNED - L.G.N.	REVISED -
	CHECKED - G.F.S.	REVISED -
PLOT SCALE =	DRAWN - L.G.N.	REVISED -
PLOT DATE =	CHECKED - G.F.S.	REVISED -

ILLINOIS DEPARTMENT OF TRANSPORTATION
BARNEY DRIVE OVER TRIBUTARY OF ROCK RUN
STATION 20+00

STAGE 2 PEDESTRIAN CONTROL
STRUCTURE NO. 099-6474
SHEET NO. 2 OF 2 SHEETS

F.A.U. RTE.	SECTION	COUNTY	TOTAL SHEETS	SHEET NO.
0330	08-00413-00-BR	WILL	33	11
WHA# 1201D10			CONTRACT NO. 63571	
[ILLINOIS] FED. AID PROJECT BRM-9003(162)				