

FILE NAME = S:\PROJECTS\2010\1201010\DESIGN\STRUCT\1201010\_05\_Culvert Plan\_Details.dgn

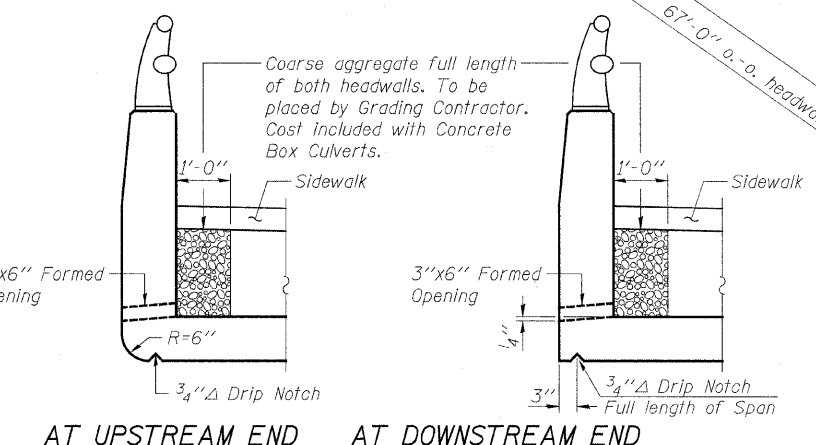
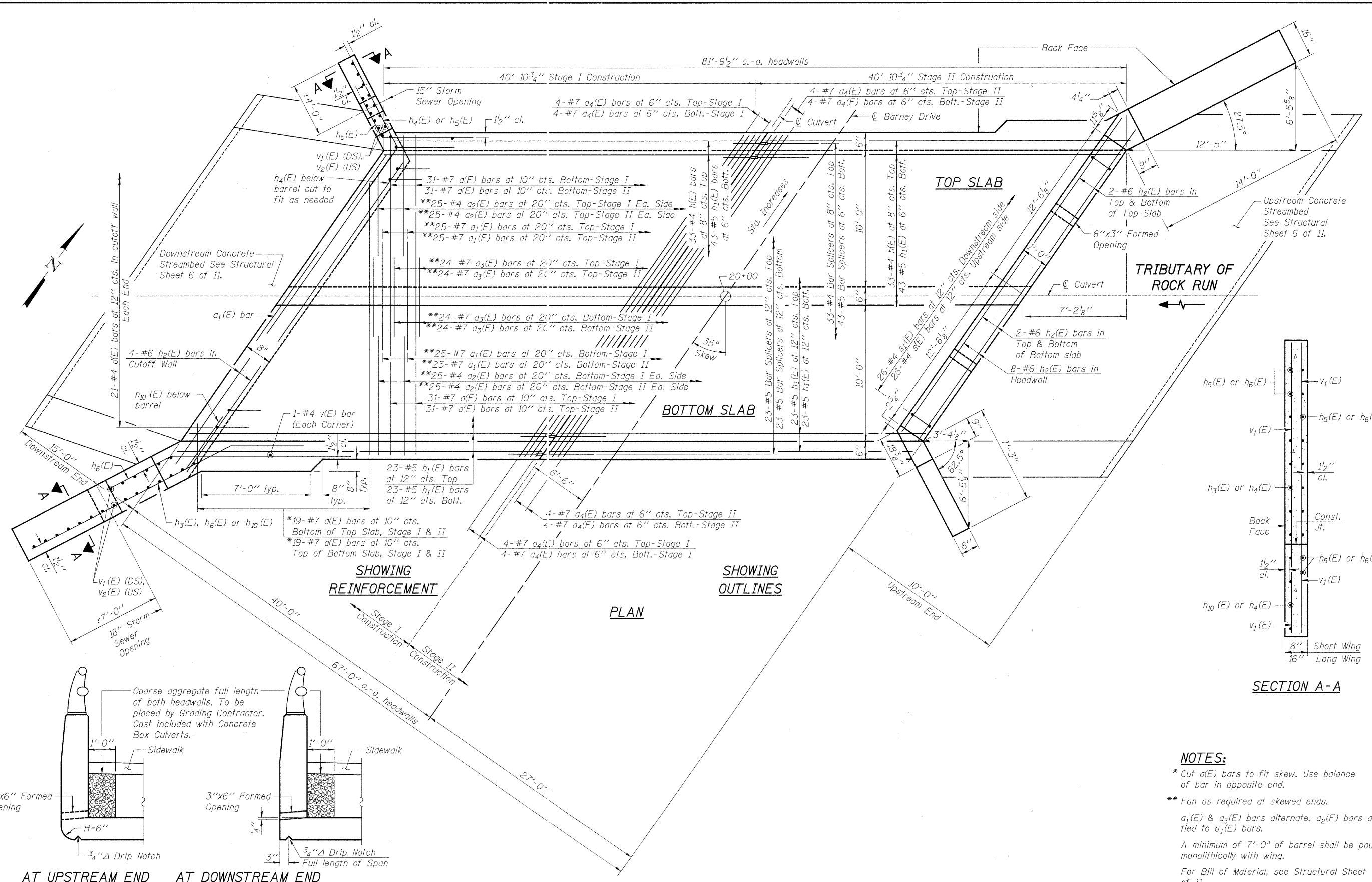

**NOTES:**  
 \* Cut a(E) bars to fit skew. Use balance of bar in opposite end.  
 \*\* Fan as required at skewed ends.  
 a<sub>1</sub>(E) & a<sub>3</sub>(E) bars alternate. a<sub>2</sub>(E) bars are tied to a<sub>1</sub>(E) bars.  
 A minimum of 7'-0" of barrel shall be poured monolithically with wing.  
 For Bill of Material, see Structural Sheet 7 of 11.

USER NAME =	DESIGNED - PETER PASCUA	REVISED -
PLOT SCALE =	CHECKED - BRIAN CONVERSE	REVISED -
PLOT DATE =	DRAWN - RON ALLEN	REVISED -
	CHECKED - BRIAN CONVERSE	REVISED -

**ILLINOIS DEPARTMENT OF TRANSPORTATION  
 BARNEY DRIVE OVER TRIBUTARY OF ROCK RUN  
 STATION 20+00**

<b>CULVERT PLAN DETAILS STRUCTURE NO. 099-6474</b>			
F.A.U. RTE. 0330	SECTION 08-00413-00-BR	COUNTY WILL	TOTAL SHEETS 33
	WHA# 1201010	CONTRACT NO. 63571	SHEET NO. 19
STRUCTURAL SHEET NO. 5 OF 11 SHEETS			

F.A.U. RTE. 0330	SECTION 08-00413-00-BR	COUNTY WILL	TOTAL SHEETS 33	SHEET NO. 19
	WHA# 1201010	CONTRACT NO. 63571		
ILLINOIS FED. AID PROJECT BRM-90031621				