

PROP. CURVE 9
 PI STA. = 432+84.69
 $\Delta = 56^\circ 38' 50''$ (LT)
 $D = 57^\circ 17' 45''$
 $R = 100.00'$
 $T = 53.90'$
 $L = 98.87'$
 $E = 13.60'$
 $e = \text{-----}$
 $T.R. = \text{-----}$
 $S.E. RUN = \text{-----}$
 P.C. STA. = 432+30.79
 P.T. STA. = 433+29.66

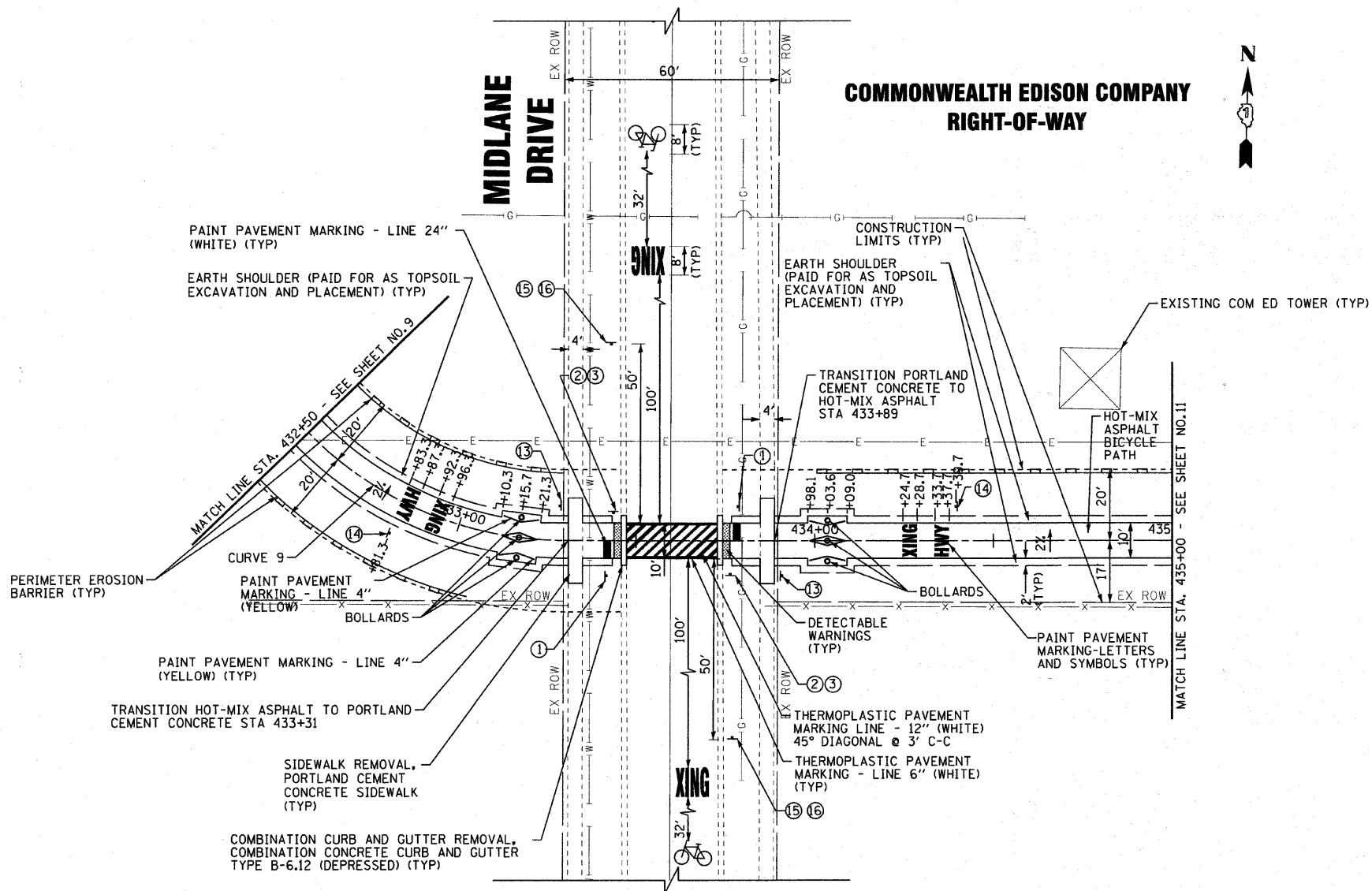

- SIGN LEGEND**
 FOR ADDITIONAL SIGNAGE SEE SHEET 7
- ① STOP R1-1 24" X 24"
 - ② BICYCLE W11-1 24" X 24"
 - ③ W16-7PL 24" X 12"
 - ⑬ NO MOTOR VEHICLES R5-3 24" X 24"
 - ⑭ W2-1 24" X 24"
 - ⑮ BIKE ROUTE D11-1 24" X 18"
 - ⑯ M6-4 12" X 9"

- NOTES:
- ALL AREAS OF DISTURBANCE SHALL RECEIVE SEEDING, CLASS 2
 - FOR ADDITIONAL SIGNAGE SEE SHEET 7
 - EXISTING BRUSH AND GARDEN MATERIALS IN CONFLICT WITH PROPOSED IMPROVEMENTS SHALL BE REMOVED AND OR RELOCATED AS DETERMINED BY THE ENGINEER AND INCLUDED IN THE COST OF EARTH EXCAVATION.

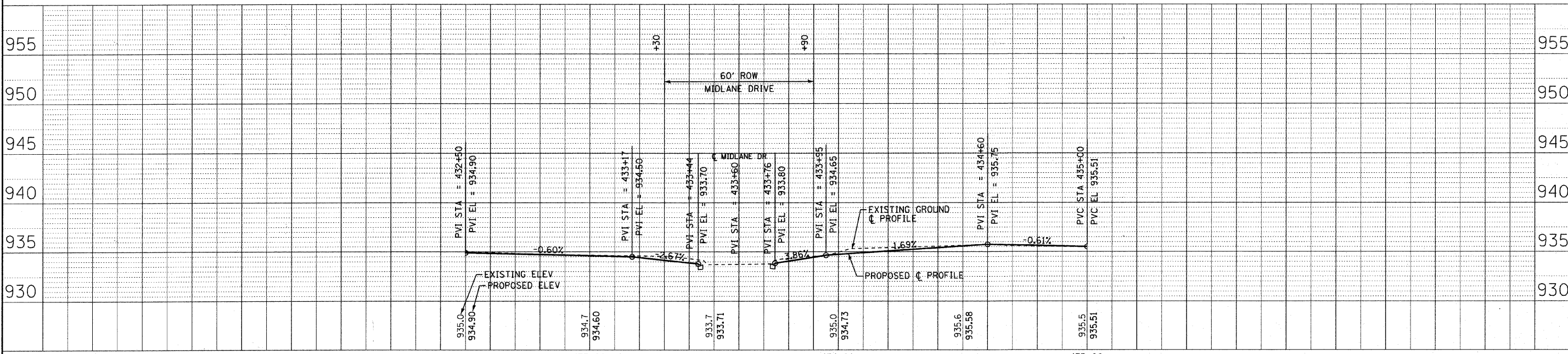

COPYRIGHT © 2011 BY BAXTER & WOODMAN, INC.
 STATE OF ILLINOIS PROFESSIONAL DESIGN FIRM
 LICENSE NO. 001-085-0001
 DATE 3/21/2011
 PROJECT NO. 090893-PPS-ahh
 DRAWN BY RKM/CJC
 CHECKED BY MDW
 DATE 1/26/11



USER NAME = 418a_jc	DESIGNED - AEB	REVISED - PER IDOT 3/25/11
FILE NAME = 090893-PPS-ahh	DRAWN - RKM/CJC	REVISED -
PLOT DATE = 3/31/2011	CHECKED - MDW	REVISED -
	DATE - 1/26/11	REVISED -

McHENRY COUNTY CONSERVATION DISTRICT
RIDGEFIELD TRACE EXTENSION
BICYCLE PATH

PLAN AND PROFILE
 SCALE: 1" = 20'
 STA. 432+50 TO STA. 435+00

F.A. RTE.	SECTION	COUNTY	TOTAL SHEETS	SHEET NO.
N/A	00-C2000-03-BT	McHENRY	25	10
JOB NO: C-91-711-10		CONTRACT NO. 63578		
FED. ROAD DIST. NO. 1 ILLINOIS		FED. AID PROJECT NO. CM-9003 (680)		

McHENRY COUNTY CONSERVATION DISTRICT BID #0311.09.01