

Notes:  
See sheet 12 of 28 for additional details.

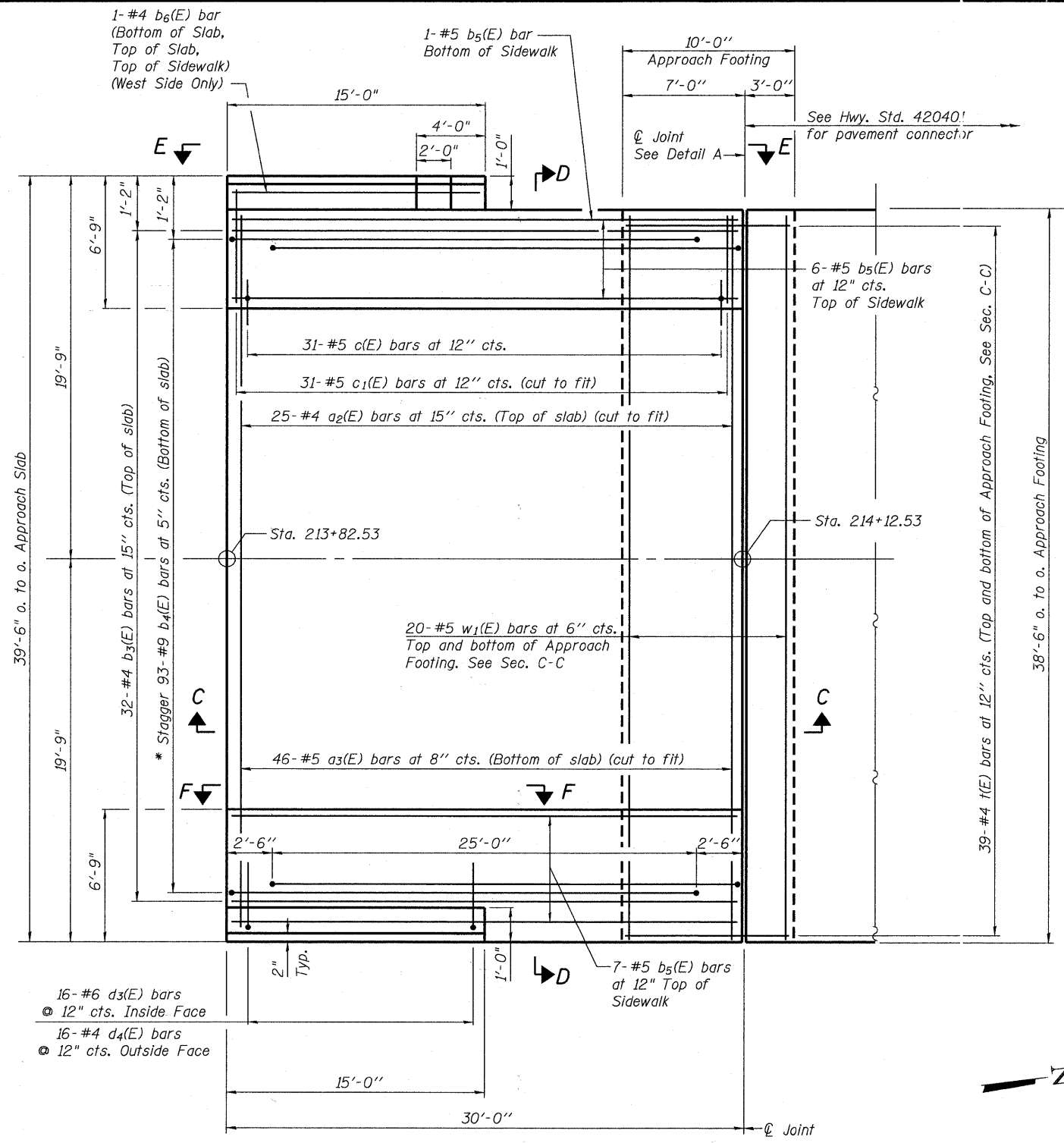

**PLAN**

\* Tilt #9 b4(E) bars as required to maintain clearance.

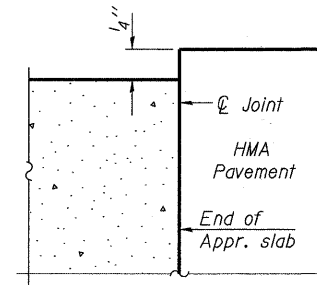

**FLEXIBLE PAVEMENT**

**DETAIL A**

FILE NAME = M:\755-010 BLVIN Phase II\CADD\_Sheets\Structure\755-010\_SHT-11.S - N APPR PAV DETAILS.dgn

(Sheet 2 of 3)



USER NAME = gonzalo	DESIGNED - SRT	REVISED -
PLOT SCALE =	CHECKED - JJI	REVISED -
PLOT DATE = 3/25/2011	DRAWN - GM	REVISED -
	CHECKED - JJI	REVISED -

**McHENRY COUNTY**  
**DIVISION OF TRANSPORTATION**  
**BLVIN STREET OVER NIPPERSINK CREEK**

**NORTH BRIDGE APPROACH SLAB PLAN**  
**STRUCTURE NO. 056-3191**

F.A. RTE.	SECTION	COUNTY	TOTAL SHEETS	SHEET NO.
	08-00355-00-BR	MCHENRY	69	36
			CONTRACT NO. 63583	
ILLINOIS FED. AID PROJECT				

SCALE: SHEET NO. 11 OF 28 SHEETS STA. TO STA.