

CONTRACTOR IS TO PROVIDE FULL DEPTH SAW CUTS AT THE LIMITS OF PAVEMENT AND SIDEWALK REMOVAL. THE COST OF FULL DEPTH SAW CUT IS INCLUDED IN THE UNIT PRICES OF PAVEMENT AND SIDEWALK REMOVAL.

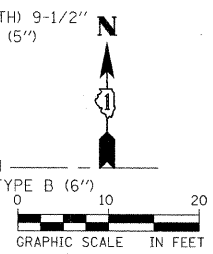

DATE	
BY	
REVISIONS	
NO.	
DESCRIPTION	
DATE	
BY	
DATE	
BY	
DATE	

DATE	
BY	
REVISIONS	
NO.	
DESCRIPTION	
DATE	
BY	
DATE	
BY	
DATE	

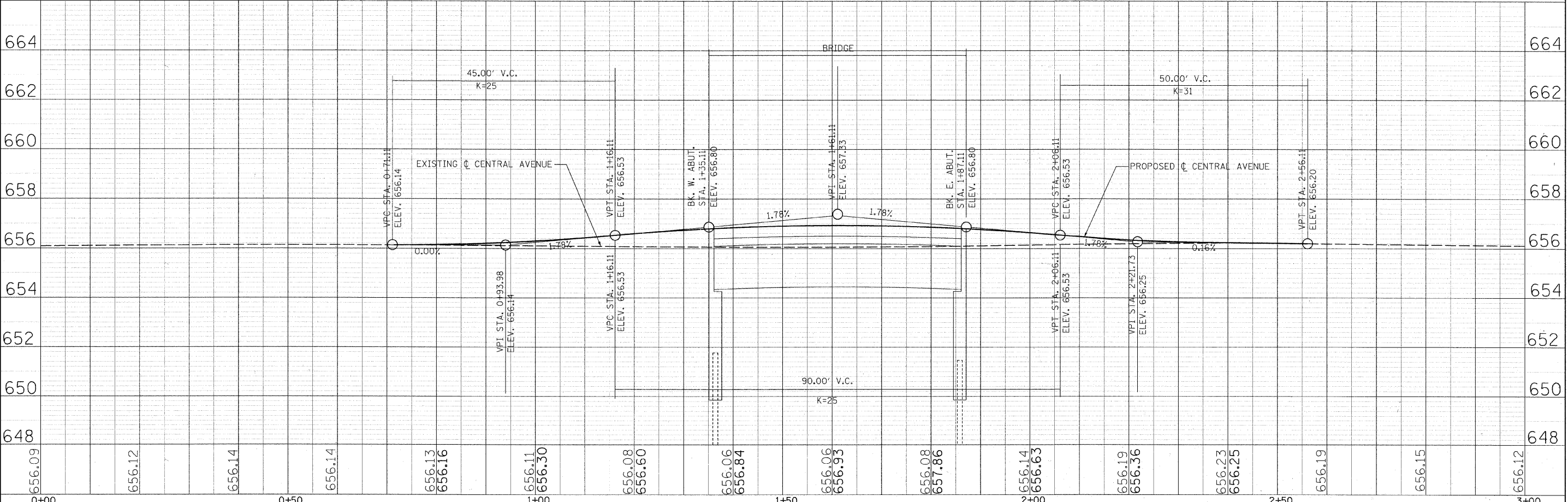
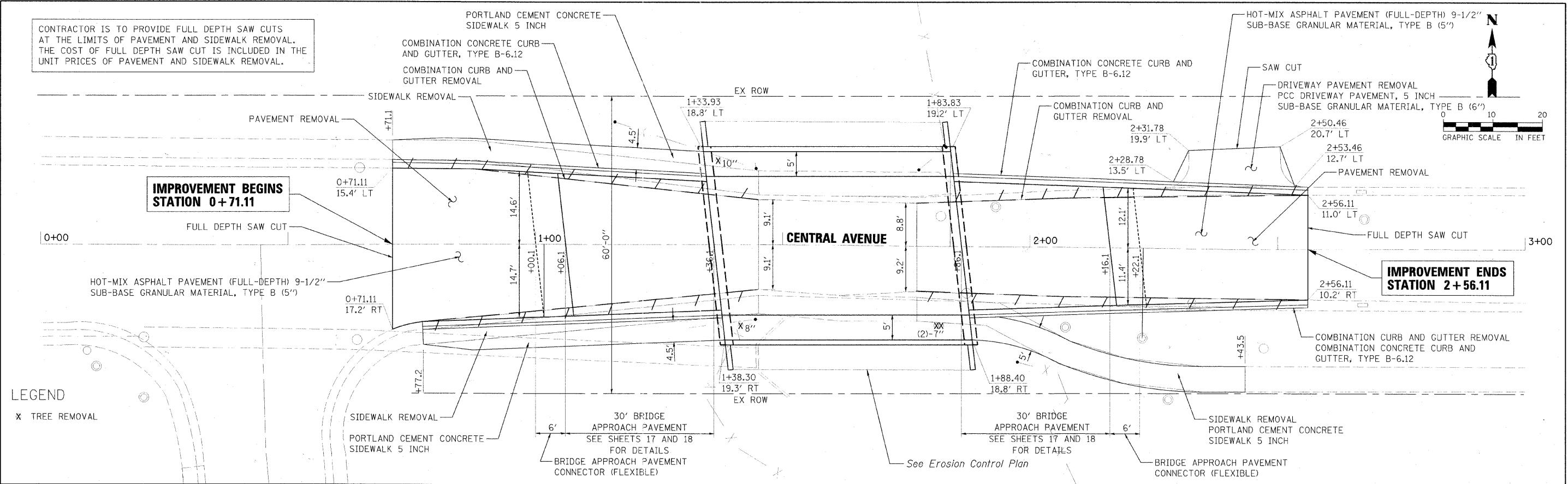

656.09	656.12	656.14	656.14	656.13	656.16	656.11	656.30	656.08	656.60	656.06	656.84	656.06	656.93	656.08	657.86	656.14	656.63	656.19	656.36	656.23	656.25	656.19	656.15	656.12
0+00		0+50		1+00		1+50		2+00		2+50		3+00												

**URS**  
100 S. WACKER DR., SUITE 500  
CHICAGO, IL 60606  
TEL 312-939-1000  
FAX 312-939-4198

USER NAME = #USER#	DESIGNED -	REVISED -
PLOT SCALE = #SCALE#	DRAWN -	REVISED -
PLOT DATE = #DATE#	CHECKED -	REVISED -
	DATE -	REVISED -

**VILLAGE OF DEERFIELD  
CENTRAL AVENUE OVER THE WEST FORK,  
NORTH BRANCH OF THE CHICAGO RIVER**

**ROADWAY PLAN AND PROFILE**  
SCALE: 1" = 10'-0"  
SHEET NO. 5 OF 22 SHEETS  
STA. 0+71.11 TO STA. 2+56.11

F.A.U. RTE.	SECTION	COUNTY	TOTAL SHEET NO.
	09-00085-00-BR	LAKE	22
CONTRACT NO. 63584			5
FED. ROAD DIST. NO. ILLINOIS FED. AID PROJECT			