

- PLAN LEGEND:**
- [ADJ] MANHOLES, CATCH BASINS AND WATER VALVES TO BE ADJUSTED
 - [REC] MANHOLES TO BE RECONSTRUCTED
 - * WITH NEW TYPE 1 FRAME, CLOSED LID
 - ** WITH NEW TYPE 1 FRAME, OPEN LID
 - [R] REMOVING MANHOLES OR CATCH BASINS
 - //// STORM SEWER REMOVAL
 - T.B.F. TRENCH BACKFILL

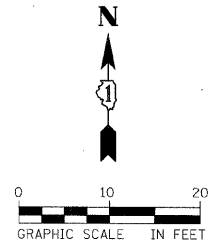

DATE: _____ BY: _____
 PLAN: _____
 REVISIONS: _____
 NO. _____ DATE _____

DATE: _____ BY: _____
 PROFILE: _____
 REVISIONS: _____
 NO. _____ DATE _____

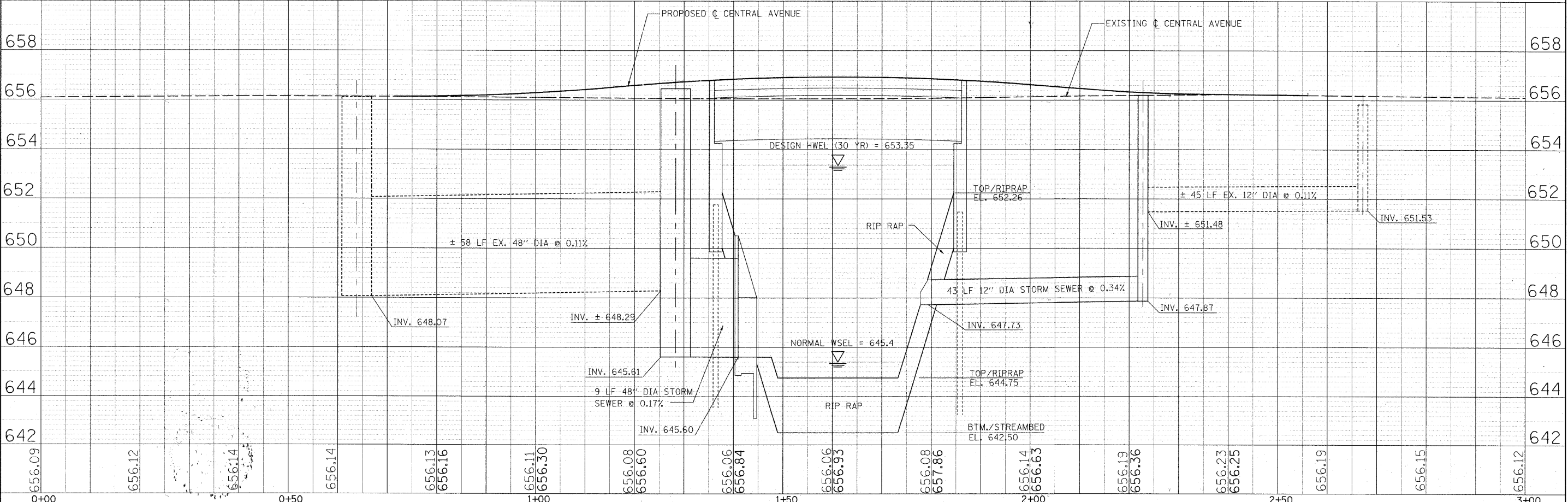
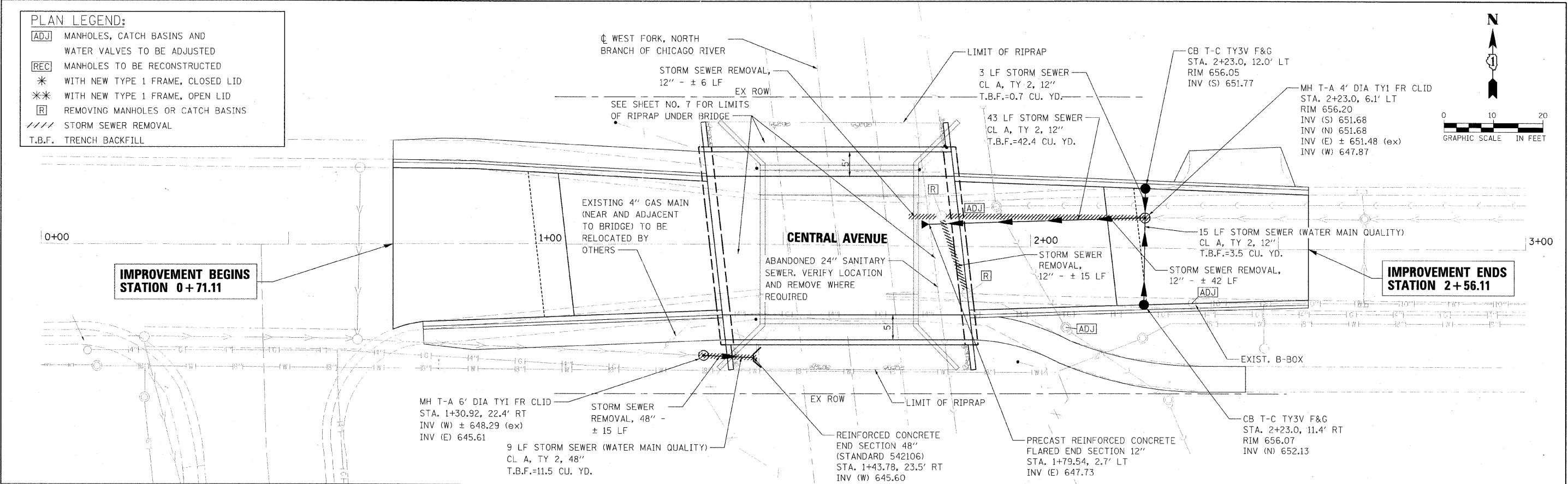

URS 100 S. WACKER DR. SUITE 500 CHICAGO, IL 60606 TEL (312) 939-1000 FAX (312) 939-4198	USER NAME: RUSIGER	DESIGNED: _____	REVISED: _____	VILLAGE OF DEERFIELD CENTRAL AVENUE OVER THE WEST FORK, NORTH BRANCH OF THE CHICAGO RIVER	DRAINAGE AND UTILITY PLAN	SECTION: 09-00085-00-BR	COUNTY: LAKE	TOTAL SHEETS: 22	SHEET NO.: 8
FILE NAME: _____	PLOT SCALE: 1"=40'	CHECKED: _____	REVISED: _____	SCALE: 1"=10'-0"	SHEET NO. 8 OF 22 SHEETS	CONTRACT NO. 63584		FED. ROAD DIST. NO. ILLINOIS FED. AID PROJECT	
	PLOT DATE: _____	DATE: _____	REVISED: _____	STA. 0+71.11	TO STA. 2+56.11				