

THE TRAFFIC SIGNAL CONTROL EQUIPMENT FOR THIS PROJECT SHALL BE SIEMENS EAGLE COMPATIBLE IN COMPLIANCE WITH THE COUNTY'S EXISTING ATMS

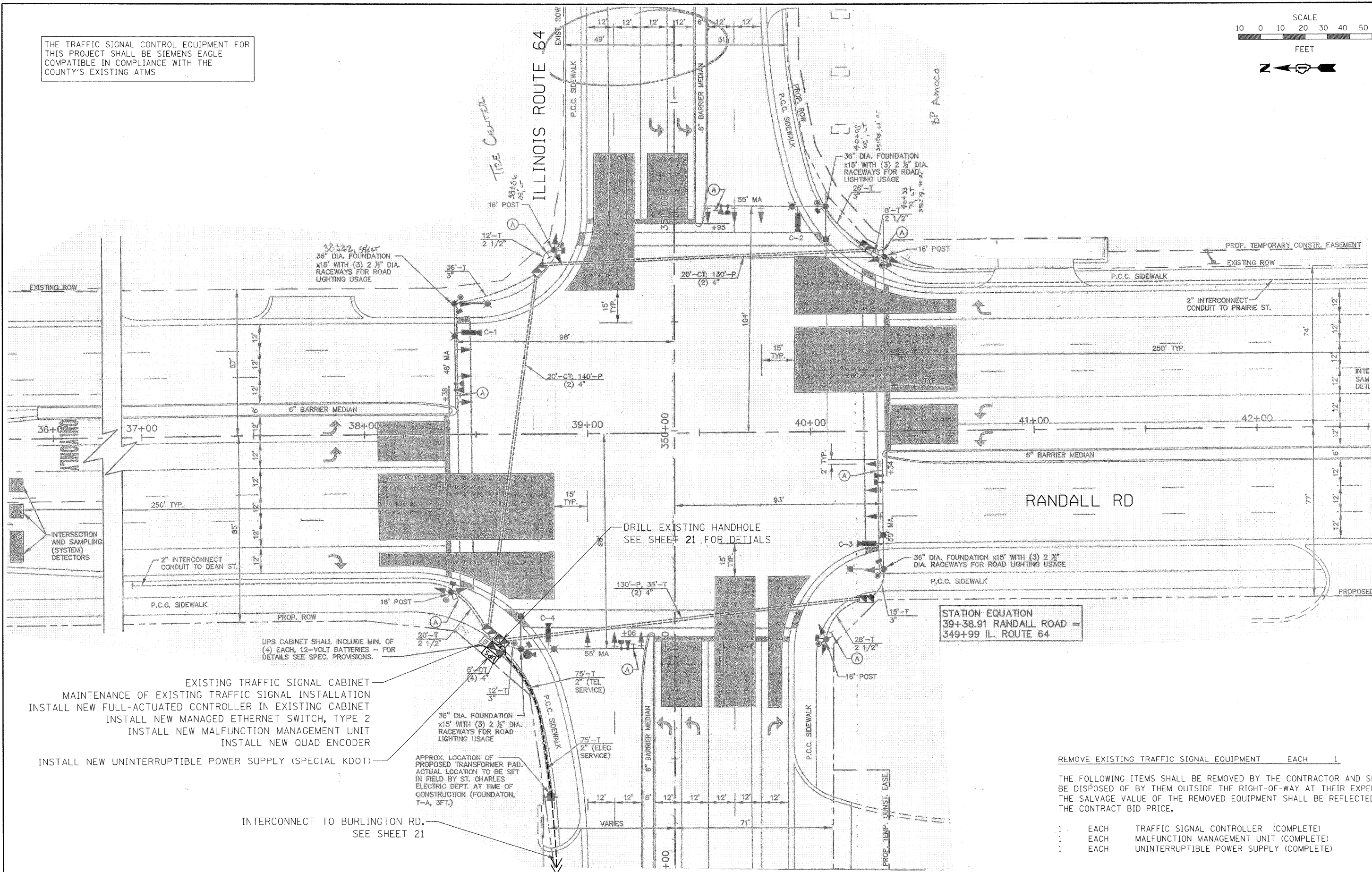
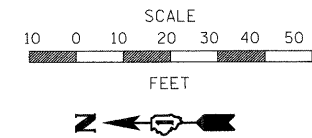

- EXISTING TRAFFIC SIGNAL CABINET MAINTENANCE OF EXISTING TRAFFIC SIGNAL INSTALLATION
- INSTALL NEW FULL-ACTUATED CONTROLLER IN EXISTING CABINET
- INSTALL NEW MANAGED ETHERNET SWITCH, TYPE 2
- INSTALL NEW MALFUNCTION MANAGEMENT UNIT
- INSTALL NEW QUAD ENCODER
- INSTALL NEW UNINTERRUPTIBLE POWER SUPPLY (SPECIAL KDOT)

INTERCONNECT TO BURLINGTON RD. SEE SHEET 21

REMOVE EXISTING TRAFFIC SIGNAL EQUIPMENT EACH 1

THE FOLLOWING ITEMS SHALL BE REMOVED BY THE CONTRACTOR AND SHALL BE DISPOSED OF BY THEM OUTSIDE THE RIGHT-OF-WAY AT THEIR EXPENSE. THE SALVAGE VALUE OF THE REMOVED EQUIPMENT SHALL BE REFLECTED IN THE CONTRACT BID PRICE.

- 1 EACH TRAFFIC SIGNAL CONTROLLER (COMPLETE)
- 1 EACH MALFUNCTION MANAGEMENT UNIT (COMPLETE)
- 1 EACH UNINTERRUPTIBLE POWER SUPPLY (COMPLETE)

FILE NAME =	USER NAME = #USER#	DESIGNED - -	REVISED -	<b>STATE OF ILLINOIS DEPARTMENT OF TRANSPORTATION</b>	<b>TRAFFIC SIGNAL PLAN IL 64 &amp; RANDALL ROAD</b>			F.A.P. RTE.	SECTION	COUNTY	TOTAL SHEETS	SHEET NO.
#FILE#		DRAWN - -	REVISED -		VARIES	08-00389-00-TL	KANE	28	9			
	PLOT SCALE = #SCALE#	CHECKED - -	REVISED -		SCALE: 1" = 50'			SHEET NO. ___ OF ___ SHEETS STA. _____ TO STA. _____			CONTRACT NO. 63,594	
	PLOT DATE = #DATE#	DATE - -	REVISED -		ILLINOIS FED. AID PROJECT							