

CONSTRUCTION NOTES:

- (A) EXISTING AT&T CONDUIT. CONTRACTOR SHALL COORDINATE WITH AT&T BEFORE CONSTRUCTION.
- (B) PLACE NEW CONDUIT AS CLOSE TO THE EXISTING R.O.W. AS POSSIBLE.
- (C) CONTRACTOR SHALL COORDINATE WITH KANE COUNTY DIVISION OF TRANSPORTATION BEFORE CONSTRUCTION.

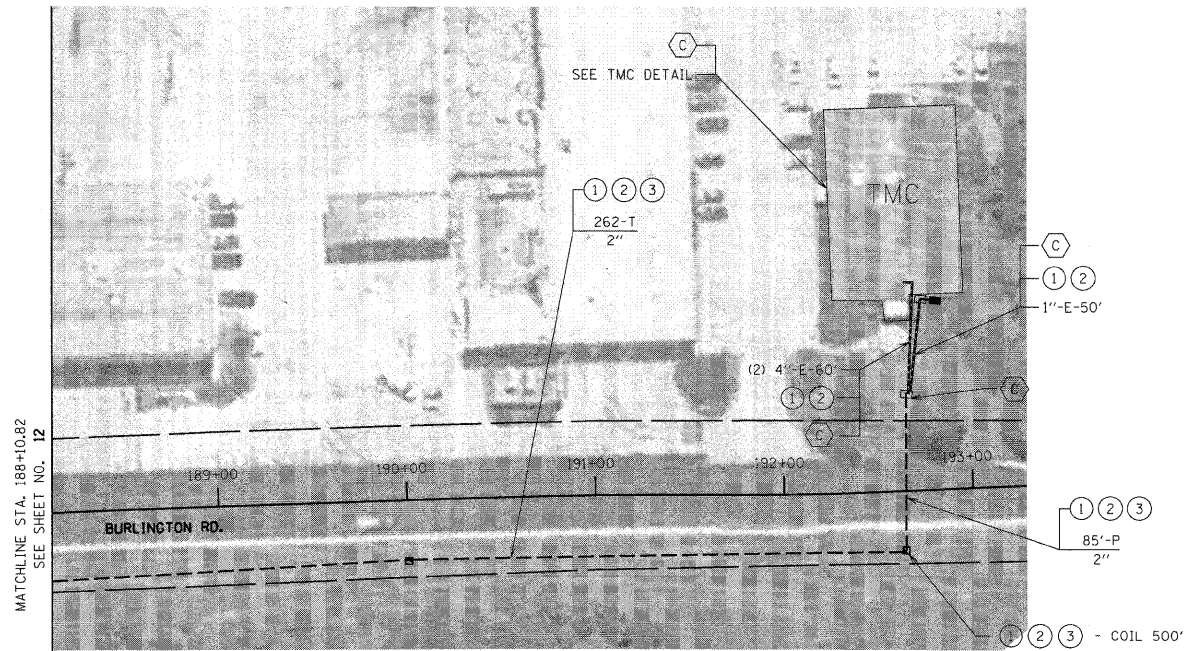

SCALE: 1" = 50'

NOTES:

- (1) PROPOSED FIBER OPTIC CABLE IN CONDUIT, SM36F
- (2) PROPOSED FIBER OPTIC CABLE IN CONDUIT, SM144F
- (3) PROPOSED ELECTRIC CABLE IN CONDUIT, TRACER, NO. 14 IC
- (4) TERMINATE FIBERS AT DISTRIBUTION ENCLOSURE IN CABINET
- (5) SPLICE FIBERS DISTRIBUTION ENCLOSURE IN CABINET
- (6) COIL FIBER OPTIC CABLE SLACK AND TRACER IN HANDHOLE

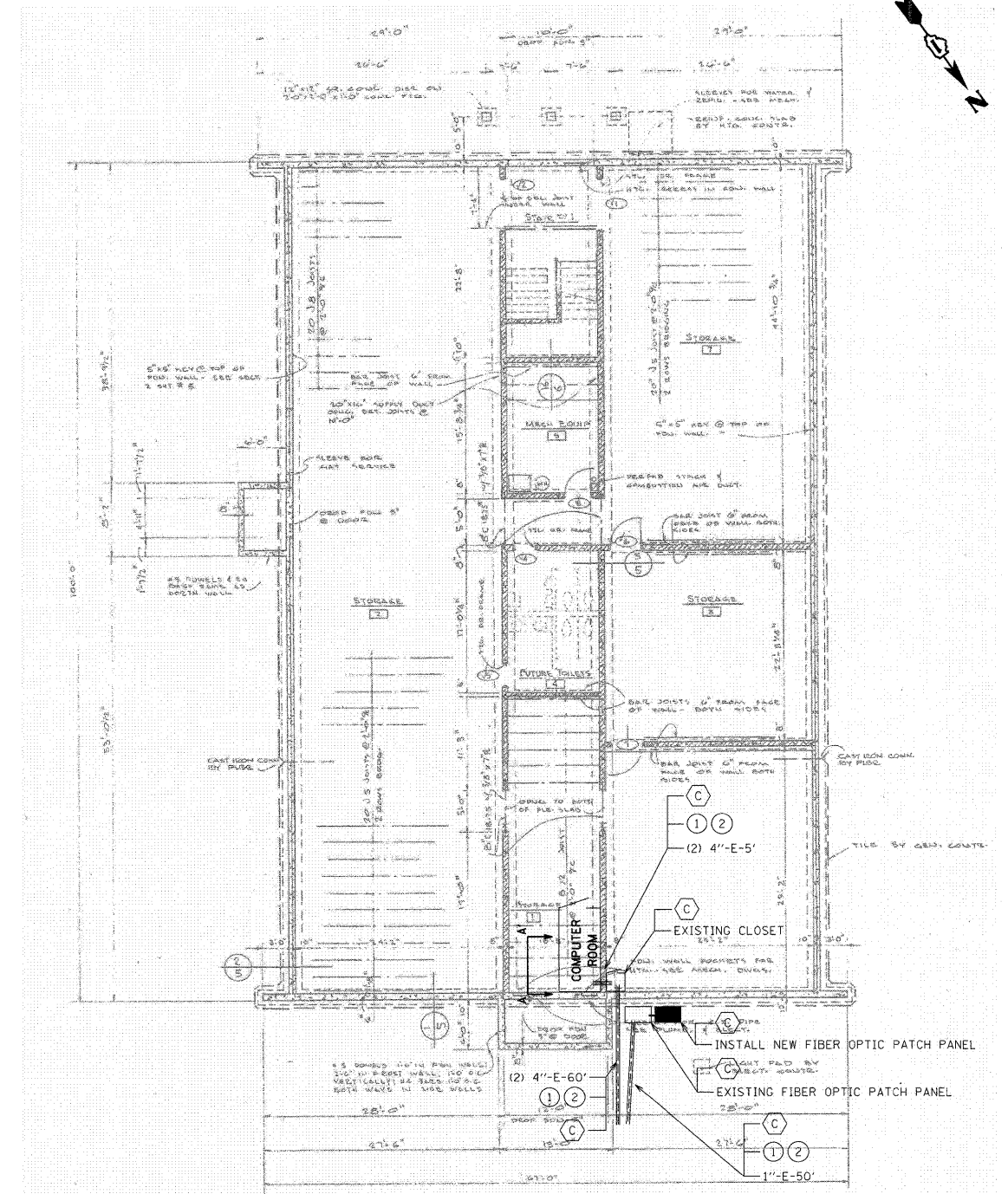
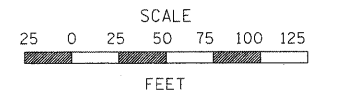

TMC DETAIL
TMC BASEMENT, FOOTING, AND FOUNDATION PLAN
SCALE: N.T.S.

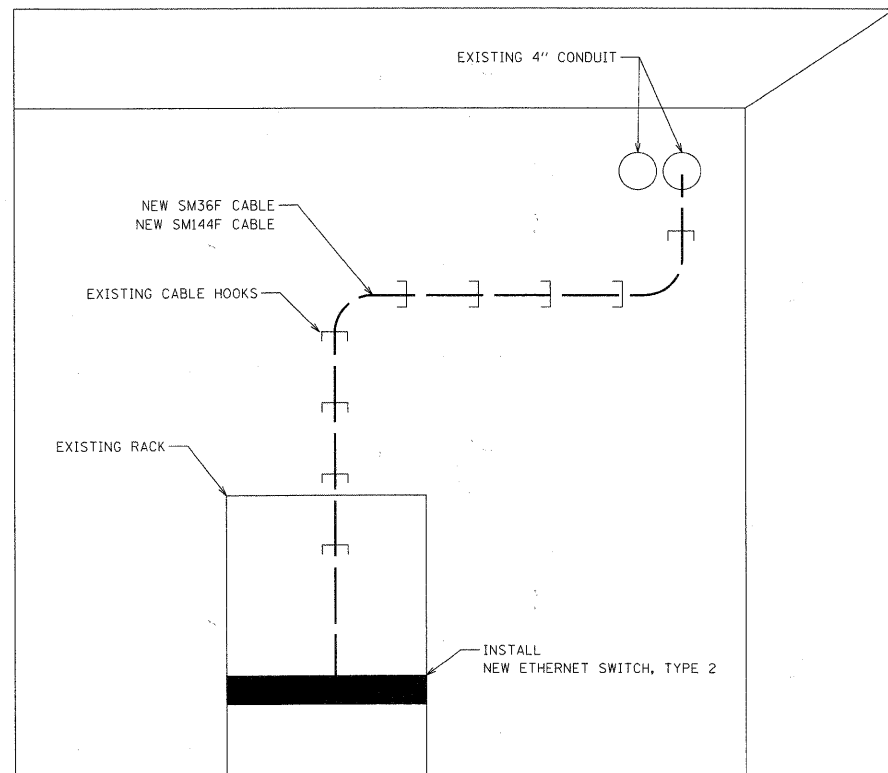

DETAIL A-A'
TMC BASEMENT COMPUTER ROOM
SCALE: N.T.S.

FILE NAME = #FILE#	USER NAME = #USER#	DESIGNED - DG	REVISED -	STATE OF ILLINOIS DEPARTMENT OF TRANSPORTATION	BURLINGTON ROAD FROM IL 64 TO TMC		F.A.P. RTE.	SECTION	COUNTY	TOTAL SHEETS	SHEET NO.
	PLOT SCALE = #SCALE#	DRAWN - JM	REVISED -		VARIES	08-00389-00-TL	KANE	28	14		
	PLOT DATE = #DATE#	CHECKED - DB	REVISED -		SCALE: 1" = 50' SHEET NO. 4 OF 4 SHEETS STA. 188+10.82 TO STA. 193+00		CONTRACT NO. 63594		ILLINOIS FED. AID PROJECT		
		DATE - 04/11/2011	REVISED -								