

PROPOSED TYPICAL SECTION-51ST STREET
 STA. 0+68.90 (FAIRL ELMS AVE.) TO STA. 4+97.60 (CENTRAL AVE.)
 (SECTION LOOKING EAST)

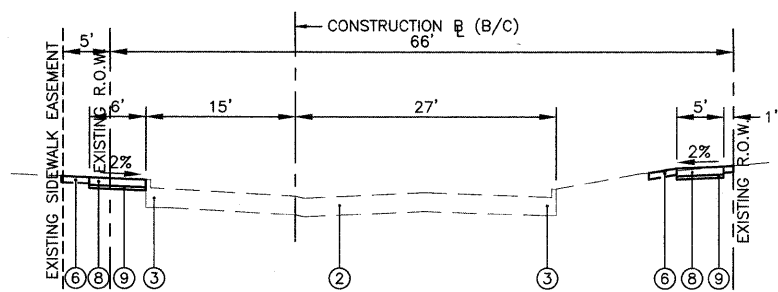

PROPOSED TYPICAL SECTION-53RD STREET
 STA. 40+66.20 (LAWN AVE.) TO STA. 45+00.00 (WOLF RD.)
 (SECTION LOOKING EAST)

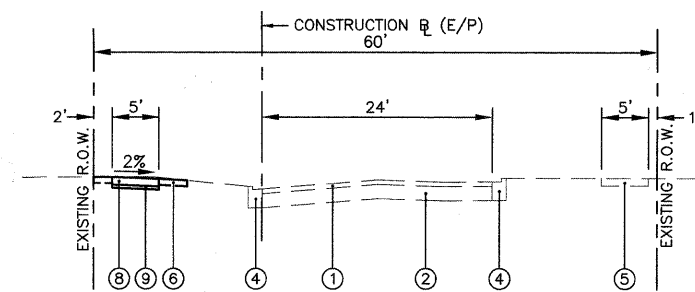

PROPOSED TYPICAL SECTION-53RD STREET
 STA. 45+00.00 (WOLF RD.) TO STA. 50+48.40 (CAROLINE AVE.)
 (SECTION LOOKING EAST)

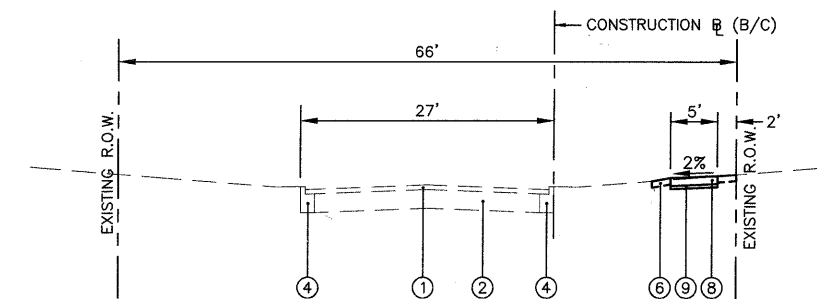

PROPOSED TYPICAL SECTION-49TH STREET
 STA. 9+73.10 (FAIRL ELMS AVE.) TO STA. 12+09.90
 (SECTION LOOKING EAST)

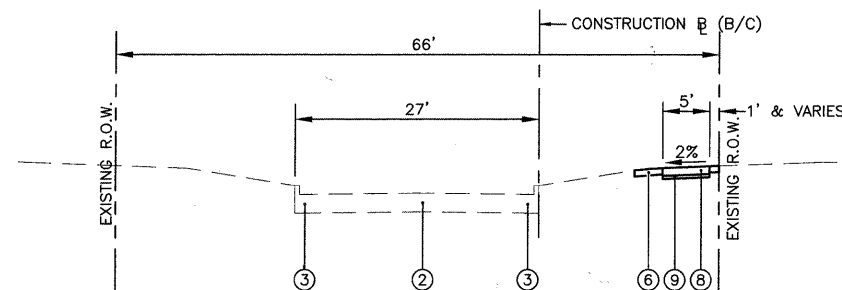

PROPOSED TYPICAL SECTION-FAIR ELMS AVENUE
 STA. 19+67.60 (51ST STREET) TO STA. 33+61.00 (49TH STREET)
 (SECTION LOOKING NORTH)

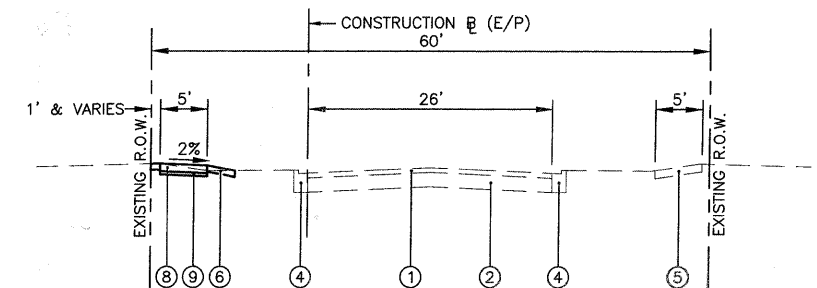

PROPOSED TYPICAL SECTION-CAROLINE AVENUE
 STA. 60+25.30 (53RD ST.) TO STA. 67+84.70 (HOWARD AVE.)
 (SECTION LOOKING NORTH)

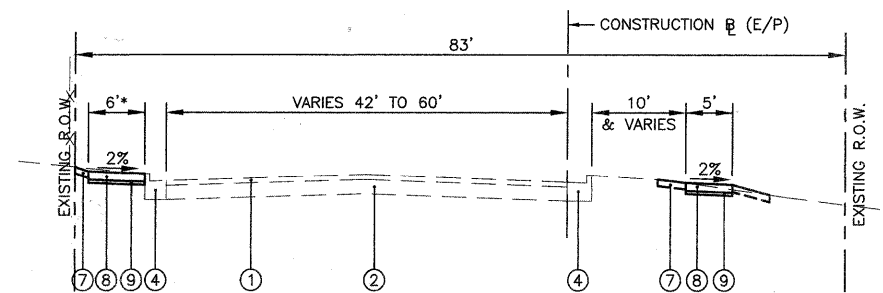

PROPOSED TYPICAL SECTION-55TH STREET
 STA. 80+09.00 (WOODLAND AVE.) TO STA. 92+91.40 (WOLF RD.)
 (SECTION LOOKING EAST)

LEGEND

- ① EXISTING HOT-MIX ASPHALT SURFACE COURSE, THICKNESS VARIES
- ② EXISTING P.C.C. PAVEMENT, THICKNESS VARIES
- ③ EXISTING CONCRETE CURB AND GUTTER (MONOLITHIC WITH PAVEMENT)
- ④ EXISTING CONCRETE CURB AND GUTTER
- ⑤ EXISTING CONCRETE SIDEWALK
- ⑥ SODDING, SPECIAL
(INCLUDES 4" PULVERIZED TOP SOIL AND FERTILIZER)
(AT LOCATIONS DESIGNATED BY THE ENGINEER)
- ⑦ SODDING, SALT TOLERANT (SPECIAL)
(INCLUDES 4" PULVERIZED TOP SOIL AND FERTILIZER)
(AT LOCATIONS DESIGNATED BY THE ENGINEER)
- ⑧ PORTLAND CEMENT CONCRETE SIDEWALK 5"
(AT ENTRANCES, THE SIDEWALK SHALL BE INCREASED TO THE THICKNESS OF THE DRIVEWAY PAVEMENT, COST INCLUDED IN P.C.C. SIDEWALK 5")
- ⑨ SUB-BASE GRANULAR MATERIAL, TYPE B 2"
(COST INCLUDED IN P.C.C. SIDEWALK 5")

HOT-MIX ASPHALT MIXTURE REQUIREMENTS

MIXTURE TYPE	VOIDS
DRIVEWAYS	
HOT-MIX ASPHALT BASE COURSE, 5" (HMA BINDER IL-19mm) (IN 2 LIFTS)	4% @ 50 Gyr.
HOT-MIX ASPHALT SURFACE COURSE, MIX "C" NS0, 2" (IL-9.5mm)	4% @ 50 Gyr.
PATCHING	
CLASS D PATCHES, 2" (HMA BINDER IL-19mm)	4% @ 70 Gyr.

NOTE: 1) THE UNIT WEIGHT USED TO CALCULATE ALL HMA QUANTITIES IS 112 LB/SY/IN
 2) THE "AC TYPE" FOR POLYMERIZED HMA MIXES SHALL BE "SBS/SBR PG 70-22" AND FOR NON-POLYMERIZED HMA THE "AC TYPE" SHALL BE "PG 64-22" UNLESS MODIFIED BY DISTRICT ONE SPECIAL PROVISIONS. FOR "PERCENT OF RAP" SEE DISTRICT ONE SPECIAL PROVISIONS.

FILE NAME =	USER NAME =	DESIGNED -- BDH	REVISED --
		DRAWN -- SMP	REVISED --
	PLOT SCALE =	CHECKED -- BDH	REVISED --
	PLOT DATE =	DATE -- 02-09-11	REVISED --

**STATE OF ILLINOIS
 DEPARTMENT OF TRANSPORTATION**

**TYPICAL SECTIONS
 VARIOUS ROUTES**

SCALE: NONE SHEET NO. 5 OF 25 SHEETS STA. _____ TO STA. _____

JJB JAMES J. BENES & ASSOCIATES, INC. 950 Warrenville Road, Suite 101, Lisle, Illinois 60532 Tel. (630) 719-7570 • Fax (630) 719-7589				
F.A.U. RTE.	SECTION	COUNTY	TOTAL SHEETS	SHEET NO.
1504	09-00090-00-SW	COOK	25	5
			CONTRACT NO. 6.3596	
ILLINOIS FED. AID PROJECT				