

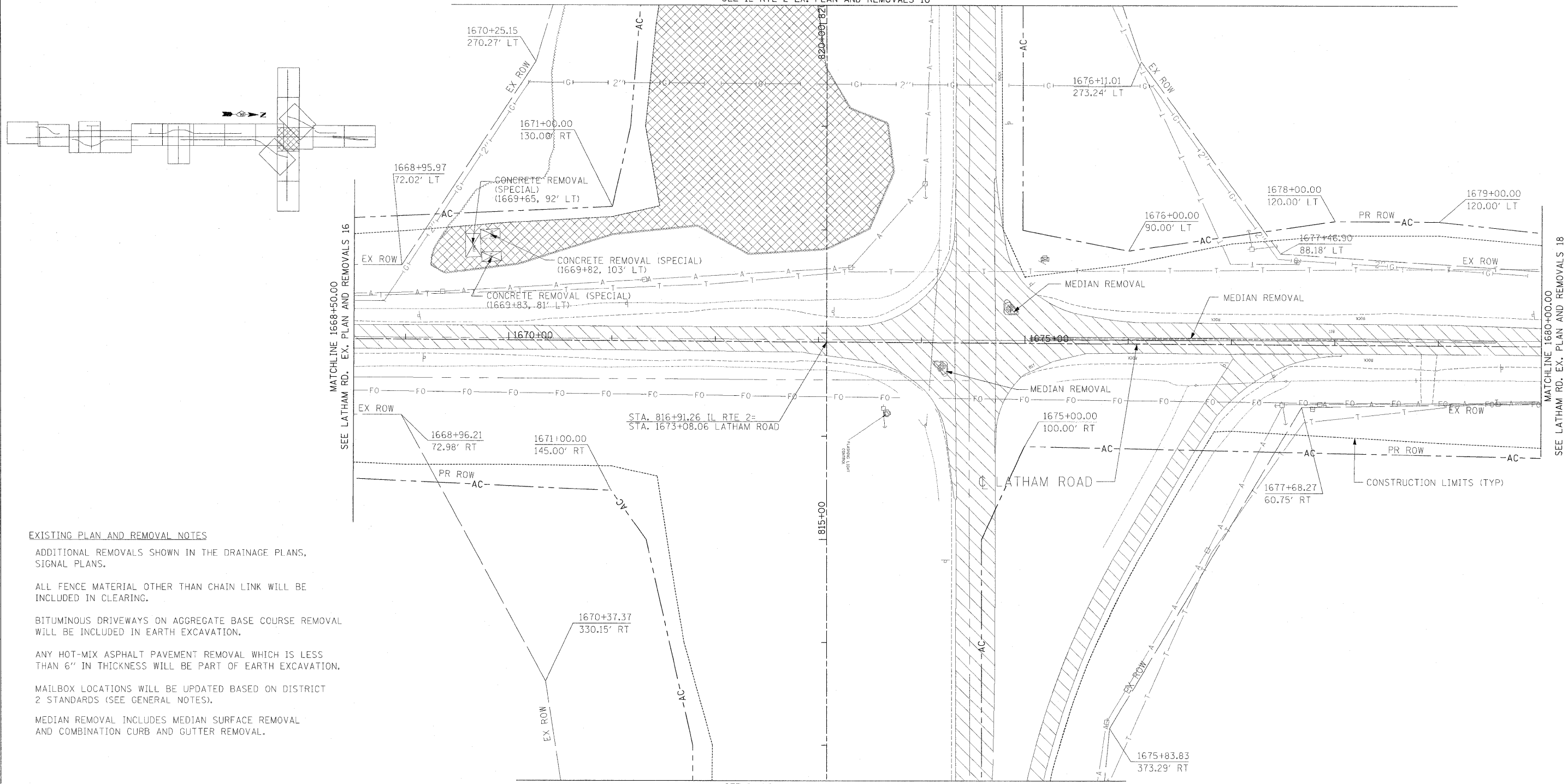

SEE IL RTE 2 EX. PLAN AND REMOVALS 10



MATCHLINE 1668+50.00  
SEE LATHAM RD. EX. PLAN AND REMOVALS 16

MATCHLINE 1680+00.00  
SEE LATHAM RD. EX. PLAN AND REMOVALS 18

SEE IL RTE 2 EX. PLAN AND REMOVALS 9

**EXISTING PLAN AND REMOVAL NOTES**

ADDITIONAL REMOVALS SHOWN IN THE DRAINAGE PLANS, SIGNAL PLANS.

ALL FENCE MATERIAL OTHER THAN CHAIN LINK WILL BE INCLUDED IN CLEARING.

BITUMINOUS DRIVEWAYS ON AGGREGATE BASE COURSE REMOVAL WILL BE INCLUDED IN EARTH EXCAVATION.

ANY HOT-MIX ASPHALT PAVEMENT REMOVAL WHICH IS LESS THAN 6" IN THICKNESS WILL BE PART OF EARTH EXCAVATION.

MAILBOX LOCATIONS WILL BE UPDATED BASED ON DISTRICT 2 STANDARDS (SEE GENERAL NOTES).

MEDIAN REMOVAL INCLUDES MEDIAN SURFACE REMOVAL AND COMBINATION CURB AND GUTTER REMOVAL.

**STATE OF ILLINOIS  
DEPARTMENT OF TRANSPORTATION**

ILLINOIS ROUTE 2  
EXISTING PLAN AND REMOVALS 17  
LATHAM RD STA 1668+50 TO STA 1680+00

SCALE: 1"=50' SHEET NO. 68 OF 530 SHEETS STA. TO STA.

F.A.P. RTE.	SECTION	COUNTY	TOTAL SHEETS	SHEET NO.
734	77-2-2 & 77-2B-1	WINNEBAGO	530	68
CONTRACT NO. 64813				
FED. ROAD DIST. NO.		ILLINOIS FED. AID PROJECT		

USER NAME = zulkowd	DESIGNED STS/GC	REVISED -
PLOT SCALE = 50.0000 FT / IN.	DRAWN RDT	REVISED -
PLOT DATE = 2/2/2011	CHECKED GC	REVISED -
	DATE 01-14-11	REVISED -

R:\work\2011\11251\segment\_1\shelton\11\removals\16764813\_shtrem-17.dgn