

**KEY**

- 1 HOT-MIX ASPHALT PAVEMENT (FULL-DEPTH), 12.5"  
SEE NOTE #3
- 2 2" HOT-MIX ASPHALT SURFACE COURSE, MIX "D", N70
- 3 10.5" HOT-MIX ASPHALT BINDER COURSE, IL-19.0, N70
- 4 HOT-MIX ASPHALT SURFACE COURSE, MIX "C", N50
- 5 HOT-MIX ASPHALT SHOULDERS
- 6 SUB-BASE GRANULAR MATERIAL, TYPE A
- 7 AGGREGATE SHOULDERS, TYPE A
- 8 INCIDENTAL HOT-MIX ASPHALT SURFACING  
(2" AT DRIVEWAYS)
- 9 COMBINATION CONCRETE CURB & GUTTER, TYPE M-4.24
- 10 COMBINATION CONCRETE CURB & GUTTER, TYPE M-4.06
- 11 CONCRETE MEDIAN SURFACE, 4" OR CONCRETE MEDIAN, TYPE SM-4.24
- 12 TOPSOIL FURNISH AND PLACE, 6" OR 12"
- 13 AGGREGATE BASE COURSE, TYPE B
- 14 PIPE UNDERDRAIN, 4"
- 15 AGGREGATE BASE COURSE, TYPE A (SEE SCHEDULES FOR VARIABLE THICKNESS AREAS)

**LEGEND**

- HOT-MIX ASPHALT DRIVEWAY
- AGGREGATE DRIVEWAY (AGGREGATE BASE COURSE, TYPE B, 8")
- HOT-MIX ASPHALT SURFACE COURSE OVER EX. PAVEMENT

**NOTES**

1. DRIVEWAYS ARE AT 90° ANGLE TO C ROADWAY UNLESS OTHERWISE SHOWN.
2. ALL DIMENSIONS SHOWN EOP-TO-EOP UNLESS OTHERWISE NOTED.
3. PROPOSED HOT-MIX ASPHALT SHOULDERS IN AREA OF RETURNS AND ADJACENT TO RIGHT-TURN LANE TO BE 4.0' IN WIDTH.
4. LAYOUT OF ALL DRIVEWAYS AND MAILBOX RETURNS, AS WELL AS MAILBOX TURNOUTS SHALL COMPLY WITH ILLINOIS DISTRICT 2 STANDARD 20.1
5. REFER TO PROPOSED ALIGNMENT SHEETS 1 THRU 5 FOR ALL ALIGNMENT INFORMATION.
6. SEE DRAINAGE DETAIL SHEETS AND CULVERT PLANS FOR RELATED DRAINAGE ITEMS.
7. CORNER ISLANDS TO BE CONSTRUCTED IN ACCORDANCE WITH HIGHWAY STD. 606301 (PC CORNER ISLANDS & MEDIANS)
8. SEE TYPICAL SECTIONS FOR WOVEN WIRE FENCE LOCATIONS ALONG ACCESS CONTROL (AC).
9. EAST FRONTAGE RD. BASELINE (B) DOES NOT REFLECT THE EXISTING CROWLINE OF THE ROAD. IT PROVIDES A BASELINE FOR REFERENCE PURPOSES ONLY.

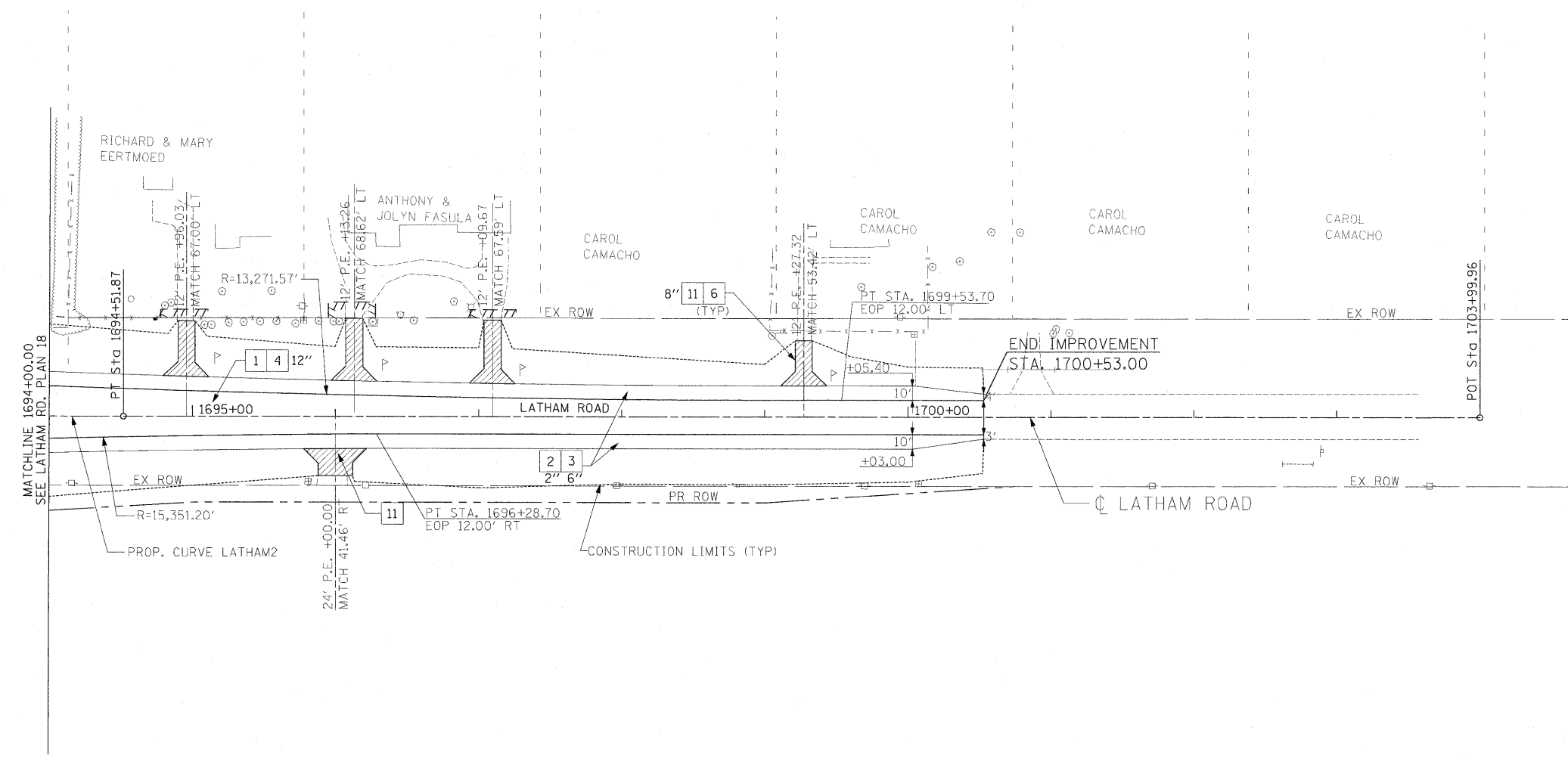

PROP. CURVE LATHAM2  
 PI STA. = 1693+11.89  
 $\Delta = 1^\circ 24' 00''$  (LT)  
 $D = 0^\circ 30' 00''$   
 $R = 11,459.16'$   
 $T = 140.00'$   
 $L = 279.98'$   
 $E = 0.86'$   
 $e = N.C.$   
 $T.R. = N/A$   
 $S.E. RUN = N/A$   
 $P.C. STA. = 1691+71.89$   
 $P.T. STA. = 1694+51.87$

USER NAME = zulkowad	DESIGNED STS/GC	REVISED -
PLOT SCALE = 50.0000 FT / IN.	DRAWN RDT	REVISED -
PLOT DATE = 2/2/2011	CHECKED GC	REVISED -
	DATE 01-14-11	REVISED -

**STATE OF ILLINOIS  
DEPARTMENT OF TRANSPORTATION**

ILLINOIS ROUTE 2		F.A.P. RTE.	SECTION	COUNTY	TOTAL SHEETS	SHEET NO.
PLAN 19		734	77-2-2 & 77-2B-1	WINNEBAGO	530	91
LATHAM RD STA 1694+00 TO STA 1700+53		SCALE: 1"=50'		CONTRACT NO. 64813		
SHEET NO. 91 OF 530 SHEETS	STA. TO STA.	FED. ROAD DIST. NO.		ILLINOIS FED. AID PROJECT		

I:\projects\1122\Assessment\Notes\Nov11\Plan\_Sheets\1064813-ahtr\plan-19.dwg