

KEY

- 1 HOT-MIX ASPHALT PAVEMENT (FULL-DEPTH), 12.5"
SEE NOTE #3
- 2 2" HOT-MIX ASPHALT SURFACE COURSE, MIX "D", N70
10.5" HOT-MIX ASPHALT BINDER COURSE, IL-19.0, N70
- 3 HOT-MIX ASPHALT SURFACE COURSE, MIX "C", N50
- 4 HOT-MIX ASPHALT SHOULDERS
- 5 SUB-BASE GRANULAR MATERIAL, TYPE A
- 6 AGGREGATE SHOULDERS, TYPE A
- 7 INCIDENTAL HOT-MIX ASPHALT SURFACING
(2" AT DRIVEWAYS)
- 8 COMBINATION CONCRETE CURB & GUTTER, TYPE M-4.24
- 9 COMBINATION CONCRETE CURB & GUTTER, TYPE M-4.06
- 10 CONCRETE MEDIAN SURFACE, 4" OR CONCRETE MEDIAN, TYPE SM-4.24
- 11 TOPSOIL FURNISH AND PLACE, 6" OR 12"
- 12 AGGREGATE BASE COURSE, TYPE B
- 13 PIPE UNDERDRAIN, 4"
- 14 AGGREGATE BASE COURSE, TYPE A (SEE SCHEDULE FOR VARIABLE THICKNESS AREAS)

LEGEND

-  HOT-MIX ASPHALT DRIVEWAY
-  AGGREGATE DRIVEWAY (AGGREGATE BASE COURSE, TYPE B, 8")
-  HOT-MIX ASPHALT SURFACE COURSE OVER EX. PAVEMENT

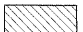
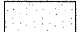
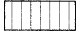
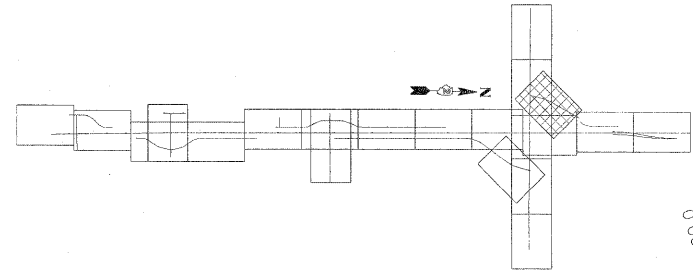
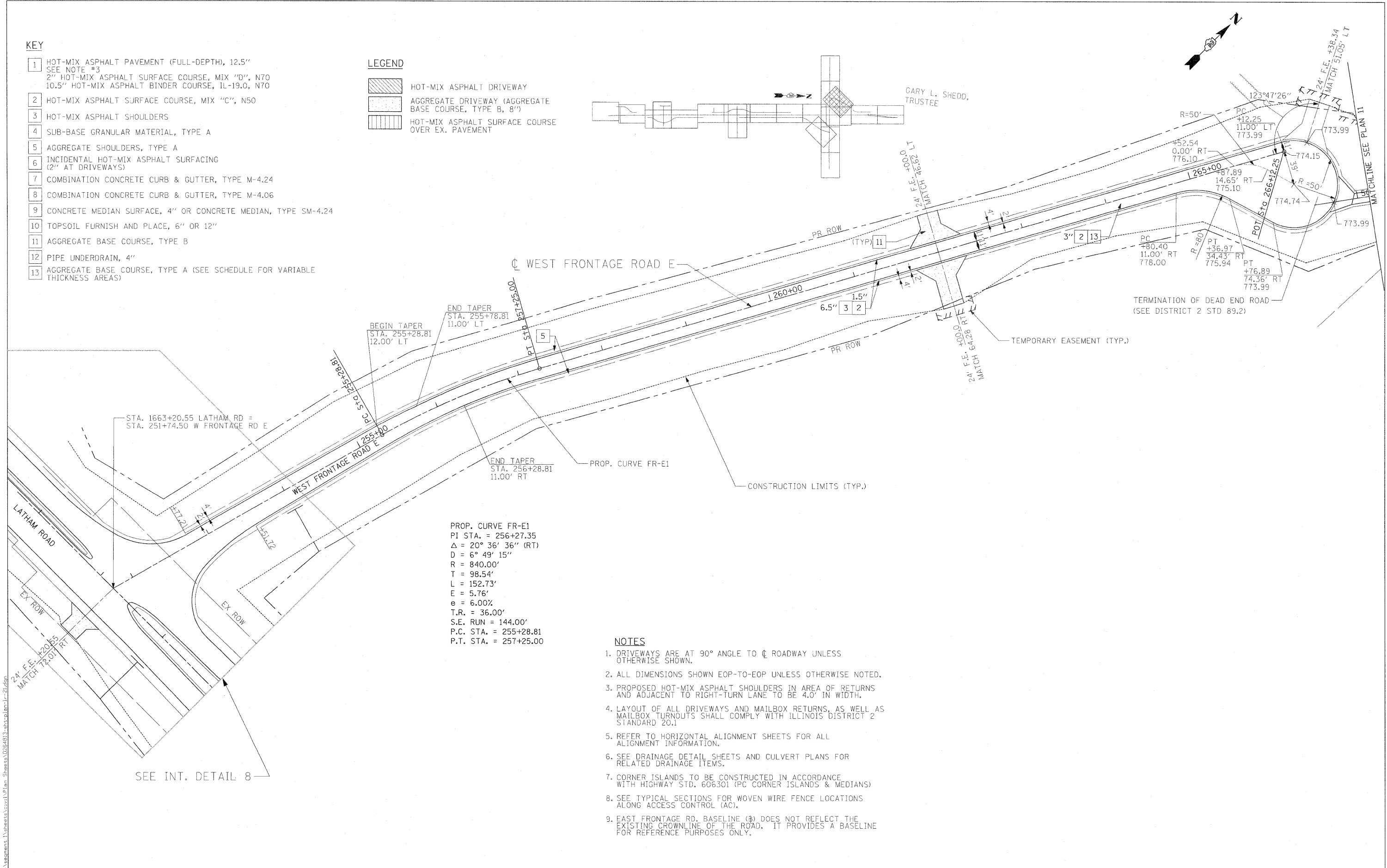

BEGIN TAPER
STA. 255+28.81
12.00' LT

END TAPER
STA. 255+78.81
11.00' LT

END TAPER
STA. 256+28.81
11.00' RT

PROP. CURVE FR-E1
PI STA. = 256+27.35
 $\Delta = 20^\circ 36' 36''$ (RT)
D = 6° 49' 15"
R = 840.00'
T = 98.54'
L = 152.73'
E = 5.76'
e = 6.00%
T.R. = 36.00'
S.E. RUN = 144.00'
P.C. STA. = 255+28.81
P.T. STA. = 257+25.00

NOTES

1. DRIVEWAYS ARE AT 90° ANGLE TO ϕ ROADWAY UNLESS OTHERWISE SHOWN.
2. ALL DIMENSIONS SHOWN EOP-TO-EOP UNLESS OTHERWISE NOTED.
3. PROPOSED HOT-MIX ASPHALT SHOULDERS IN AREA OF RETURNS AND ADJACENT TO RIGHT-TURN LANE TO BE 4.0' IN WIDTH.
4. LAYOUT OF ALL DRIVEWAYS AND MAILBOX RETURNS, AS WELL AS MAILBOX TURNOUTS SHALL COMPLY WITH ILLINOIS DISTRICT 2 STANDARD 20.1
5. REFER TO HORIZONTAL ALIGNMENT SHEETS FOR ALL ALIGNMENT INFORMATION.
6. SEE DRAINAGE DETAIL SHEETS AND CULVERT PLANS FOR RELATED DRAINAGE ITEMS.
7. CORNER ISLANDS TO BE CONSTRUCTED IN ACCORDANCE WITH HIGHWAY STD. 606301 (PC CORNER ISLANDS & MEDIANS)
8. SEE TYPICAL SECTIONS FOR WOVEN WIRE FENCE LOCATIONS ALONG ACCESS CONTROL (AC).
9. EAST FRONTAGE RD. BASELINE (ϕ) DOES NOT REFLECT THE EXISTING CROWNLIN OF THE ROAD. IT PROVIDES A BASELINE FOR REFERENCE PURPOSES ONLY.

SEE INT. DETAIL 8

USER NAME = zulkowd	DESIGNED STS/GC	REVISED -
PLOT SCALE = 50.0000 FT / IN.	DRAWN RDT	REVISED -
PLOT DATE = 2/2/2011	CHECKED GC	REVISED -
	DATE 01-14-11	REVISED -

**STATE OF ILLINOIS
DEPARTMENT OF TRANSPORTATION**

ILLINOIS ROUTE 2 PLAN 21 WEST FRONTAGE ROAD E @ LATHAM ROAD	
SCALE: 1"=50'	SHEET NO. 93 OF 530 SHEETS STA. TO STA.

F.A.P. RTE.	SECTION	COUNTY	TOTAL SHEETS	SHEET NO.
734	77-2-2 & 77-28-1	WINNEBAGO	530	93
CONTRACT NO. 64813				
FED. ROAD DIST. NO. ILLINOIS FED. AID PROJECT				

I:\projects\1125\Alignment\Notes\Civil\Plan_Sheets\0264813-ahp\p1m1r-21.dgn