

PROP. CURVE TCNEND-1
 PI STA. = 503+51.19
 $\Delta = 5^\circ 19' 54''$ (RT)
 $D = 2^\circ 47' 42''$
 $R = 2,050.00'$
 $T = 95.45'$
 $L = 190.77'$
 $E = 2.22'$
 $e = \text{N.C.}$
 $T.R. = \text{N/A}$
 $S.E. \text{ RUN} = \text{N/A}$
 $P.C. \text{ STA} = 502+55.74$
 $P.T. \text{ STA} = 504+46.51$

• CONSISTS OF:
 1 1/2" HOT-MIX ASPHALT SURFACE COURSE, MIX "C", N50
 2 1/2" HOT-MIX ASPHALT BINDER COURSE, IL-19.0, N50

LEGEND

 TEMPORARY PAVEMENT, 4"

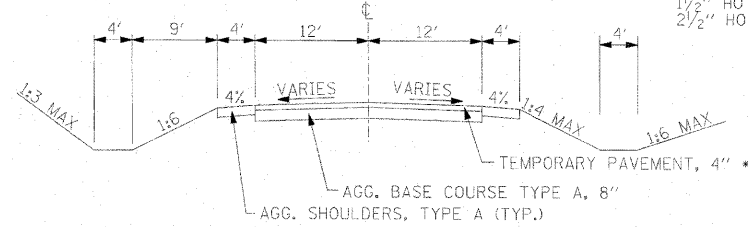

TYPICAL SECTION
 TEMPORARY ROAD
 STA. 500+00 TO STA. 515+40

PROP. CURVE TCNEND-2
 PI STA. = 512+81.24
 $\Delta = 10^\circ 16' 57''$ (RT)
 $D = 5^\circ 18' 19''$
 $R = 1,080.00'$
 $T = 97.17'$
 $L = 193.82'$
 $E = 4.36'$
 $e = \text{N.C.}$
 $T.R. = \text{N/A}$
 $S.E. \text{ RUN} = \text{N/A}$
 $P.C. \text{ STA} = 511+84.07$
 $P.T. \text{ STA} = 513+77.89$

SEE ATTACHED CROSS SECTIONS
 FOR LIMITS OF WORK

PROP. CURVE TCNEND-3
 PI STA. = 516+30.51
 $\Delta = 15^\circ 30' 42''$ (LT)
 $D = 5^\circ 18' 19''$
 $R = 1,080.00'$
 $T = 147.09'$
 $L = 292.39'$
 $E = 9.97'$
 $e = \text{N.C.}$
 $T.R. = \text{N/A}$
 $S.E. \text{ RUN} = \text{N/A}$
 $P.C. \text{ STA} = 514+83.42$
 $P.T. \text{ STA} = 517+75.81$

TEMPORARY PAVEMENT DETAIL PLAN

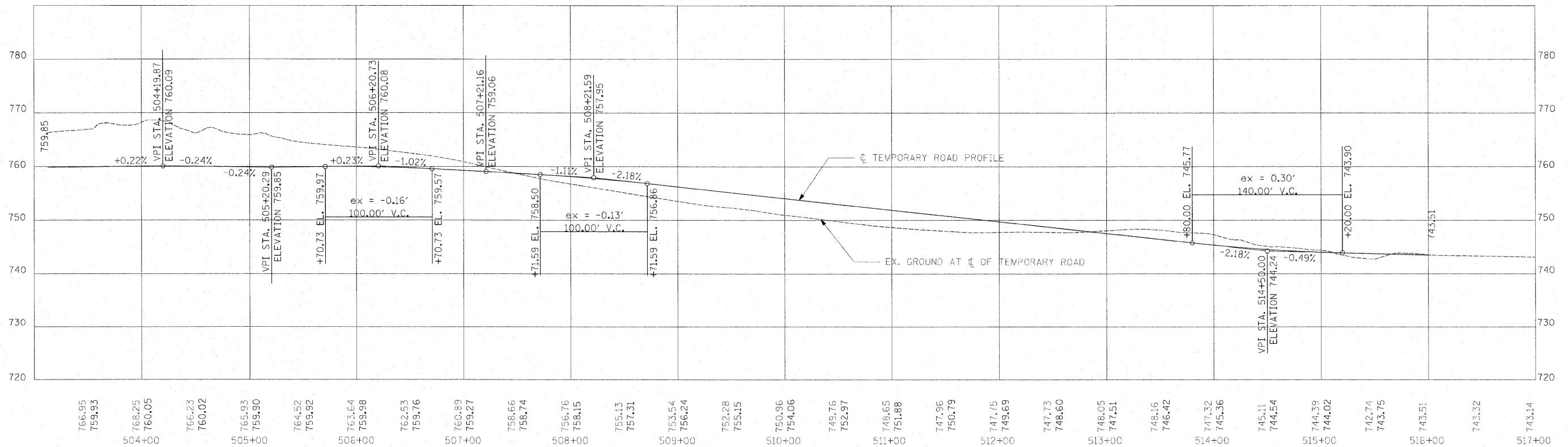

TEMPORARY PAVEMENT DETAIL PROFILE

USER NAME = zulkowad	DESIGNED STS/RDT	REVISED -
	DRAWN RDT	REVISED -
PLOT SCALE = 5/8"=200' FT / IN.	CHECKED CC	REVISED -
PLOT DATE = 2/2/2011	DATE 01-14-11	REVISED -

STATE OF ILLINOIS
 DEPARTMENT OF TRANSPORTATION

ILLINOIS ROUTE 2
 SUGGESTED STAGES OF CONSTRUCTION
 AND TRAFFIC CONTROL STAGE 1 - 12A

F.A.P. RTE. 734	SECTION 77-2-2 & 77-2B-1	COUNTY WINNEBAGO	TOTAL SHEETS 530	SHEET NO. 126
FED. ROAD DIST. NO.		ILLINOIS FED. AID PROJECT		

SCALE: 1"=50' SHEET NO. 126 OF 530 SHEETS STA. 503+00 TO STA. 517+00

I:\projects\125\Assignments\125\Traffic Control\0264082-trafficstage1-12a.dgn