

230 220 210 200 190 180 170 160 150 140 130 120 110 100 90 80 70 60 50 40 30 20 10 0 10 20 30 40 50 60

DATE	
BY	
FINAL SURVEY	
FLOTTED	
TEMPLATE	
NOTE BOOK	
AREAS CHECKED	
NO.	

DATE	
BY	
ORIGINAL SURVEY	
FLOTTED	
TEMPLATE	
NOTE BOOK	
AREAS CHECKED	
NO.	

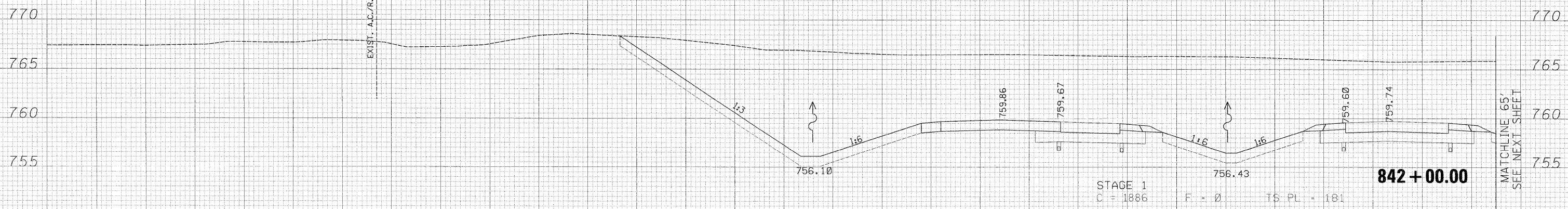
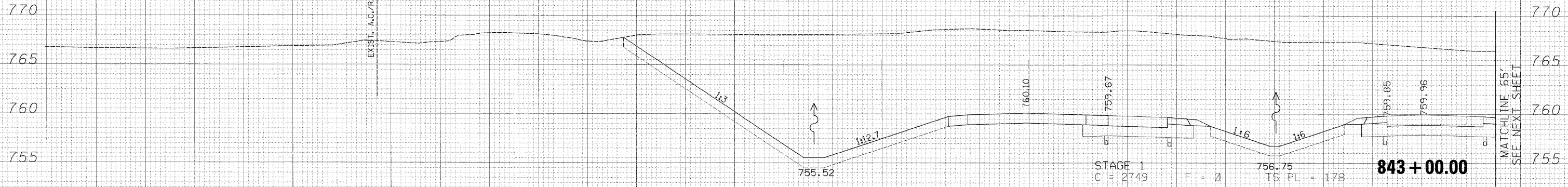

230 220 210 200 190 180 170 160 150 140 130 120 110 100 90 80 70 60 50 40 30 20 10 0 10 20 30 40 50 60

USER NAME = zuikowd	DESIGNED RDT	REVISED -
PLOT SCALE = 10,0000' / IN.	DRAWN RDT	REVISED -
PLOT DATE = 2/2/2011	CHECKED GC	REVISED -
	DATE 1-14-11	REVISED -

**STATE OF ILLINOIS  
DEPARTMENT OF TRANSPORTATION**

**ILLINOIS ROUTE 2 NORTH TRANSITION  
STAGE 1 CROSS SECTIONS**

SCALE:  $\frac{1}{4"} = 10'$  SHEET NO. 136 OF 530 SHEETS STA. 842+00.00 TO STA. 843+32.60

F.A.P. RTE. 734	SECTION 77-2-2 & 77-2B-1	COUNTY WINNEBAGO	TOTAL SHEETS 530	SHEET NO. 136
			CONTRACT NO. 64813	
ILLINOIS FED. AID PROJECT				

ii:\projects\11254\segment 1\sheet\civil\Traffic Control\0264813-sht-xssht-IL2 North Transition Stage 1.dgn