

DATE	
BY	
FINAL SURVEY	
FLIPPED	
NOTE BOOK	
AREAS CHECKED	
NO.	

DATE	
BY	
ORIGINAL SURVEY	
FLIPPED	
NOTE BOOK	
AREAS CHECKED	
NO.	

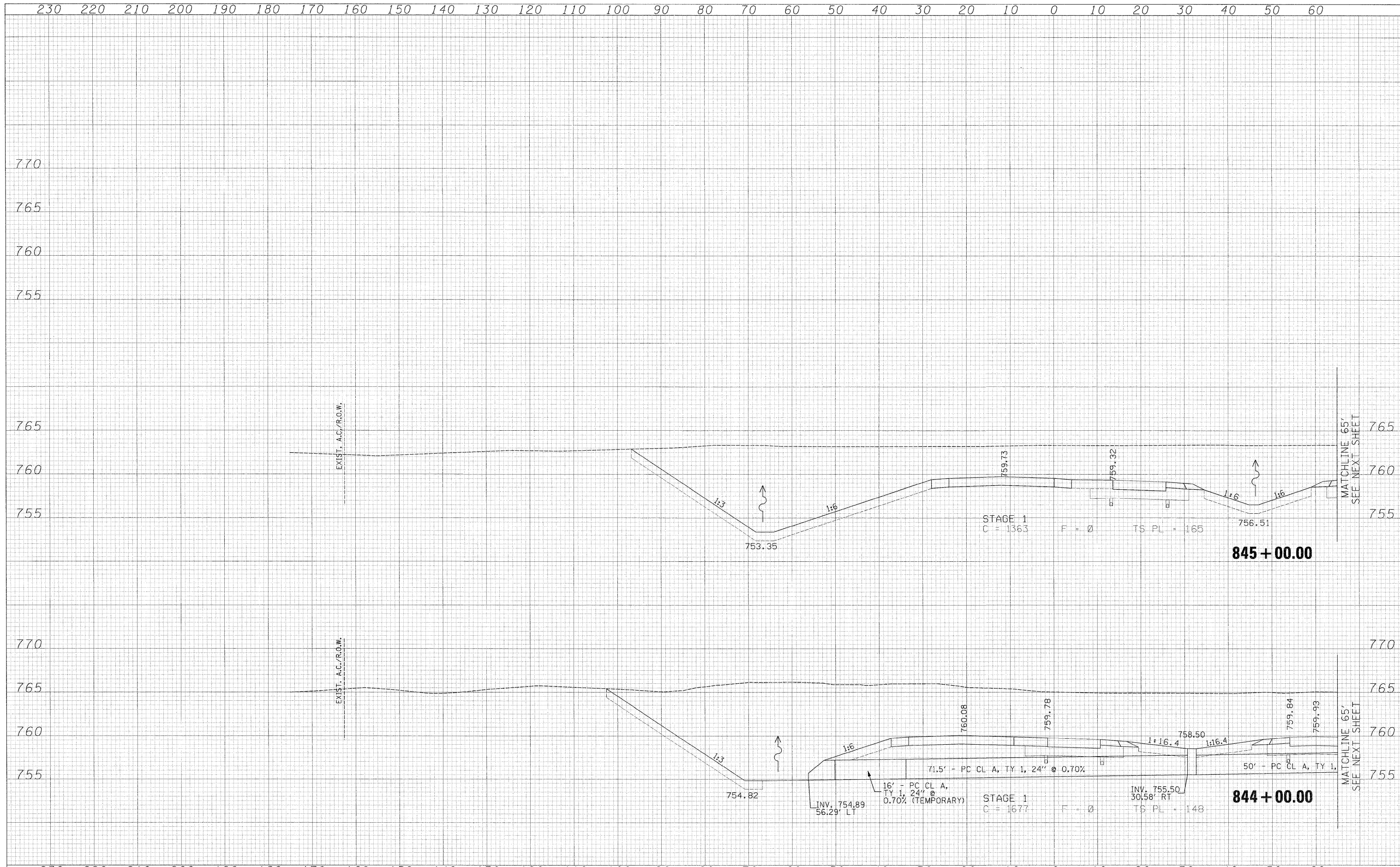

230	220	210	200	190	180	170	160	150	140	130	120	110	100	90	80	70	60	50	40	30	20	10	0	10	20	30	40	50	60																																			
<table border="1"> <tr><td>USER NAME = zlikowsd</td><td>DESIGNED RDT</td><td>REVISED -</td></tr> <tr><td>PLLOT SCALE = 10.0000' / IN.</td><td>DRAWN RDT</td><td>REVISED -</td></tr> <tr><td>PLLOT DATE = 2/2/2011</td><td>CHECKED GC</td><td>REVISED -</td></tr> <tr><td></td><td>DATE 01-14-11</td><td>REVISED -</td></tr> </table>														USER NAME = zlikowsd	DESIGNED RDT	REVISED -	PLLOT SCALE = 10.0000' / IN.	DRAWN RDT	REVISED -	PLLOT DATE = 2/2/2011	CHECKED GC	REVISED -		DATE 01-14-11	REVISED -	<b>STATE OF ILLINOIS</b> <b>DEPARTMENT OF TRANSPORTATION</b>										<b>ILLINOIS ROUTE 2 NORTH TRANSITION</b> <b>STAGE 1 CROSS SECTIONS</b>										<table border="1"> <tr><td>F.A.P. RTE.</td><td>SECTION</td><td>COUNTY</td><td>TOTAL SHEETS</td><td>SHEET NO.</td></tr> <tr><td>734</td><td>77-2-2 &amp; 77-2B-1</td><td>WINNEBAGO</td><td>530</td><td>138</td></tr> <tr><td colspan="3"></td><td colspan="2">CONTRACT NO. 64813</td></tr> </table>				F.A.P. RTE.	SECTION	COUNTY	TOTAL SHEETS	SHEET NO.	734	77-2-2 & 77-2B-1	WINNEBAGO	530	138				CONTRACT NO. 64813	
USER NAME = zlikowsd	DESIGNED RDT	REVISED -																																																														
PLLOT SCALE = 10.0000' / IN.	DRAWN RDT	REVISED -																																																														
PLLOT DATE = 2/2/2011	CHECKED GC	REVISED -																																																														
	DATE 01-14-11	REVISED -																																																														
F.A.P. RTE.	SECTION	COUNTY	TOTAL SHEETS	SHEET NO.																																																												
734	77-2-2 & 77-2B-1	WINNEBAGO	530	138																																																												
			CONTRACT NO. 64813																																																													
SCALE: 1" = 10'														SHEET NO. 138 OF 530 SHEETS										STA. 844+00.00 TO STA. 845+06.63				ILLINOIS FED. AID PROJECT																																				

\\projects\11254\segment 1\sheet\civil\Traffic Control\0264813-sht-xssht-IL2 North Transition Stage 1.dgn