

NOTES
 1. SEE SIGNING PLANS AND PAVEMENT MARKING PLANS FOR LOCATION OF PROPOSED SIGNS AND PAVEMENT MARKINGS

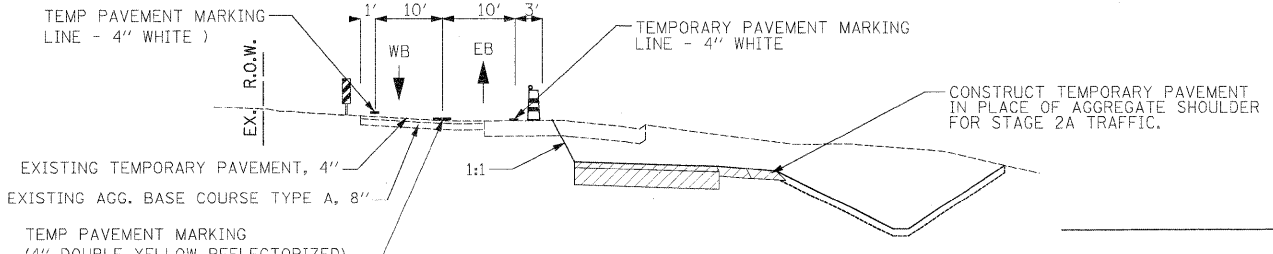
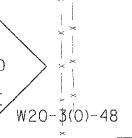
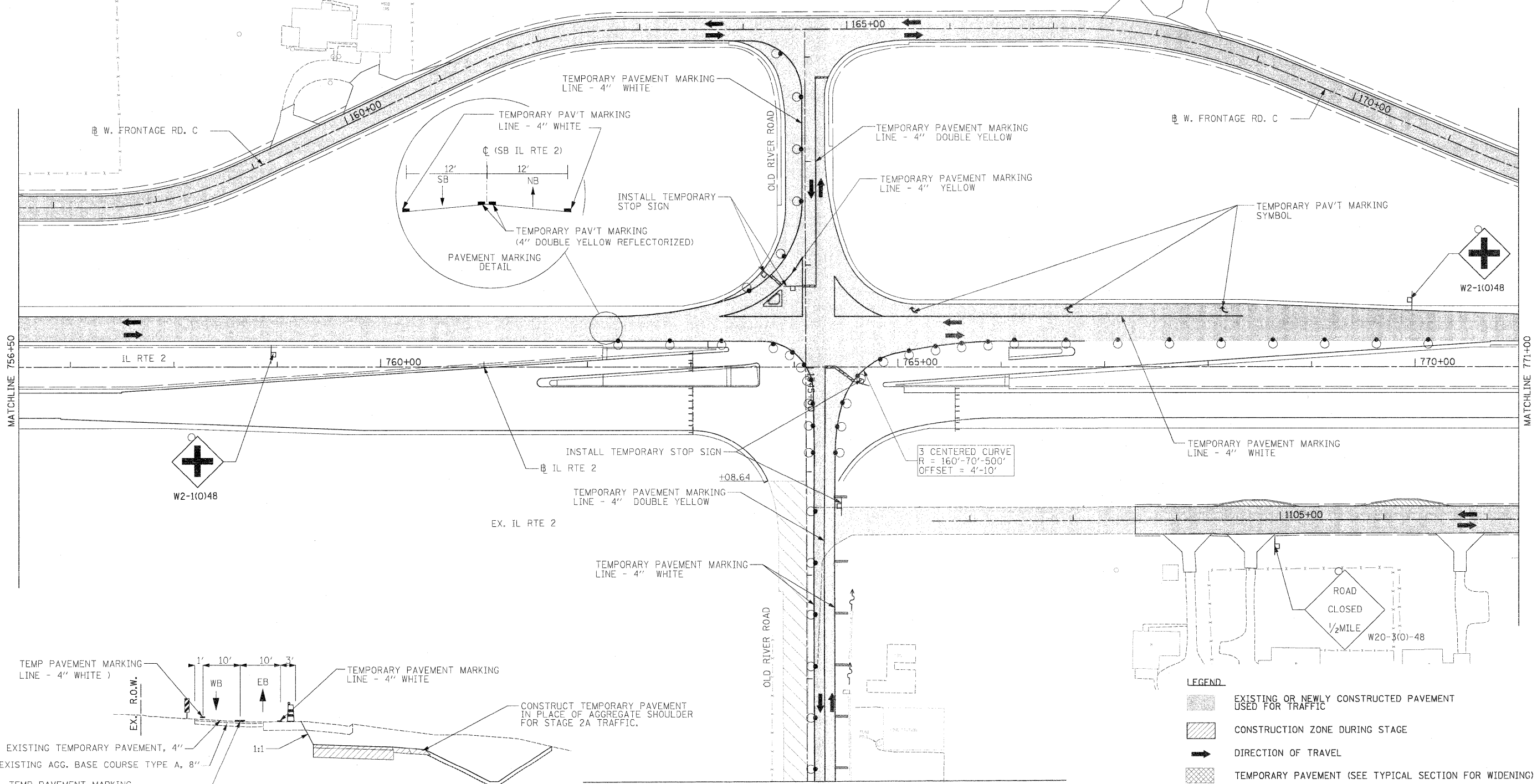
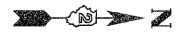

TYPICAL SECTION
 OLD RIVER ROAD (LOOKING EAST)
 STA. 1346+09 TO 1353+63

- LEGEND**
- EXISTING OR NEWLY CONSTRUCTED PAVEMENT USED FOR TRAFFIC
 - CONSTRUCTION ZONE DURING STAGE
 - DIRECTION OF TRAVEL
 - TEMPORARY PAVEMENT (SEE TYPICAL SECTION FOR WIDENING)
 - BARRICADE, TYPE III
 - DRUM WITH STEADY BURNING LIGHT
 - ARROW BOARD
 - VERTICAL PANEL

A:\projects\12284\12284.dwg (User: jthompson) Date: 01-14-11 10:58:28 AM

USER NAME = jthompson	DESIGNED STS/ROD	REVISED	STATE OF ILLINOIS DEPARTMENT OF TRANSPORTATION	ILLINOIS ROUTE 2 SUGGESTED STAGES OF CONSTRUCTION AND TRAFFIC CONTROL STAGE 2 - 6		F.A.P. RTE. 734	SECTION 77-2-2 & 77-2B-1	COUNTY WINNEBAGO	TOTAL SHEETS 530	SHEET NO. 152
PLOT SCALE = 5/8" = 1' - 0"	DRAWN RDT	REVISED		SCALE: 1" = 50'	SHEET NO. 152 OF 530 SHEETS	STA. 756+50 TO STA. 771+00	FED. ROAD DIST. NO. ILLINOIS FED. AID PROJECT		CONTRACT NO. 64813	
PLOT DATE = 4/4/2011	CHECKED GC	REVISED								
	DATE 01-14-11	REVISED								