

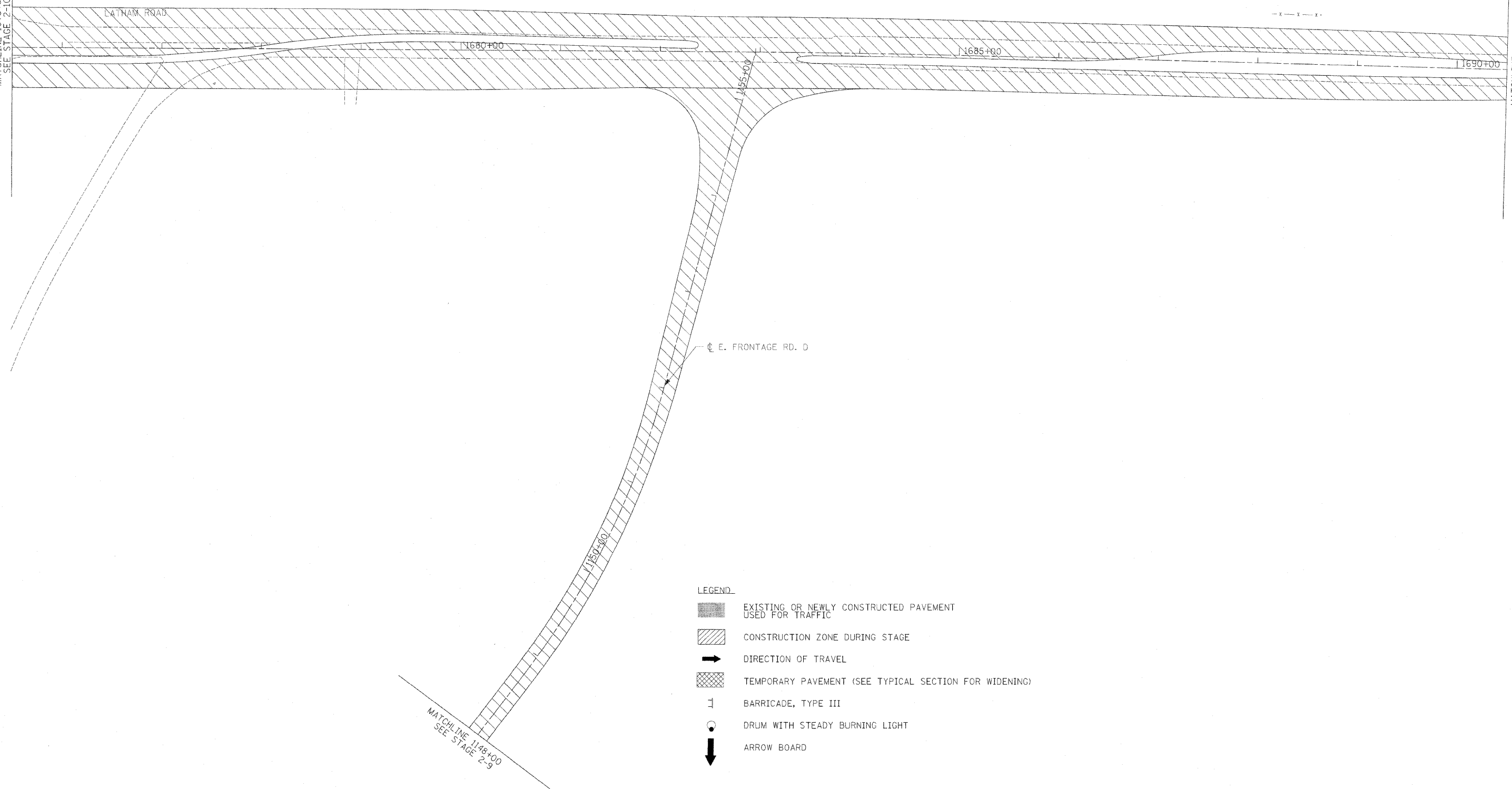

MATCHLINE 1675+50
SEE STAGE 2-10

MATCHLINE 1690+50
SEE STAGE 2-18



- LEGEND**
- EXISTING OR NEWLY CONSTRUCTED PAVEMENT USED FOR TRAFFIC
 - CONSTRUCTION ZONE DURING STAGE
 - DIRECTION OF TRAVEL
 - TEMPORARY PAVEMENT (SEE TYPICAL SECTION FOR WIDENING)
 - BARRICADE, TYPE III
 - DRUM WITH STEADY BURNING LIGHT
 - ARROW BOARD

I:\projects\11264\segment_1\shweta\civil\Traffic_Control\0264813_ah1+stage2-17.dgn

USER NAME = zu\kowsd	DESIGNED STS/RTD	REVISED -
PLCT SCALE = 50,000 FT / IN.	DRAWN RDT	REVISED -
PLOT DATE = 2/2/2011	CHECKED GC	REVISED -
	DATE 01-14-11	REVISED -

**STATE OF ILLINOIS
DEPARTMENT OF TRANSPORTATION**

**ILLINOIS ROUTE 2
SUGGESTED STAGES OF CONSTRUCTION
AND TRAFFIC CONTROL STAGE 2 - 17**

SCALE: 1"=50' SHEET NO. 163 OF 530 SHEETS STA. 1675+50 TO STA. 1690+50

F.A.P. RTE.	SECTION	COUNTY	TOTAL SHEETS	SHEET NO.
734	77-2-2 & 77-2B-1	WINNEBAGO	530	163
FED. ROAD DIST. NO. ILLINOIS FED. AID PROJECT			CONTRACT NO. 64813	