

NOTES  
 1. SEE SIGNING PLANS FOR LOCATION OF PROPOSED STOP SIGNS.

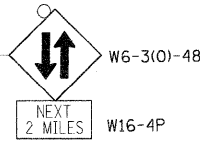

3 CENTERED CURVE  
 R = 120'-40'-200'  
 OFFSET = 2'-6.5'

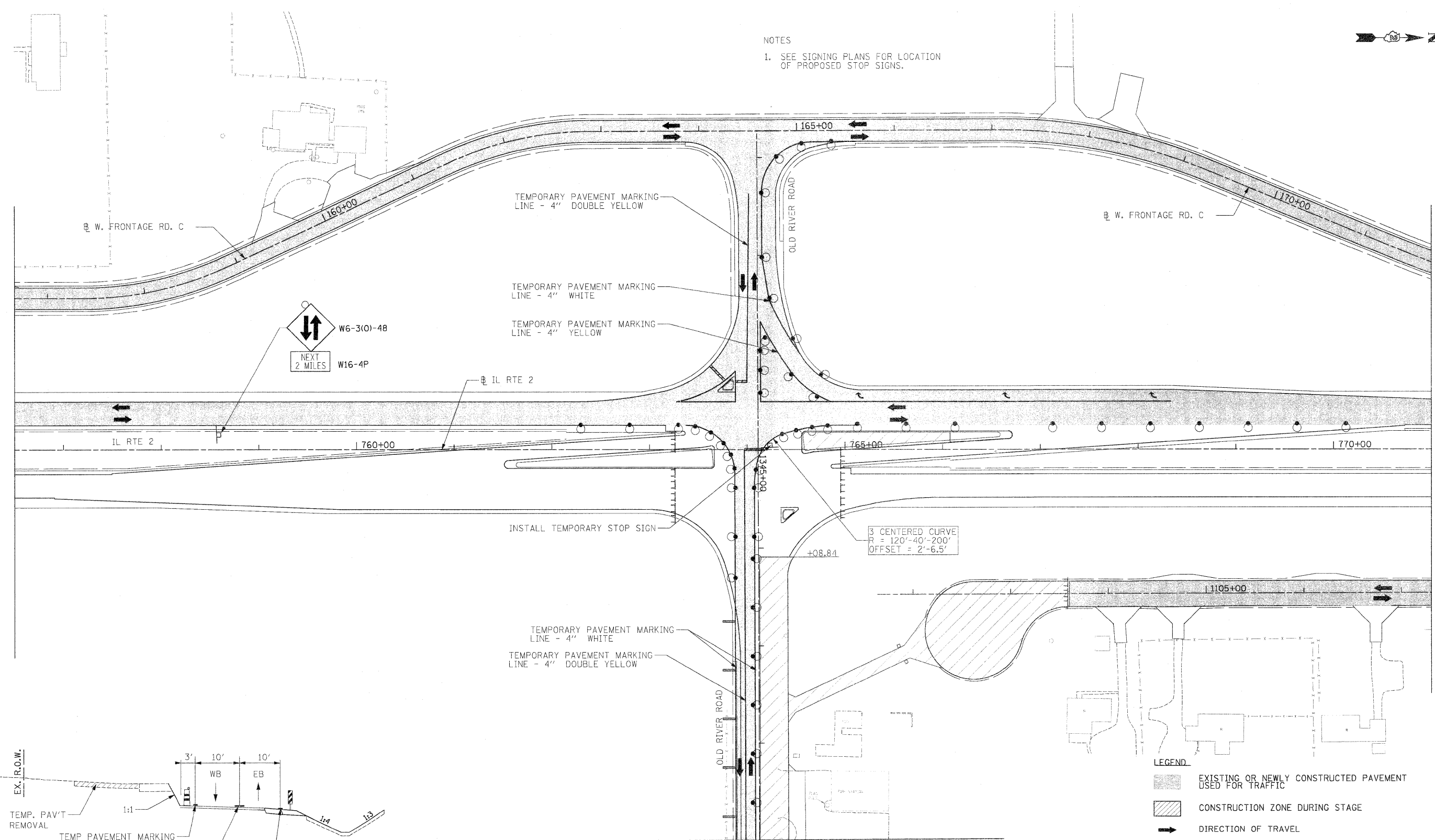
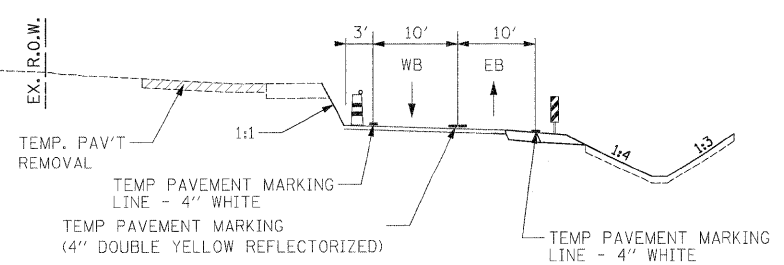

TYPICAL SECTION  
 OLD RIVER ROAD (LOOKING EAST)  
 STA. 1346+09.00 TO STA. 1353+63.00

- LEGEND
- EXISTING OR NEWLY CONSTRUCTED PAVEMENT USED FOR TRAFFIC
  - CONSTRUCTION ZONE DURING STAGE
  - DIRECTION OF TRAVEL
  - TEMPORARY PAVEMENT (SEE TYPICAL SECTION FOR WIDENING)
  - BARRICADE, TYPE III
  - DRUM WITH STEADY BURNING LIGHT
  - ARROW BOARD
  - VERTICAL PANEL

N:\projects\11254\management\11254\11254\Fig. Control\11254\11254\figs\stage2a-1.dwg

USER NAME - lthomson	DESIGNED STS/RDT	REVISED -
DRAWN RDT	REVISED -	
CHECKED GC	REVISED -	
DATE 01-14-11	REVISED -	

STATE OF ILLINOIS  
 DEPARTMENT OF TRANSPORTATION

ILLINOIS ROUTE 2  
 SUGGESTED STAGES OF CONSTRUCTION  
 AND TRAFFIC CONTROL STAGE 2A - 1

SCALE: 1"=50' SHEET NO. 166 OF 530 SHEETS STA. 756+50 TO STA. 771+00

F.A.P. RTE.	SECTION	COUNTY	TOTAL SHEETS	SHEET NO.
734	77-2-2 & 77-2B-1	WINNEBAGO	530	166
FED. ROAD DIST. NO.		ILLINOIS FED. AID PROJECT		

CONTRACT NO. 64813