

END CONSTRUCTION  
STA. 194+23.55

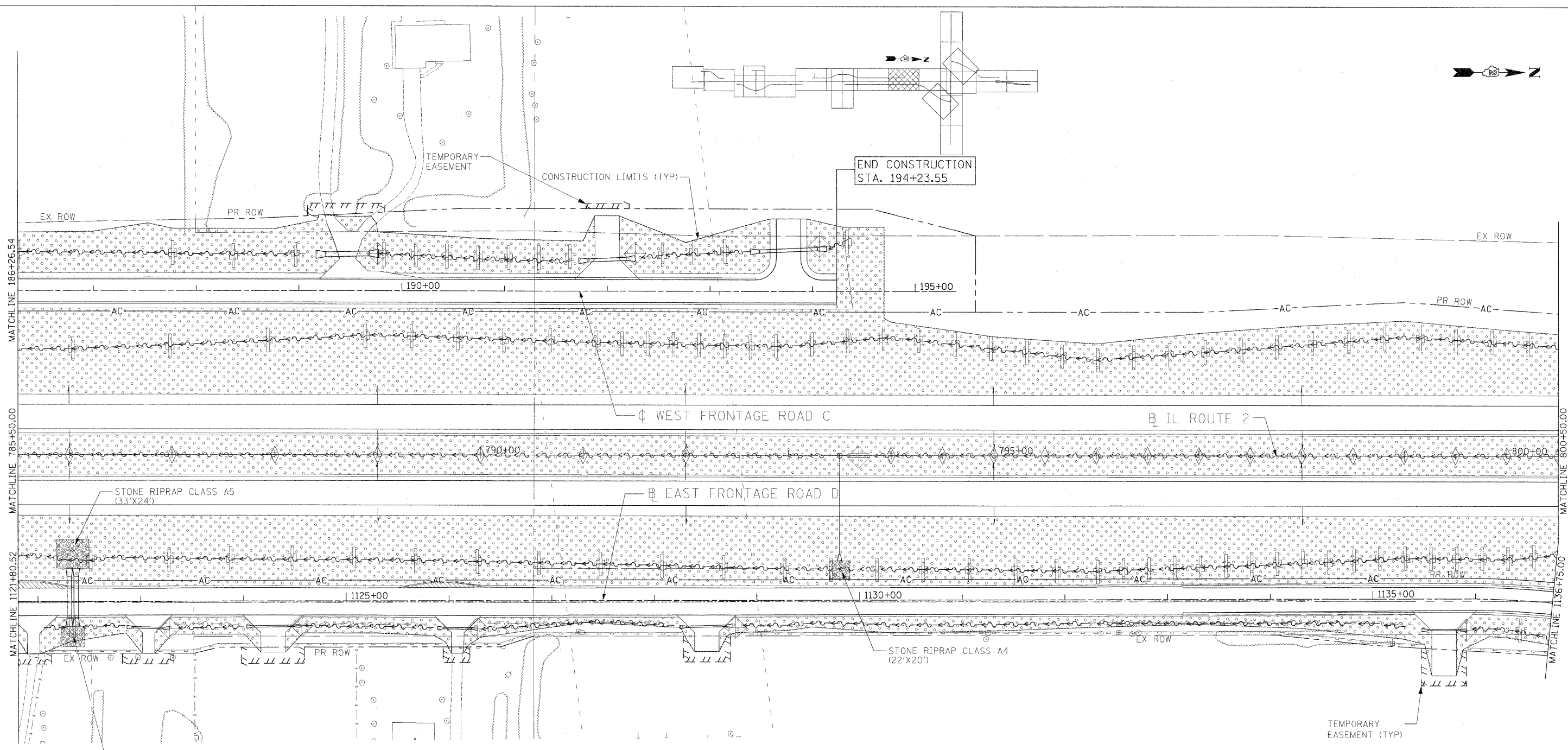

**EROSION CONTROL LEGEND**

- STONE RIPRAP (CLASS & DIMENSIONS SHOWN ON PLAN)
- SEEDING, CLASS 1 (AREAS BEING MOWED)  
SEEDING, CLASS 4 (BEHIND C&G & BACKSLOPES)  
SEEDING, CLASS 2A (FRONTSLOPES & DITCH BOT.)
- EXISTING TREE TO REMAIN
- TEMPORARY DITCH CHECK
- INLET & PIPE PROTECTION
- EARTH MEDIAN DITCH CHECK
- PERIMETER EROSION BARRIER
- AGGREGATE MEDIAN DITCH CHECK

STONE RIPRAP CLASS A4  
(23'X20')

USER NAME = zulkowd	DESIGNED STS/GC	REVISED -
	DRAWN RDT	REVISED -
PLOT SCALE = 50.0000 FT / IN.	CHECKED GC	REVISED -
PLOT DATE = 2/27/2011	DATE 01-14-11	REVISED -

**STATE OF ILLINOIS  
DEPARTMENT OF TRANSPORTATION**

ILLINOIS ROUTE 2 EROSION CONTROL PLAN B STA 785+50 TO 800+50	
SCALE: 1"=50'	SHEET NO. 176 OF 530 SHEETS
STA.	TO STA.

F.A.P. RTE. 734	SECTION 77-2-2 & 77-2B-1	COUNTY WINNEBAGO	TOTAL SHEETS 530	SHEET NO. 176
FED. ROAD DIST. NO. ILLINOIS FED. AID PROJECT			CONTRACT NO. 64813	

I:\projects\11254\erocntrl\11254\erocntrl\11254\erocntrl\11254\erocntrl.dwg